



Submittals WQWebSubmittal

[WQWebSubmittal Home](#)
[WQWebPortal Home](#)
[Help](#)
[FAQs](#)
[Logout](#)

Annual Report

Number	Permit Section	Question
1	S5.A.3	Attach updated annual Stormwater Management Program Plan (SWMP Plan). (S5.A.3) Saved Document Name: (1) 2017 Storwmater Program PI_1_03232018090134
2	S9.D.5	Attach a map and copy of any annexations, incorporations or boundary changes resulting in an increase or decrease in the Permittee's geographic area of permit coverage during the reporting period per S9.D.5. Saved Document Name: (2) 2017 Annexations_2_03232018085335 Comment: Two annexations have decreased Chelan County's geographic area of permit coverage.
3	S5.A.4.a.ii	Tracked the estimated costs of implementation of each component of the SWMP. (S5.A.4.a.ii) Yes
4	S5.A.5.b	Coordinated among departments within the jurisdiction to eliminate barriers to permit compliance. (S5.A.5.b) Yes
5	S5.B.1.a and b	Attach description of public education and outreach programs and stewardship activities conducted per S5.B.1.a and b. Saved Document Name: (5) 2017 Public Education and _5_03232018090738
6	S5.B.2.a	Describe the opportunities created for the public to participate in the decision making processes involving the development, implementation and updates of the Permittee's SWMP. (S5.B.2.a) Saved Document Name: (6) Opportunities for Particip_6_03232018091144
7	S5.B.2.b	Posted the updated SWMP Plan and latest annual report on your website no later than May 31. (S5.B.2.b) Yes
7b	S5.B.2.b	List the website address. http://www.co.chelan.wa.us/public-works/pages/storm-water
8	S5.B.3.a	Maintained a map of the MS4 that includes the requirements listed in S5.B.3.a. Yes
9	S5.B.3.b.vi	Implemented a compliance strategy, including informal compliance actions as well as enforcement provisions of the regulatory mechanism described in S5.B.3.b. (S5.B.3.b.vi) Yes
10	S5.B.3.b.vii	Updated, if necessary, the regulatory mechanism to effectively prohibit illicit discharges into the MS4 per S5.B.3.b.vii. (Required, if applicable, no later than February 2, 2019) Not Applicable

Number	Permit Section	Question
		Comment: Will be updated in 2018.
11	S5.B.3.c	Implemented procedures for conducting illicit discharge investigations in accordance with S5.B.3.c. Yes
12	S5.B.3.c.iii	Percentage of MS4 coverage area screened in reporting year per S5.C.3.c.i. (Required to screen 40% of MS4 no later than December 31, 2018 and 12% on average each year thereafter, S5.B.3.c.iii) 60
13	S5.B.3.c.iv	Publicized a hotline telephone number for public reporting of spills and other illicit discharges. (S5.B.3.c.iv) Yes
13b	S5.B.3.c.iv	List the hotline number. 509-667-6415
14	S5.B.3.c.v	Implemented an ongoing illicit discharge training program for all municipal field staff per S5.B.3.c.v. Yes Comment: Hosted ECOSS training for staff.
15	S5.B.3.c.vi	Informed public employees, businesses, and the general public of hazards associated with illicit discharges and improper disposal of waste. (S5.B.3.c.vi) Yes
15b	S5.B.3.c.vi	Describe actions. Chelan County and our partners (Douglas County, Cities of Wenatchee and East Wenatchee) provided training for staff, attended public events, provided direct mailings to businesses, and participated in school programs. In 2017, the illicit discharge education focused on dog waste management and tow truck operations.
16	S5.B.3.d	Number of illicit discharges, including illicit connections, eliminated during the reporting period. (S5.B.3.d) 0
17	S5.B.3.d.iv	Attach a summary of actions taken to characterize, trace and eliminate each illicit discharge found by or reported to the permittee. For each illicit discharge, include a description of actions according to required timelines per S5.B.3.d.iv. Not Applicable
18	S5.B.3.e	Implemented an ongoing illicit discharge training program for all staff responsible for implementing the procedures and program, as described in S5.B.3.e. Yes
19	S5.B.4.a	Implemented an ordinance or other regulatory mechanism and enforcement procedures for construction site stormwater runoff control as described in S5.B.4.a. Yes Comment: Chelan County Code chapter 13.16 and 13.18.
20	S5.B.4.b	

Number	Permit Section	Question
		Reviewed Stormwater Site Plans, including construction SWPPPs for all new development and redevelopment projects. S5.B.4.b. Yes
20b	S5.B.4.b	Number of site plans reviewed during the reporting period. 11
21	S5.B.4.c	Implemented procedures for site inspection and enforcement of construction stormwater pollution control measures. (S5.B.4.c) Yes
21b	S5.B.4.c.iii	Number of permitted construction sites inspected during the reporting period, (S5.B.4.c.iii) 11
22	S5.B.4.c	Number of enforcement actions taken during the reporting period based on construction phase inspections at new development and redevelopment projects. (S5.B.4.c) 0
23	S5.B.4.b.ii and S5.B	Trained the staff involved in permitting, plan review, field inspections and enforcement for construction site runoff control. (S5.B.4.b.ii and S5.B.4.c.ii) Yes
24	S5.B.4.d	Provided information to construction site operators and design professionals about training available on how to comply with the requirements in Appendix 1 and the BMPs in the SWMMEW, or an equivalent document. (S5.B.4.d) Yes
24b	S5.B.4.d	Cite website address, if located on your website. www.wenatcheewa.gov/wvstac
25	S5.B.4.e	The number of construction sites that provided their intent to apply for the "Erosivity Waiver" as described in (S5.B.4.e). 1
26	S5.B.4.e	The number of complaints investigated about sites that have received an "Erosivity Waiver" and describe any enforcement actions taken as a result. (S5.B.4.e) 0
27	S5.B.5.a.	Implemented ordinance or other regulatory mechanism and enforcement procedures as described in S5.B.5.a. Yes
28	S5.B.5.a.ii(a)	Allowed non-structural preventive actions and source reduction approaches such as Low Impact Development techniques to be used. (Required no later than December 31, 2017, S5.B.5.a.ii(a)) Yes
29	S5.B.5.a.ii(b)(2)	Required projects approved under S5.B.5 to retain runoff generate on-site for, at a minimum, the 10-year, 24-hour rainfall event or a local equivalent, using either on-site or regional stormwater facilities. (Required no later than December 31, 2017, S5.B.5.a.ii(b)(2)) Yes

Number	Permit Section	Question
31	S5.B.5.b	Implemented procedures for post-construction site plan review. (S5.B.5.b) Yes
32	S5.B.5.c.ii	Inspected post-construction stormwater controls, including structural BMPs, during installation at new development and redevelopment projects. (S5.B.5.c.ii) Yes
32b	S5.B.5.c.ii	Number of sites inspected during the reporting period. (S5.B.5.c.ii) 5
33	S5.B.5.c	Number of enforcement actions taken during the reporting period? (S5.B.5.c) 0
34	S5.B.5.c.iii	Inspected structural BMPs at least once every five years after final installation. (S5.B.5.c.iii) Yes
34b	S5.B.5.c.iii	Number of BMPs inspected during the reporting period. (S5.B.5.c.iii) 1
35	S5.B.5.d	Trained the staff involved in permitting, plan review, inspection and enforcement for post-construction stormwater control. (S5.B.5.d) Yes
36	S5.B.6.a	Reviewed and, if needed, updated Operations and Maintenance Plan. (Required no later than August 1, 2017, S5.B.6.a). Yes
37	S5.B.6.a	Implemented the schedule of Operation and Maintenance activities for municipal operations. (S5.B.6.a) Yes
38	S5.B.6.a.i (f) and (g)	Have NPDES permit coverage for all applicable Permittee construction projects and industrial facilities. (S5.B.6.a.i (f) and (g)) Yes
39	S5.B.6.a.ii (a)	Inspected stormwater treatment and flow control facilities (except catch basins) owned or operated by the Permittee at least once every two years. (S5.B.6.a.ii (a)) Yes
39b	S5.B.6.a.ii (a)	Number of facilities inspected during the reporting period. (S5.B.6.a.ii (a)) 2
41	S5.B.6.a.ii (b)	If used an alternative to standard schedule for catch basin inspections for all or a portion of the MS4, attach description of the method used. (S5.B.6.a.ii(b)) Not Applicable
42	S5.B.6.a.ii (c)	Conducted spot checks of stormwater facilities after major storms. (S5.B.6.a.ii (c)) Yes
43	S5.B.6.b	

Number	Permit Section	Question
		Trained the staff with primary construction, operations, or maintenance job functions that are likely to impact stormwater quality. (S5.B.6.b) Yes
44	S7.A	Complied with the Total Maximum Daily Load (TMDL)-specific requirements identified in Appendix 2. (S7.A) Not Applicable
45	S7.A	For TMDLs listed in Appendix 2: Attach a summary of relevant SWMP and Appendix 2 activities to address the applicable TMDL parameter(s). (S7.A) Not Applicable
46	S8.A	Attach a description of any stormwater monitoring or stormwater-related studies as described in S8.A. Not Applicable
47	S8.B	Participated in the regional group to select, develop and conduct effectiveness studies as described in S8.B. Yes
48	G3	Notified Ecology in accordance with G3 of any discharge into or from the Permittees MS4 which could constitute a threat to human health, welfare or the environment. (G3) Not Applicable Comment: Chelan County did not have a discharge that would constitute a threat to human health, welfare or the environment in 2017.
49	G3.A	Took appropriate action to correct or minimize the threat to human health, welfare, and/or the environment per G3.A. Not Applicable
50	G20	Notified Ecology of the failure to comply with the permit terms and conditions within 30 days of becoming aware of the non-compliance. (G20) Not Applicable
52	S4.F.3.d	Attach a summary of the status of implementation of any actions taken pursuant to S4.F.3 and the status of any monitoring, assessment, or evaluation efforts conducted during the reporting period. (S4.F.3.d) Not Applicable

Attachments:**View Files Attached to Submission**

	DocDescr	DocName	DocExt	DocID	SubID	AppName
View	WAR046002_1_03232018090134	(1) 2017 Stormwater Program PL_1_03232018090134	.pdf	669653	1615466	wqwebportal
View	WAR046002_2_03232018085335	(2) 2017 Annexations_2_03232018085335	.pdf	669652	1615466	wqwebportal
View	WAR046002_5_03232018090738	(5) 2017 Public Education and _5_03232018090738	.pdf	669654	1615466	wqwebportal
View	WAR046002_6_03232018091144	(6) Opportunities for Particip_6_03232018091144	.pdf	669656	1615466	wqwebportal
View	WAR046002_03282018091128	2017 NPDES Boundary_03282018091128.pdf	.pdf	670249	1615466	wqwebportal
View	Submitted Copy of Record for Chelan County Public Works	Copy of Record ChelanCountyPublicWorks Wednesday March 28 2018	.pdf	670261	1615466	wqwebportal
View	Submitted Cover Letter for Chelan County Public Works	Cover Letter ChelanCountyPublicWorks Wednesday March 28 2018	.pdf	670262	1615466	wqwebportal

Close

[Ecology Home](#) | [WQWebPortal Home](#) | [WQWebSubmittal Home](#) | [Help](#) | [Release Notes](#) | [Contact Us](#)

[Submittals \(WQWebSubmittal\) Version 1.5-3](#) | [Data Disclaimer](#) | [Privacy Policy](#)

Copyright © Washington State Department of Ecology 2018. All Rights Reserved.

Appendix A

2018 Stormwater Management Plan

2018 Wenatchee Valley Stormwater Management Program Plan

The following stormwater activities are regional activities unless otherwise noted. The regional partners include Chelan County, Douglas County, City of East Wenatchee, City of Wenatchee and Wenatchee Valley College.

- I. Stormwater Management Program**
 - a. Update Wenatchee Valley Stormwater Management Program Plan.
 - b. Schedule quarterly regional stormwater utility meetings.
 - c. Prepare an annual report.
- II. Public Education and Outreach**
 - a. Provide car washing education and outreach to commercial businesses.
 - b. Provide stormwater education and outreach at one public event.
 - c. Participate in Wenatchee School District programs. (City of Wenatchee)
- III. Public Involvement and Participation**
 - a. Host annual Wenatchee Valley Stormwater Program Steering Committee meeting.
 - b. Post Stormwater Management Program and Plan to regional website.
 - c. Provide a stormwater survey on the website and at public events.
- IV. Illicit Discharge Detection and Elimination**
 - a. Provide training to field staff on illicit discharge detection and elimination.
 - b. Complete field assessment of at least 40% of the MS4 no later than December 31, 2018.
- V. Construction Site Stormwater Runoff Control**
 - a. Participate in the update of the Stormwater Management Manual for Eastern Washington.
 - b. Host a certified erosion and sediment control lead training.
- VI. Post-Construction Stormwater Management for new Development and Redevelopment**
 - a. Continue implementation of 5-year operation and maintenance inspections of post-construction stormwater facilities.
 - b. Submit a summary of the criteria for defining infeasibility with the annual report no later than March 31, 2018 (City of Wenatchee).
- VII. Municipal Operations and Maintenance**
 - a. Develop a spill response plan (Wenatchee Valley College).
 - b. Inspect all catch basins and inlets at least once by December 31, 2018.
- VIII. Monitoring and Assessment**
 - a. Participate in Effectiveness Study effort.

In addition, city and county staff will be participating in the Ecology process to develop and issue a new Eastern Washington Phase II Municipal Stormwater permit. The new permit is expected to take effect August 1, 2019.

Return Address:
Tammy Slanger, City Clerk
City of Wenatchee
PO Box 519
Wenatchee, WA 98807-0519

Document Title(s) (or transactions contained therein):

1. Ordinance No. 2017-04
- 2.
- 3.
- 4.

Reference Number(s) of Documents assigned or released:
(on page of document(s))

Grantor(s) (last name first, then first name and initial(s))

1. City of Wenatchee
- 2.
- 3.
- 4.

☐ Additional names on page of document.

Grantee(s) (last name first, then first name and initial(s))

1. Public
- 2.
- 3.
- 4.

☐ Additional names on page of document.

Legal Description (abbreviated : i.e. lot, block, plat or section township and range)

A parcel of land located within: the Southwest quarter of Section 21 of Township 23 North, Range 20 East of Willamette Meridian, Chelan County, Washington.

☒ Additional legal is on page 5, 6, 7 of document

Assessor's Property Tax Parcel/Account Number: 232021860042; 232021860025;

☐ Additional parcel numbers on page of document 232021860020

Washington State County Auditor/Recorder's Indexing form (cover sheet)

The Auditor/Recorder will rely on the information provided on the form. The staff will not read the document to verify the accuracy or completeness of the indexing information provided herein.

EMERGENCY NONSTANDARD REQUEST - SIGN ONLY WHEN RECORDING AS NONSTANDARD

I am requesting an emergency nonstandard recording for an additional fee of \$50.00 as provided in RCW 36.18.010. I understand that the recording processing requirements may cover up or otherwise obscure some part of the text of the original document.

SIGNATURE

DATE

ORDINANCE NO. 2017-04

AN ORDINANCE, providing for the annexation of property in the vicinity of Melody Lane and Alvista Place, subject to the provisions of Ordinance No. 2007-34 and all subsequent amendments thereto.

WHEREAS, a petition to annex the real property hereinafter described was filed with the City Council of the City of Wenatchee, signed by owners representing 60% of the assessed valuation in the area for which annexation is petitioned, and

WHEREAS, the applicable zoning for the annexed property will be Residential Moderate (RM) as designated on the pre-annexation zoning map, and

WHEREAS, the City Council of the City of Wenatchee considered all factors relative to the proposed annexation, and

WHEREAS, a review proceeding for said annexation is not required pursuant to RCW 35A.14.220.

NOW, THEREFORE, THE CITY COUNCIL OF THE CITY OF WENATCHEE DO ORDAIN as follows:

SECTION I

That the following described real property located in Chelan County, Washington, contiguous to the City of Wenatchee, to-wit:

See Exhibit "A" attached hereto and incorporated herein by reference as if fully set forth;

and each and every part thereof be and the same is hereby annexed to the City of Wenatchee, State of Washington; and that the corporate limits of the City of Wenatchee be and they are hereby

extended so as to include the property and territory hereinbefore fully described. That said property be assessed and taxed at the same rate and on the same basis as the property of the City of Wenatchee is assessed and taxed to pay for the now outstanding indebtedness of the City of Wenatchee contracted prior to or existing at the time of this annexation.

SECTION II

That the property described in Section I hereof be and the same is hereby classified and zoned as Residential Moderate (RM). All such zoning and classification being subject to the provisions of Ordinance No. 2007-34, and all subsequent amendments thereto.

SECTION III

This Ordinance shall take effect from and after its passage on the later of sixty (60) days after publication of such Ordinance once in The Wenatchee World, the same being the official newspaper of the City of Wenatchee, and the Clerk is hereby directed to cause the same to be so publicized, or sixty (60) days from the date notice of the annexation is provided to the Chelan County Treasurer, Assessor, and light, power and gas distribution businesses.

yes

PASSED BY THE CITY COUNCIL OF THE CITY OF WENATCHEE, at a regular meeting thereof, this 9th day of February, 2017.

CITY OF WENATCHEE, a Municipal
Corporation

By:

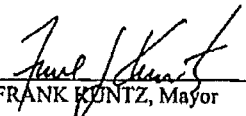
FRANK KUNTZ, Mayor

ATTEST:

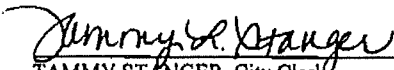
By: 
TAMMY STANGER, City Clerk

APPROVED:

By: 
STEVE D. SMITH, City Attorney

EXHIBIT A

City of Wenatchee, Washington

GRACE CITY CHURCH ANNEXATION BOUNDARY DESCRIPTION

December 12, 2016

A parcel of land located within: the Southwest Quarter of Section 21 of Township 23 North, Range 20 East of the Willamette Meridian, Chelan County, Washington, more particularly described as follows:

That portion of Tract 7, Sunnyslope Farms, according to the plat thereof recorded in Volume 1 of Plats, pages 57 and 58, records of Chelan County, Washington, described as: BEGINNING at the Northwest corner of said Tract 7;

thence South $1^{\circ}04'50''$ West along the West line thereof a distance of 115 feet, being the Southwest corner of property conveyed to Gary Blair Cooper and Kari Ann Cooper, husband and wife, by deed recorded under Auditor's File No. 2031559;

thence North $87^{\circ}19'10''$ East parallel with the North line of said Tract 7 a distance of 100.16 feet to a point which is South $87^{\circ}19'10''$ West a distance of 230.17 feet from the East line thereof, being the Northeast corner of property conveyed to Lloyd L. Fischer, et ux, by deed recorded under Auditor's File No. 9502090008

thence South $0^{\circ}59'20''$ West along the East line of said property a distance 30 feet to the TRUE POINT OF BEGINNING;

thence continuing South $0^{\circ}59'20''$ West along the East line of said property a distance of 286.16 feet, more or less, to the Northerly right-of-way line of P.S.H. No. 2 as conveyed to State of Washington by deed recorded under Auditor's File no. 446628;

thence Southwesterly perpendicular to and crossing ML (Melody Lane) Line Survey as defined by SR 2 Mile Post 117.61 to 119.30, Sunnyslope Interchange Vicinity, Chelan County, Right of Way and Limited Access Plan, Station L1 668+00 to L 698+00, sheet 4 of 6, Approved March 24, 1989, on file in the Office of the Washington State Department of Transportation, Olympia, Washington, at Highway Engineer's Station (hereinafter referred to as HES) ML 17+86.27 thereon a distance of 90 feet to the Southwesterly right-of-way of said ML Line;

thence Southeasterly parallel with said ML Line to a point opposite HES ML 20+99.39 P.T. thereon and 40 feet southwesterly therefrom, said line being both the Southwesterly right-of-way line of said ML Line and limited access control line of L1 Line, as defined by said plan;

thence Northeasterly along said Southwesterly right-of-way and limited access control line to a point opposite HES ML 20+99.39 P.T. thereon and 30 feet Southwesterly therefrom, as defined by said plan;

thence Southeasterly along said Southwesterly right-of-way and limited access control line to a point opposite HES ML 21+02.36 P.C. thereon and 30 feet Southwesterly therefrom, as defined by said plan;

Grace City Church Annexation Boundary Description

(continued)

thence Southeasterly and Easterly along said Southwesterly and Southerly right of way and limited access control line to a point opposite HES ML 22+74.60 P.T. thereon and 30 feet Southerly therefrom, as defined by said plan;

thence Southerly along said Southerly right-of-way and limited access control line to a point opposite HES ML 22+74.60 P.T. thereon and 40 feet Southerly therefrom, as defined by said plan;

thence Easterly, Northeasterly, and Northerly along the Southerly, Southeasterly, and Easterly right-of-way and limited access control line of said ML Line to a point opposite HES ML 36+55.93 thereon and 40 feet Easterly therefrom, as defined by said plan;

thence Westerly, leaving limited access control, crossing ML Line to a point opposite HES ML 36+55.93 thereon and 30 feet Westerly therefrom, to the Westerly right-of-way line of said ML Line, as defined by said plan, said line being also hereinafter described Line No. 2: (as conveyed by State of Washington in Deed recorded under auditor's no. 9110010011);

thence Southerly, Southwesterly, and Westerly along said Line No. 2 to the beginning point of said line, being the Westerly, Northwesterly, and Northerly right-of-way line of ML Line, as defined by said Deed;

thence North 55°45'49" West a distance of 40.32 feet to a point 30 feet Easterly, when measured at right angles and / or radially, from the AV Line Survey, as described by aforementioned plan, being the Northeasterly right-of-way line of ML Line, as described by said plan;

thence Northerly parallel with AV Line to a point opposite HES AV 11+20.04 thereon and 30 feet therefrom, being the Easterly right-of-way line of AV Line, as described by said plan;

thence Westerly, crossing AV Line, to a point opposite HES AV 11+20.04 thereon and 30 feet therefrom, being the Northerly right-of-way line of ML Line, as described by said plan;

thence South 0°14'01" West, parallel with AV Line, a distance of 55.04 feet to a point 30 feet Westerly, when measured at right angles and / or radially, from the AV Line Survey, being the Westerly right-of-way line of said AV Line, as described by said plan;

thence South 53°12'46" West a distance of 45.69 feet to a point 40 feet Northerly, when measured at right angles and / or radially, from the ML Line Survey, being the Northwesterly right-of-way line of ML Line, as described by said plan;

thence Westerly parallel with ML Line and 40 feet Northerly, when measured at right angles and / or radially, therefrom, to a point on the East line of Lot 5, Sunnyslope Farms, according to the plat thereof recorded in Volume 1 of Plats, pages 57 and 59, records of Chelan County, Washington, being the Northerly right-of-way line of ML Line, as described by said plan;

Grace City Church Annexation Boundary Description

(continued)

thence Northerly, leaving the Northerly right-of-way line of ML Line, along the East line of said Lot 5 to the Northeast corner of said Lot 5, as described by said plat;

thence Westerly along the North line of said lot 5 to the Northeast corner of Lot 6, as described by said plat;

thence Westerly along the North line of said Lot 6 to the Northeast corner of Lot 7, as described by said plat;

thence South $0^{\circ}59'20''$ West a distance of 145.0 feet to a point which is the Southeast corner of property conveyed to Stanley Schneller, Trustee, by deed recorded under Auditor's File No. 9401060011;

thence South $87^{\circ}19'10''$ West along the South line of said Schneller South line a distance of 230.17 feet, more or less, to the East line of property conveyed to Loyd L. Fischer, et us, by deed recorded under Auditor's File No. 9502090008, and the TRUE POINT OF BEGINNING.

Prepared By: Joshua Velazquez
Date: December 12, 2016

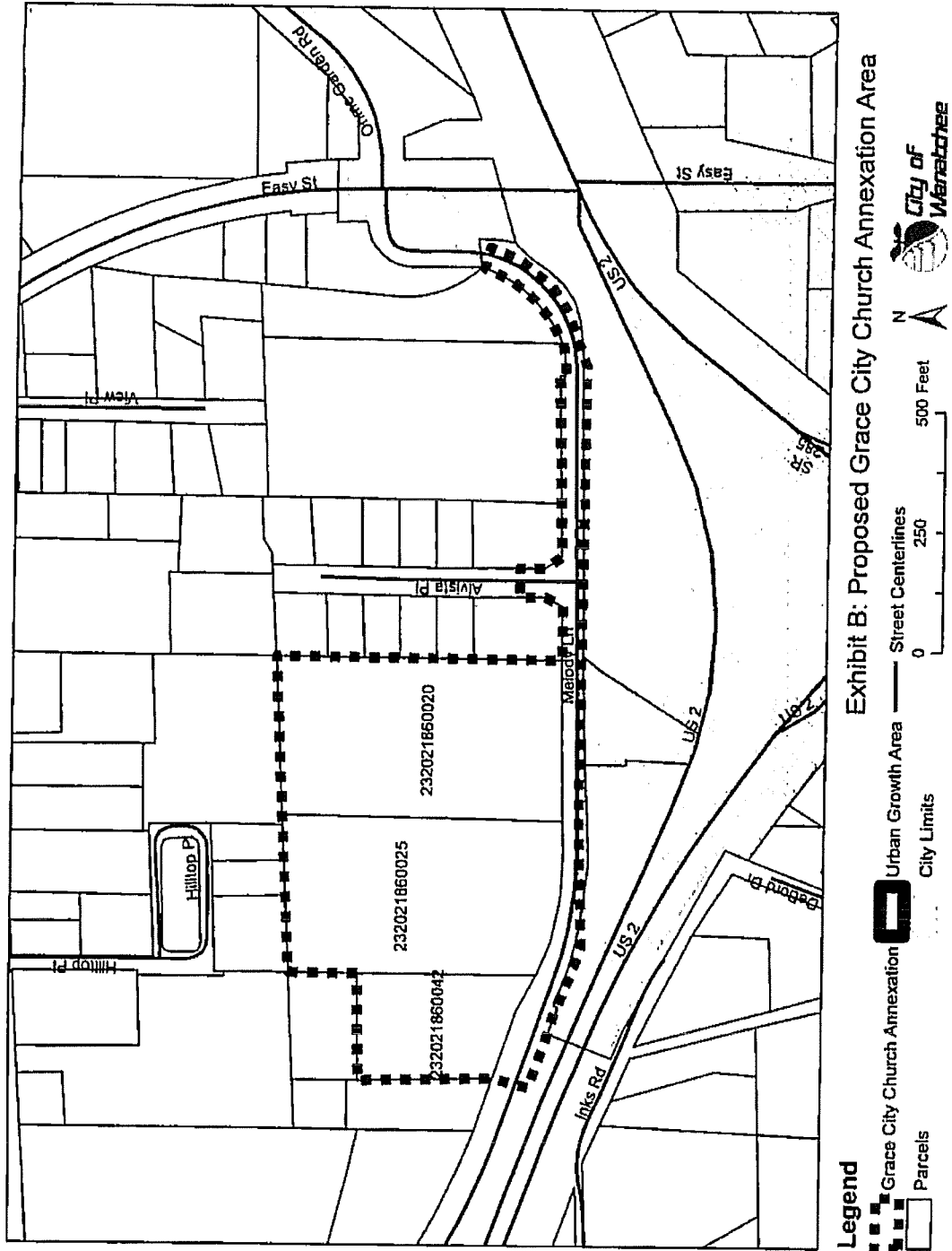

2018
EFFECT 6/21/17

Return Address:

Tammy Stanger, City Clerk
City of Wenatchee
PO Box 519
Wenatchee, WA 98807-0519

Document Title(s) (or transactions contained therein):

1. Ordinance No. 2017-14
- 2.
- 3.
- 4.

Reference Number(s) of Documents assigned or released:
(on page of document(s))

Grantor(s) (last name first, then first name and initial(s))

1. City of Wenatchee
- 2.
- 3.
- 4.

☐ Additional names on page of document.

Grantee(s) (last name first, then first name and initial(s))

1. Public
- 2.
- 3.
- 4.

☐ Additional names on page of document.

Legal Description (abbreviated : i.e. lot, block, plat or section township and range)

A portion of the East half of the Northeast quarter of the Northwest quarter of the Southwest quarter of Section 33, Township 23 North, Range 20 EWM.

☒ Additional legal is on page 5 of document

Assessor's Property Tax Parcel/Account Number: 232033320550

☒ Additional parcel numbers on page 8 of document

Washington State County Auditor/Recorder's Indexing form (cover sheet)

The Auditor/Recorder will rely on the information provided on the form. The staff will not read the document to verify the accuracy or completeness of the indexing information provided herein.

EMERGENCY NONSTANDARD REQUEST – SIGN ONLY WHEN RECORDING AS NONSTANDARD

I am requesting an emergency nonstandard recording for an additional fee of \$50.00 as provided in RCW 36.18.010. I understand that the recording processing requirements may cover up or otherwise obscure some part of the text of the original document.

SIGNATURE

DATE

ORDINANCE NO. 2017-14

AN ORDINANCE, providing for the annexation of an unincorporated area north of Maple Street and west of Pershing Street, also known as the Morley Annexation Area, subject to the provisions of Ordinance No. 2007-34 and all subsequent amendments thereto.

WHEREAS, a petition to annex the real property hereinafter described was filed with the City Council of the City of Wenatchee, signed by owners representing 60% of the assessed valuation in the area for which annexation is petitioned, and

WHEREAS, the applicable zoning for the annexed property will be Residential Moderate (RM) as designated on the pre-annexation zoning map, and

WHEREAS, the City Council of the City of Wenatchee considered all factors relative to the proposed annexation, and

WHEREAS, a review proceeding for said annexation is not required pursuant to RCW 35A.14.220.

NOW, THEREFORE, THE CITY COUNCIL OF THE CITY OF WENATCHEE DO ORDAIN as follows:

SECTION I

That the following described real property located in Chelan County, Washington, contiguous to the City of Wenatchee, to-wit:

See Exhibit "A" attached hereto and incorporated herein by reference as if fully set forth;

and each and every part thereof be and the same is hereby annexed to the City of Wenatchee, State of Washington; and that the corporate limits of the City of Wenatchee be and they are hereby extended so as to include the property and territory hereinbefore fully described. That said property be assessed and taxed at the same rate and on the same basis as the property of the City of Wenatchee is assessed and taxed to pay for the now outstanding indebtedness of the City of Wenatchee contracted prior to or existing at the time of this annexation.

SECTION II

That the property described in Section I hereof be and the same is hereby classified and zoned as Residential Moderate (RM). All such zoning and classification being subject to the provisions of Ordinance No. 2007-34, and all subsequent amendments thereto.

SECTION III

This Ordinance shall take effect from and after its passage on the later of sixty (60) days after publication of such Ordinance once in The Wenatchee World, the same being the official newspaper of the City of Wenatchee, and the Clerk is hereby directed to cause the same to be so publicized, or sixty (60) days from the date notice of the annexation is provided to the Chelan County Treasurer, Assessor, and light, power and gas distribution businesses.

PASSED BY THE CITY COUNCIL OF THE CITY OF WENATCHEE, at a regular meeting thereof, this 15th day of June, 2017.

CITY OF WENATCHEE, a Municipal
Corporation

By: _____

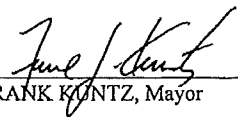
FRANK KUNTZ, Mayor

ATTEST:

By: Sammy R. Stanger
SAMMY STANGER, City Clerk

APPROVED:

By: Steve D. Smith
STEVE D. SMITH, City Attorney

Exhibit A

City of Wenatchee, Washington

Boundary Description of the Morley Annexation

May 8, 2017

A portion of the East half of the Northeast quarter of the Northwest quarter of the Southwest quarter of Section 33, Township 23 North, range 20, East of the Willamette Meridian, Chelan County, Washington, more particularly described as follows:





Commencing at the Southwest corner of said subdivision; thence North 0 degrees, 22 minutes East along the West line of said subdivision for 173.3 feet to the True Point of Beginning; thence continuing North 0 degrees, 22 minutes East for 154.7 feet; thence South 89 degrees, 04 minutes, 15 seconds East for 81 feet; thence South 0 degrees, 22 minutes West for 154.7 feet; thence North 89 degrees, 04 minutes, 15 seconds West for 81 feet to the Point of Beginning.

Excluding any areas already incorporated into the City of Wenatchee.

Exhibit B Morley Annexation



Legend

- | | |
|---|---|
|  Morley Annexation |  Urban Growth Area |
|  City Limits |  Parcels |

0 50 100 200 Feet



 City of
Winnetka

Chelan County Public Works

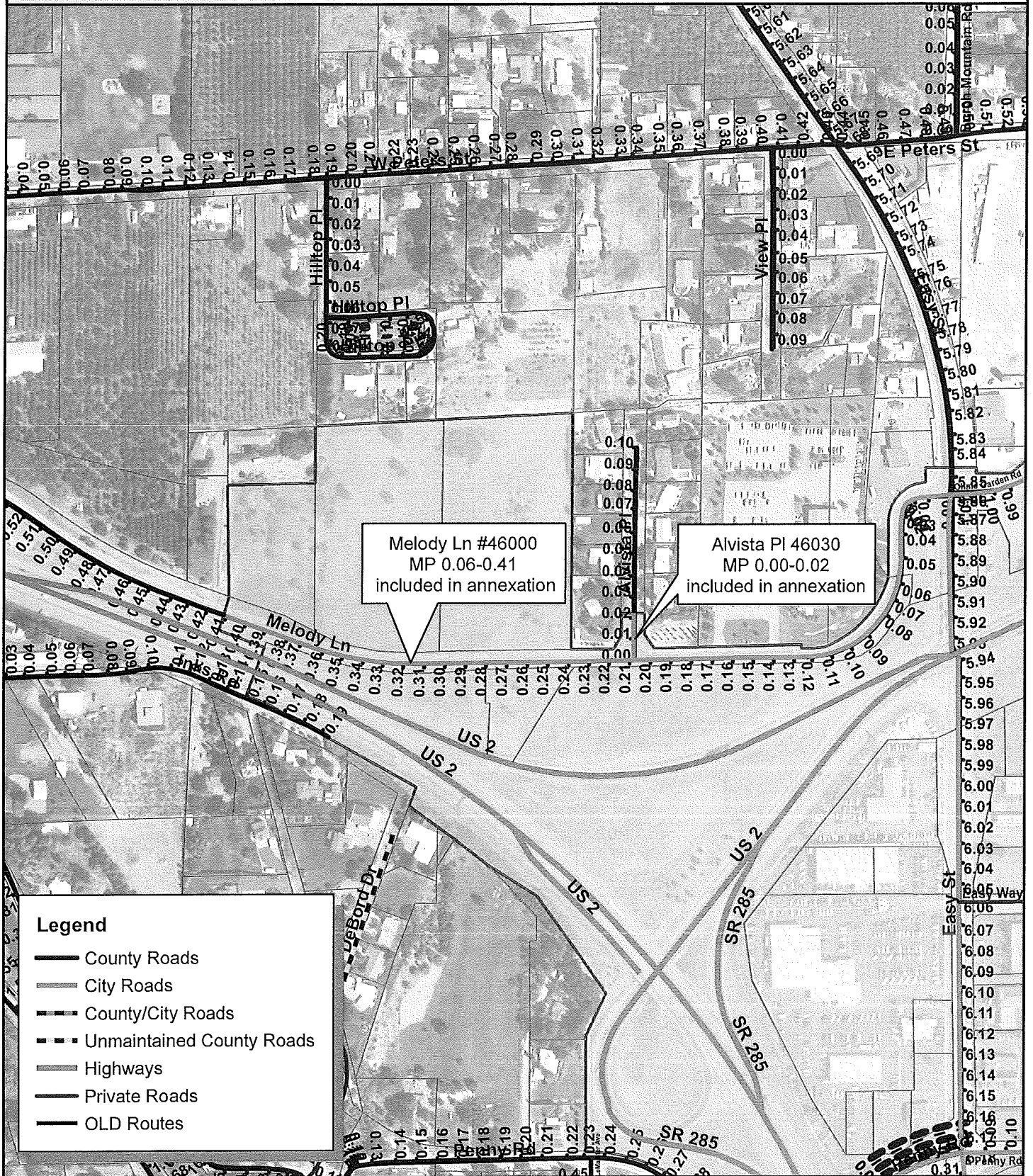

Legend

- County Roads
- City Roads
- County/City Roads
- Unmaintained County Roads
- Highways
- Private Roads
- OLD Routes

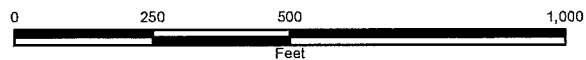
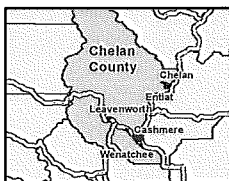
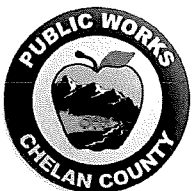

This map is a graphic representation derived from Chelan County's Geographic Information System. It is designed and intended for reference only. Chelan County does not warrant, guarantee, or accept liability for the accuracy, timeliness, or completeness of any information provided therein. Users shall be responsible to independently verify all information contained in this map.



Print Date: 4/14/2017

Exhibit B

Map of Proposed Shieni Annexation

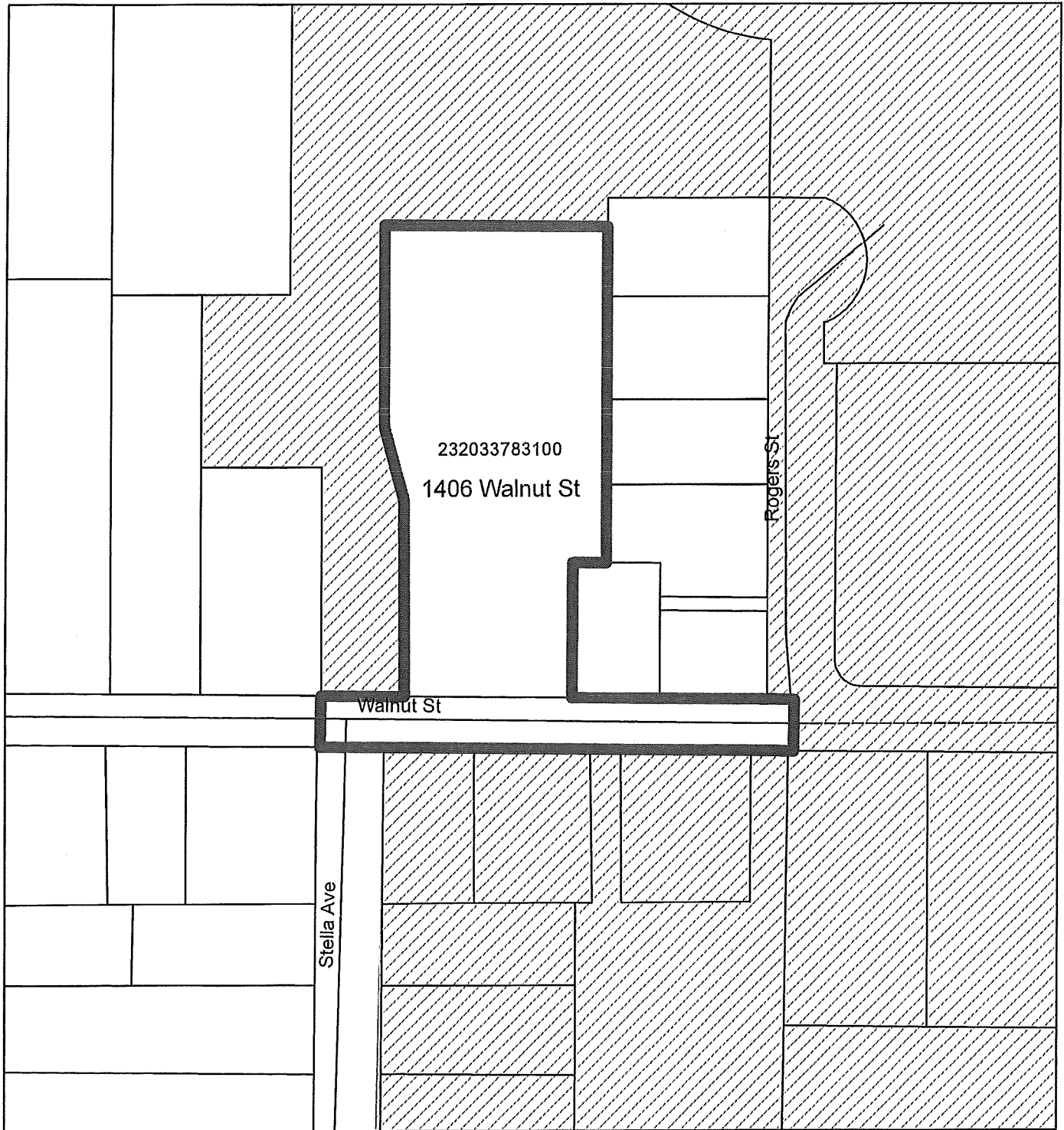

Legend

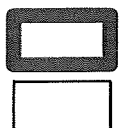

Shieni Annexation

Parcels

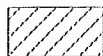

City Limits

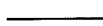

Streets



0 50 100 Feet

2017 Public Education, Outreach Programs and Stewardship Activities Chelan County

The Wenatchee Valley Stormwater Management Program was promoted by jurisdiction staff at the following community events and activities in 2017:

- KPQ Home & Garden Show
- Charity Car Wash Kit Program
- Wenatchee School District's 21st Century Community Learning Center Program (3rd through 5th grade)
- Kids in the Creek (9th through 12th grade) – 10 schools and 254 students
- New Dog Owner Kits (Managing Pet Waste) provided to the local Humane Society and veterinary offices.
- Storm Drain Marker Program in coordination with Wenatchee High School Earth Club.
- Radio advertisement on Sunny FM on illicit discharges and how to report a problem.
- Mailing to local towing companies about cleaning up after accidents.
- Vehicle washing information update and posted on the regional web page.

Information was also provided at the Public Works Department at 316 Washington Street, Suite 402 and online at www.wenatcheewa.gov/wvstac. In 2017 the Wenatchee Valley Stormwater webpage received 557 hits.

The local Phase II permittees again provided a survey at the KPQ Home & Garden Show and online through the end of the year.

2017 Opportunities for Public Participation Chelan County

Citizens in the Wenatchee Valley were provided the following opportunities to participate in the decision making process involving the development, implementation and updates of the Wenatchee Valley Stormwater Management Program in 2017:

- The local jurisdictions provide email updates about stormwater events and issues to the Wenatchee Valley Stormwater Steering Committee. The committee includes citizens, elected officials, jurisdiction staff, business owners, engineers, environmental group representatives, and other interested parties. In 2017 members of the committee participated in Municipal Stormwater School presented on March 22, 2017 by ECOSS.
- A subcommittee of the Wenatchee Valley Stormwater Steering Committee was formed in 2017 to review the draft Stormwater Management Manual for Eastern Washington. Additional stakeholders were invited from the design, architect, engineer, and survey companies in Chelan County, Douglas County, Wenatchee and East Wenatchee. Two meetings were held to review the manual and collect comments on August 16th and September 27th.
- Updates to the Wenatchee Valley Stormwater Management Program are posted on the regional stormwater page (www.wenatcheewa.gov/wvstac) and an online comment form is available for the public to provide comments.
- The Board of County Commissioners take public comments at Commissioner meetings, which are typically held weekly. Notices of meetings are posted on the County website and citizens can sign up to receive information by email.
- Attendees at the annual KPQ Home Show are encouraged to provide comments on the Wenatchee Valley Stormwater Management Program as part of the annual stormwater survey.

WENATCHEE VALLEY STORMWATER PROGRAM

Discussion : UPDATE of Stormwater Management Manual for Eastern Washington (SWMMEW)

Local Outreach Opportunity

Wednesday: August 16, 2017 12:00 - 1:00 (North Central Regional Library)

Wenatchee Valley
Stormwater Program



Chelan County - Wenatchee - Douglas County - East Wenatchee



City of
Wenatchee



	Name	PLEASE SIGN IN	Address or e-mail	Phone
1	John Torrence		john.t@torrence-eng.com	782 1897
2	Aaron Rapozo			
3	Angi Waligorski		awaligorski@hotmail.com	886-167165
4	Charley Underwood		Charley.U@tx1cnr.com	432-3492
5	Dan Ireland		DAN.IRELAND@SCJALANCE.COM	352-1465
6	Dan Sutton			
7	Greg Pezoldt		gpezoldt@east-wenatchee.com	888.8126
8	Jason Detamore		Jason.Detamore@co.chelan.wa.us	667-6573
9	Jeff Sutton		jeffs@erlindsen.com	884-2562
10	Jennifer Lange		jlange@co.douglas.wa.us	884-7173
11	Jessica Shaw		jshaw@WenatcheeWA.gov	888-3225
12	Josh Fedora		josh@kpg.com	860-2426
13	Keith Goehner			669-7338
14	Kurt Hosan		Kurt@doosever.org	264-7818
15	Larry Cordes		larry@paccorps.com	662-1762
16	Lyle Markhart		MARKHART@WIENATCHEEWA	665-0823
17	Ryan Harmon		ryan.harmon@scjallance.com	352-1465
18	Ryan Peterson			
19	Tom Wachholder		twachholder@east-wenatchee.com	886-6111
20	Will Kirby		wkirby@g-o.com	425 443 0514
21	Keith Huffaker		khuffaker@WenatcheeWA.gov	509-888-8968
22				
23				
24				
25				
26				
27				
28				

WENATCHEE VALLEY STORMWATER PROGRAM

Discussion : UPDATE of Stormwater Management Manual for Eastern Washington (SWMMEW)

Local Outreach Opportunity #2 (WVC - Van Tassel Center - Cafeteria Conference Room)

Wednesday: September 27, 2017 12:00 - 1:00 (Wenatchee Valley College)

Wenatchee Valley
Stormwater Program



Chelan County • Wenatchee • Douglas County • East Wenatchee



City of
Wenatchee



509-662-1762

	Name		PLEASE SIGN IN	Address or e-mail	Phone
1	Larry	Cordes		larryc@pccengrs.com	
2	Mike	Cushman		MIKEL@CASCADIA.CO.ORG	
3	Jason	Detamore		on file	667-6915
4	Dave	Dormier		DAVIDD@ERLANDSEN.COM	884-2562
5	April	Featherkile		afeatherkile@gmail.com	667-0867
6	Josh	Fedora		josh@kpg.com	860-2426
7	Colton	Freels		coltonf@erlandsen.com	884-2562
8	Keith	Goehner			
9	Ryan	Harmon			
10	Kurt	Hosman			
11	Joe	Howard		joe@erlandsen.com	884-2562
12	Dan	Ireland			
13	Will	Kirby		willkirby@co-douglas.wa.us wkirby@co-o.com	425 443 0574
14	Jennifer	Lange		jlange@co.douglas.wa.us	509 884-7173
15	Lyle	Markhart			
16	Ryan	Peterson			
17	Greg	Pezoldt			
18	Aaron	Rapozo			
19	Jessica	Shaw		jshaw@wenatchee.wa.gov	888-3225
20	Kyle	Steinburg			
21	Dan	Sutton		on file	
22	Jeff	Sutton		jeffs@erlandsen.com	884-2562
23	John	Torrence		john.t@torrence-cug.com	782 1897
24	Charley	Underwood			
25	Tom	Wachholder		twachholder@east-wenatchee.com	
26	Angi	Waligorski		awaligorski@rh7.com	886-6765
27	Mitch	Reister		mreister@wenatchee.wa.gov	888-3227
28					

CHELAN COUNTY PUBLIC WORKS

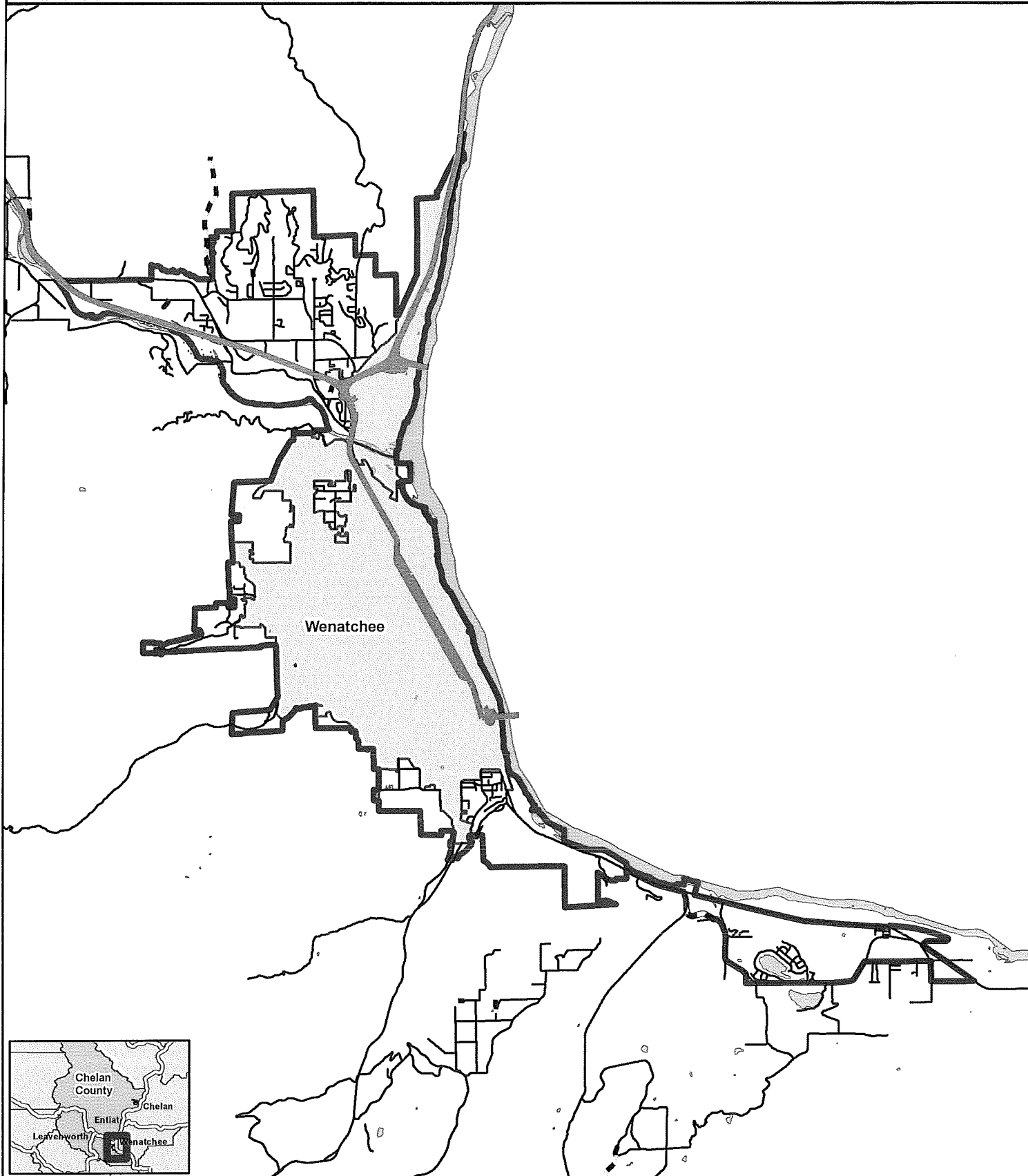

0 5,500 11,000 22,000
Feet

— NPDES Permit Boundary

This map is a graphic representation derived from Chelan County's Geographic Information System. It is designed and intended for reference only. Chelan County does not warrant, guarantee, or accept liability for the accuracy, timeliness, or completeness of any information provided therein. Users shall be responsible to independently verify all information contained in this map.

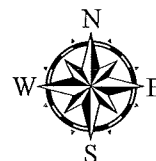

Print Date: 3/28/2018