

- GENERAL SECTION NOTES**
- 1) UNDERGROUND UTILITIES NOT SHOWN IN SECTION VIEW FOR CLARITY.
 - 2) ALL DISTANCES AND SLOPES SHOWN ARE TYPICAL UNLESS SHOWN OTHERWISE. SEE PLAN VIEW FOR TAPERS, WIDENINGS, INTERSECTION AREAS, ETC.
 - 3) EXPANSION JOINTS SHALL BE INSTALLED PER WSDOT STANDARD PLAN F-30.10-03. ALL EXPANSION JOINTS SHALL BE FULL DEPTH ON ALL SIDES OF THE EXPANSION JOINT MATERIAL.
 - 4) SIDEWALK SHOWN WITH 1.5% SLOPE. SIDEWALK MUST MEET ADA SLOPE STANDARD MAX. CROSS SLOPE AND DRAIN WITH MIN. 1% OUT TO CURB.
 - 5) SEE WSDOT STANDARD PLAN F-10.18-01 FOR ROUNDABOUT CURB AND CURB PLACEMENT DETAILS.
- * DIMENSIONS ARE TYPICAL BUT VARY AT INTERSECTION AND ROUNDABOUT, SEE ALIGNMENT FOR ACTUAL WIDTHS

ENGINEER REVIEWER DEP AMW SCALE: SHOWN DRAWING IS FULL SCALE WHEN BAR MEASURES 2"	RH2 ENGINEERING, INC. 300 SIMON ST SE, SUITE 5 EAST WENATCHEE, WA 98802 1.800.720.8052 WWW.RH2.COM	DATE: 7/13/2018 ISSUED / REVISED: 90% PRELIMINARY TEAM REVIEW BY:	 Chelan County Public Works Department 316 Washington Street, Suite 402 Wenatchee, Washington, 98801 Phone: 509.667.6415 Web Address: www.co.chelan.wa.us	WEST CASHMERE BRIDGE REPLACEMENT PROJECT CRP 693 ROADWAY TYPICAL SECTIONS AND DETAILS	CRP693 SHEET RS1 PAGE 8 OF 156
--	--	---	---	--	--------------------------------------

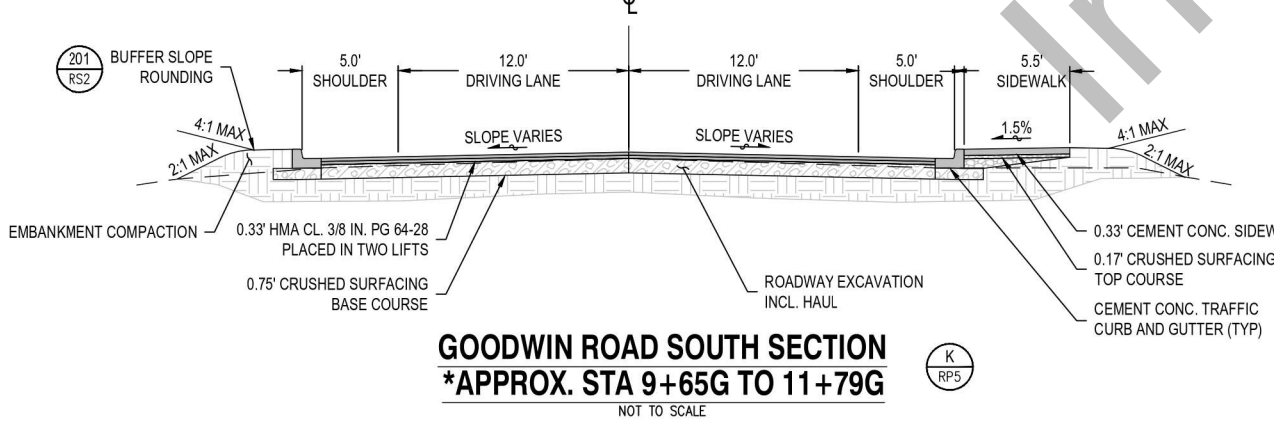

- GENERAL SECTION NOTES**
- 1) UNDERGROUND UTILITIES NOT SHOWN IN SECTION VIEW FOR CLARITY.
 - 2) ALL DISTANCES AND SLOPES SHOWN ARE TYPICAL UNLESS SHOWN OTHERWISE. SEE PLAN VIEW FOR TAPERS, WIDENINGS, INTERSECTION AREAS, ETC.
 - 3) EXPANSION JOINTS SHALL BE INSTALLED PER WSDOT STANDARD PLAN F-30.10-03. ALL EXPANSION JOINTS SHALL BE FULL DEPTH ON ALL SIDES OF THE EXPANSION JOINT MATERIAL.
 - 4) SIDEWALK SHOWN WITH 1.5% SLOPE. SIDEWALK MUST MEET ADA SLOPE STANDARD MAX. CROSS SLOPE AND DRAIN WITH MIN. 1% OUT TO CURB.
 - 5) SEE WSDOT STANDARD PLAN F-10.18-01 FOR ROUNDABOUT CURB AND CURB PLACEMENT DETAILS.
- * DIMENSIONS ARE TYPICAL BUT VARY AT INTERSECTION AND ROUNDABOUT, SEE ALIGNMENT FOR ACTUAL WIDTHS

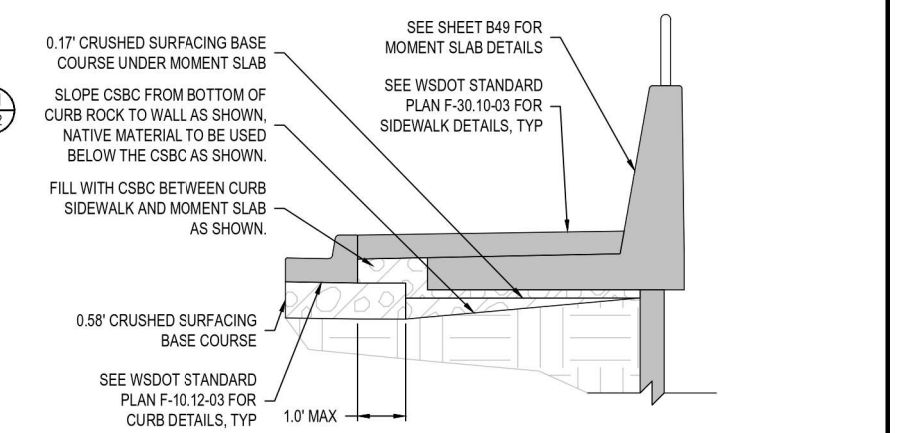
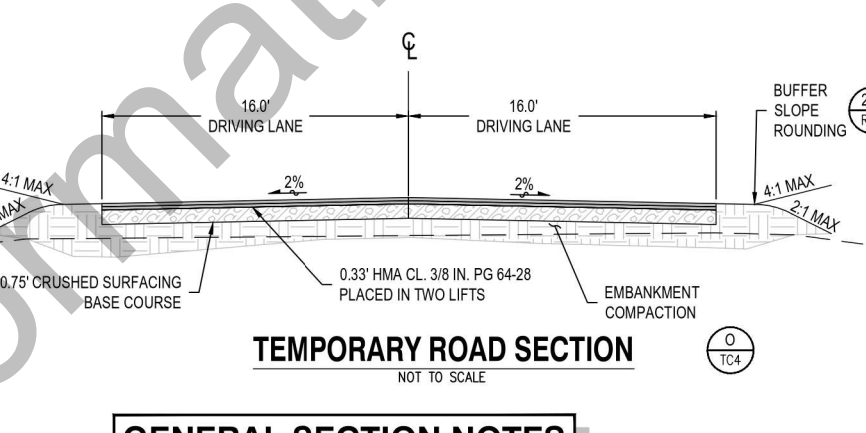
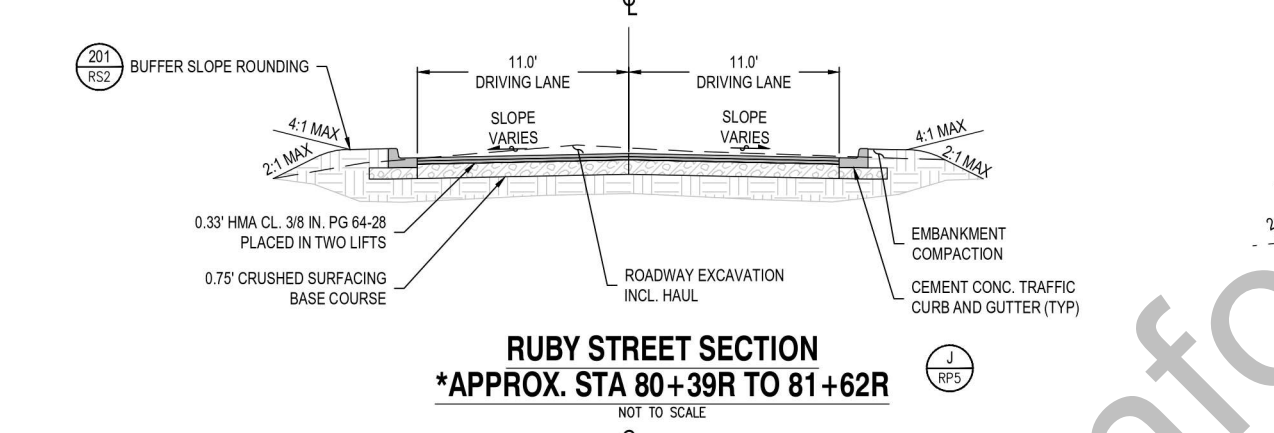
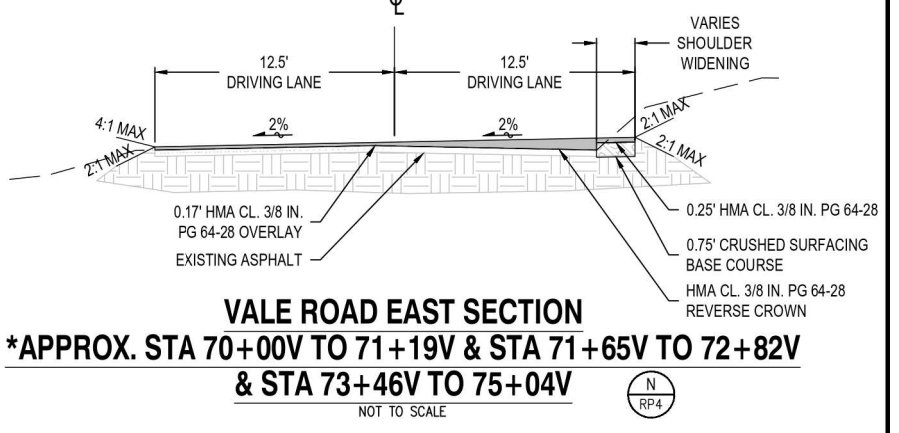
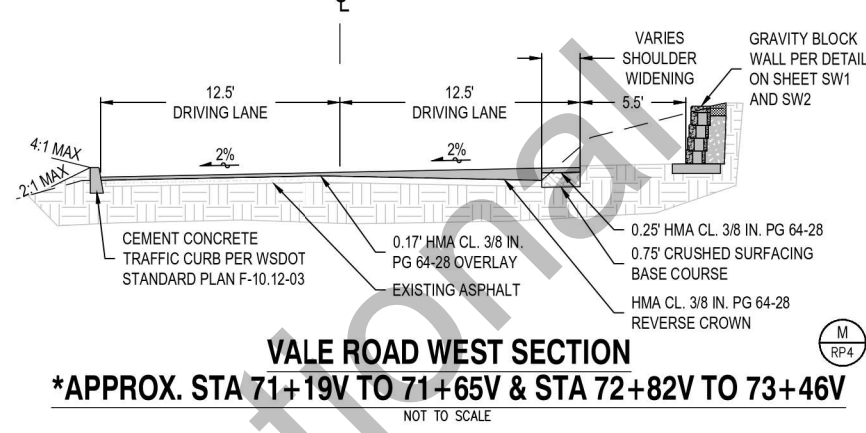
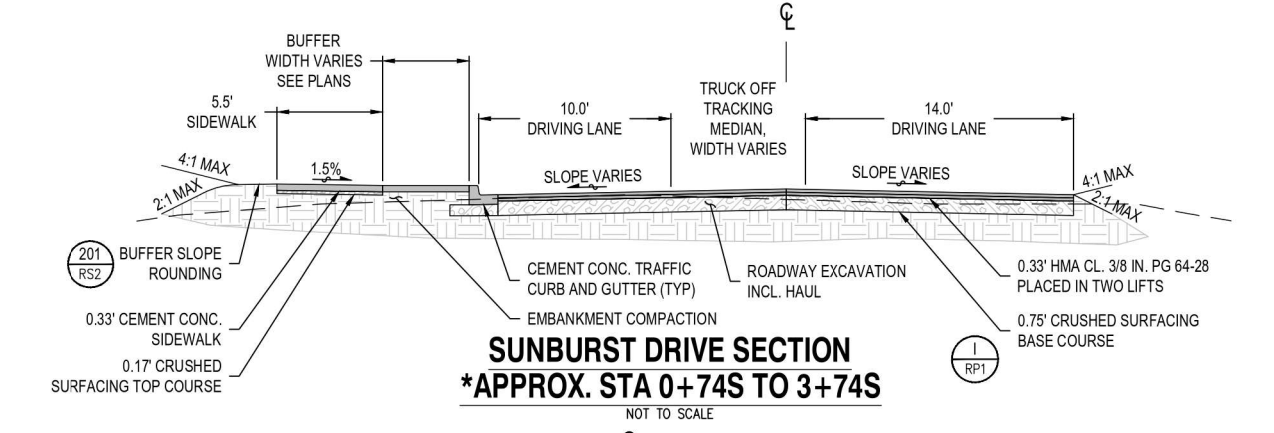
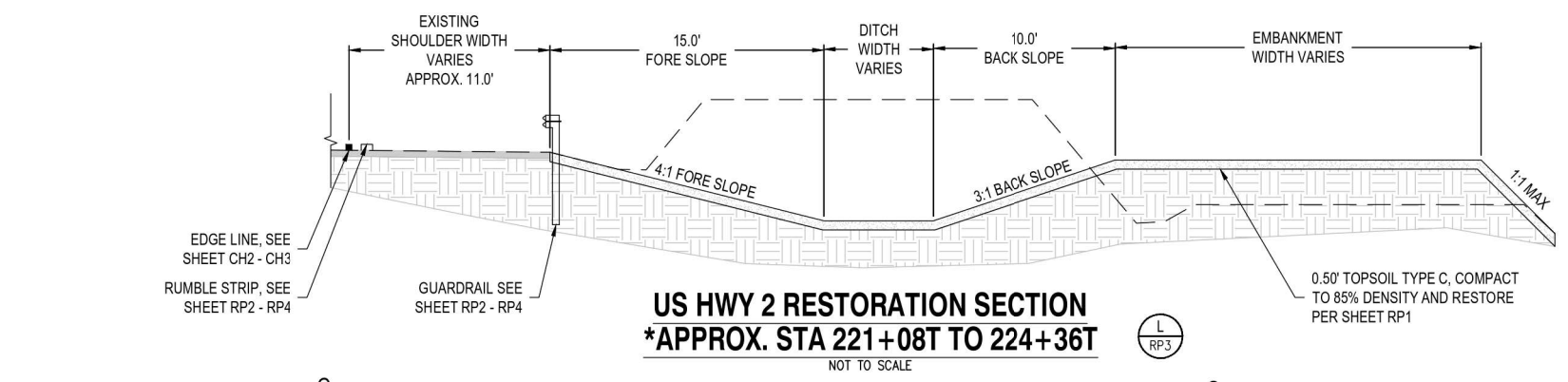
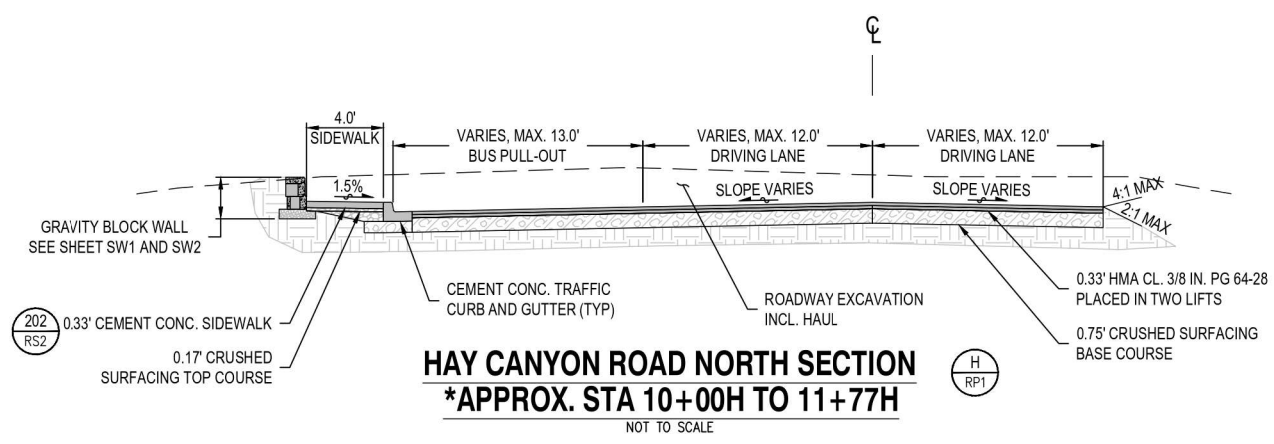
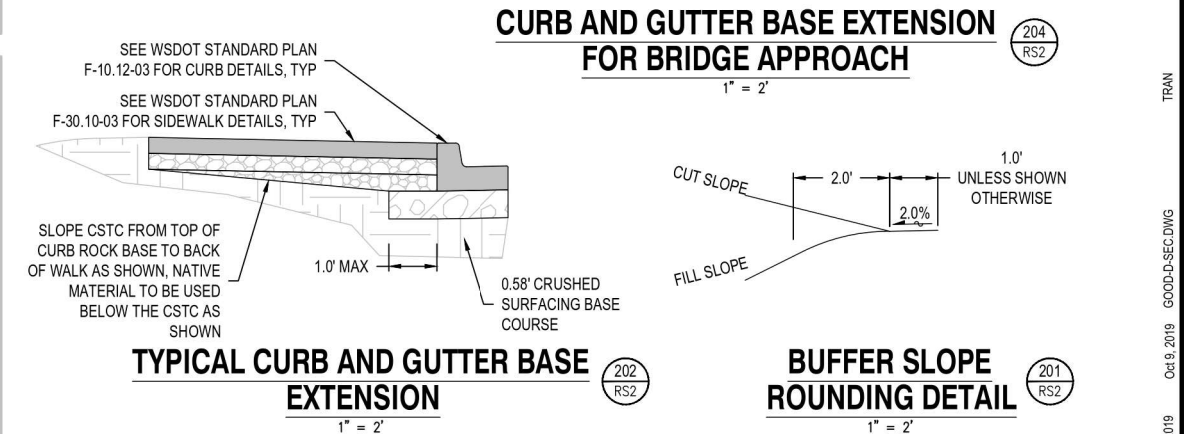

ENGINEER REVIEWER DEP AMW

RH2

SCALE: SHOWN
DRAWING IS FULL SCALE WHEN BAR MEASURES 2"

RH2 ENGINEERING, INC.
300 SIMON ST SE, SUITE 5
EAST WENATCHEE, WA 98802
1.800.720.8052
WWW.RH2.COM

DATE:	ISSUED / REVISED	BY:
7/13/2018	90% PRELIMINARY TEAM REVIEW	

Chelan County Public Works Department
316 Washington Street, Suite 402
Wenatchee, Washington, 98801
Phone: 509. 667. 6415
Web Address: www.co.chelan.wa.us

WEST CASHMERE BRIDGE REPLACEMENT PROJECT
CRP 693

ROADWAY TYPICAL SECTIONS AND DETAILS

CRP693
SHEET RS2
PAGE 9 OF 156

Oct 9, 2019 GOODD-SEC2.DWG TRAN

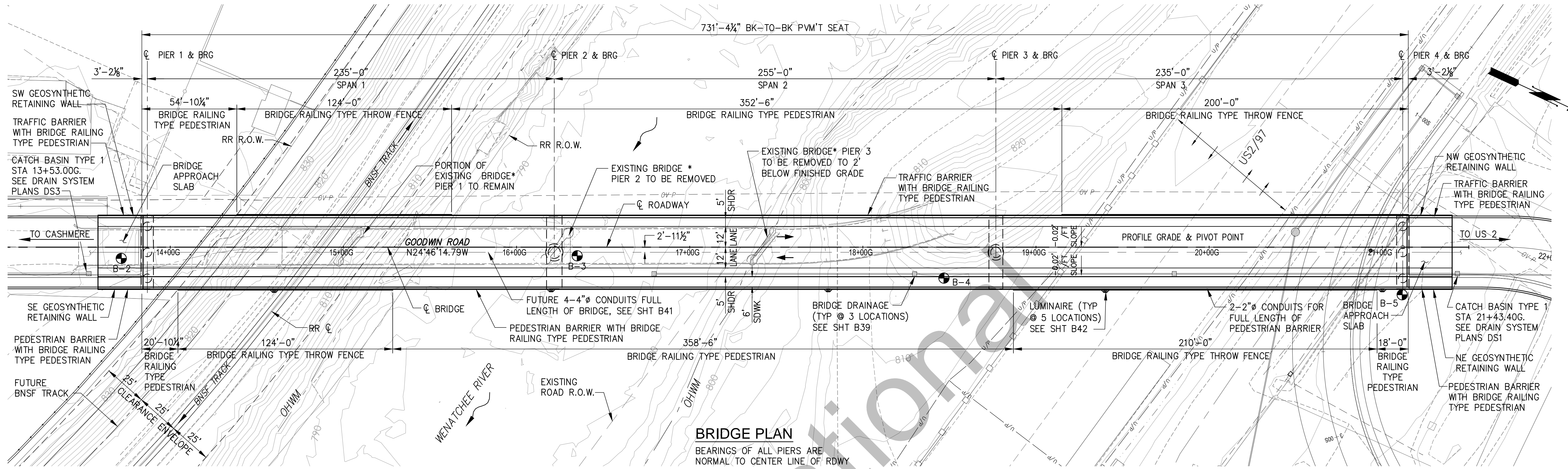

BRIDGE PLAN

BEARINGS OF ALL PIERS ARE NORMAL TO CENTER LINE OF RDWY

LEGEND

- * EXISTING BRIDGE IS GOODWIN ROAD WEST CASHMERE BRIDGE, BRIDGE 401
- † SEE NOTE 5 ON SHEET B11
- ⊕ GEOTECHNICAL BORING LOCATION AND DESIGNATION

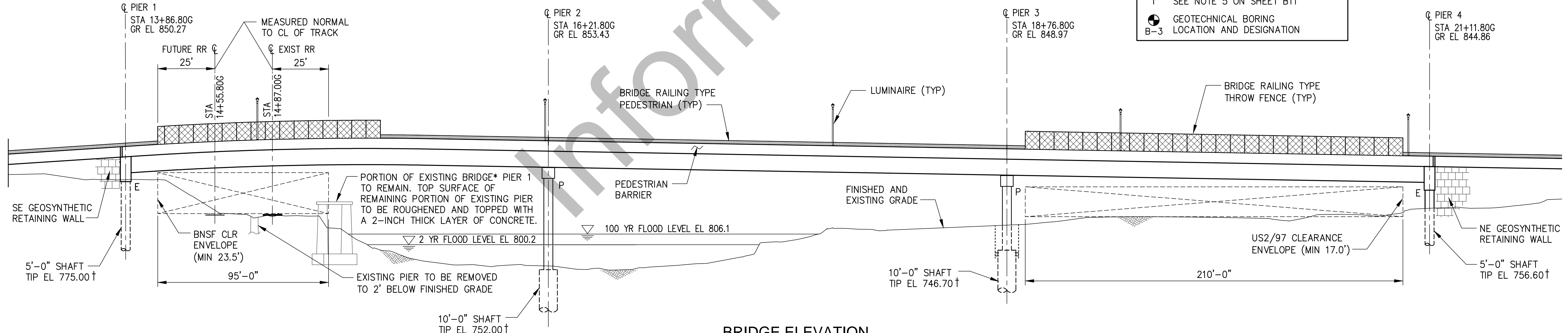

BRIDGE ELEVATION

(LOOKING UPSTREAM)
GRADE ELEVATIONS SHOWN ARE FINISH GRADES AT TOP OF DECK AND ARE EQUAL TO PROFILE GRADE AT CL RDWY

COMPOSITE STEEL PLATE GIRDER - HL-93 LOADING

RR MP 1662.23 LINE SEMENT 37 SCENIC SUBDIVISION CASHMERE
WASHINGTON - CHELAN COUNTY 47°31'37" N 120°29'20.73"W

BELLEVUE OFFICE:
365 - 118th AVE. SE, STE 100
BELLEVUE, WA 98005
WWW.TRANTECHENG.COM
PH: 425-453-5545
FAX: 425-453-6779

DATE:	ISSUED / REVISED	BY:



Chelan County
Public Works Department
316 Washington Street, Suite 402
Wenatchee, Washington, 98801
Phone: 509.667.6415
Web Address: www.co.chelan.wa.us

WEST CASHMERE BRIDGE REPLACEMENT PROJECT
BRIDGE PLAN AND ELEVATION

PROJECT NUMBER
CRP693
SHEET
B1
PAGE
85 OF 155

P:\2018\2018001 - Chelan County - Chelan Bridge Replacement\000_GAD\PS&E\SUBMITTALS\B1.DWG, VAB:BI modified by djpm on Oct 09, 2019 - 2:29:49

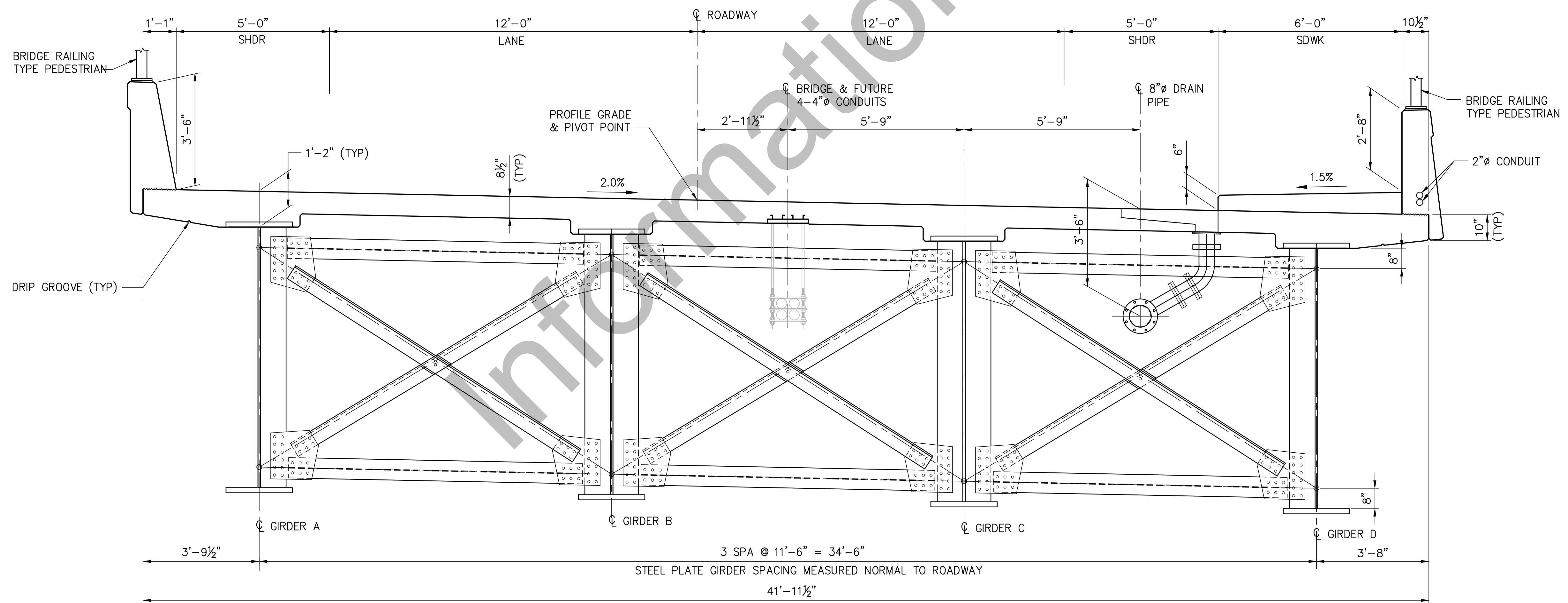
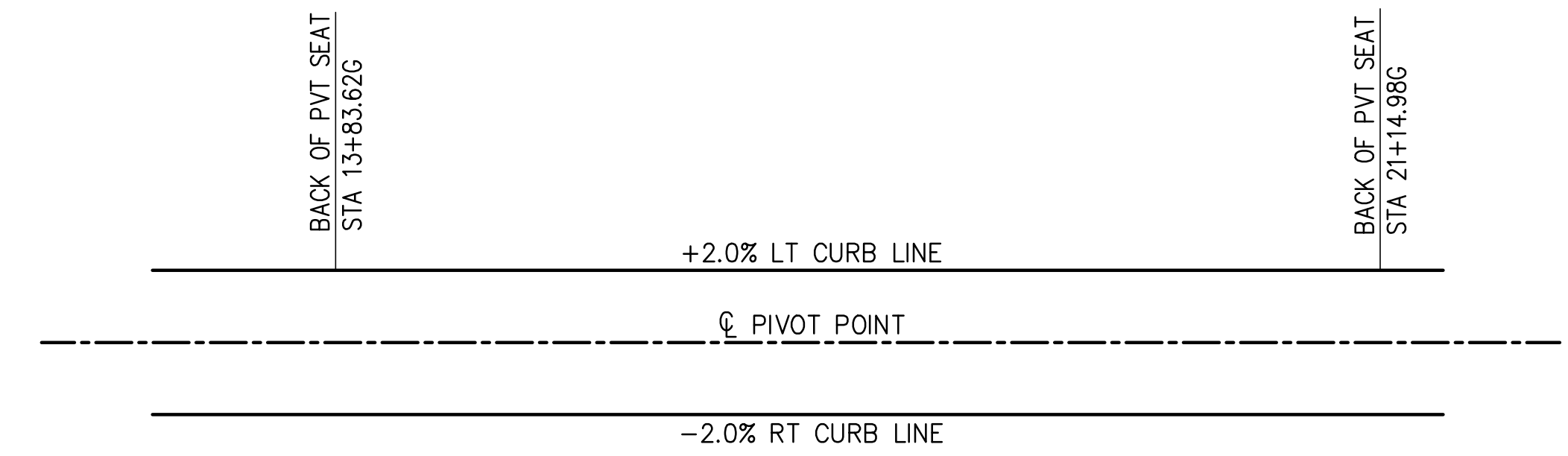
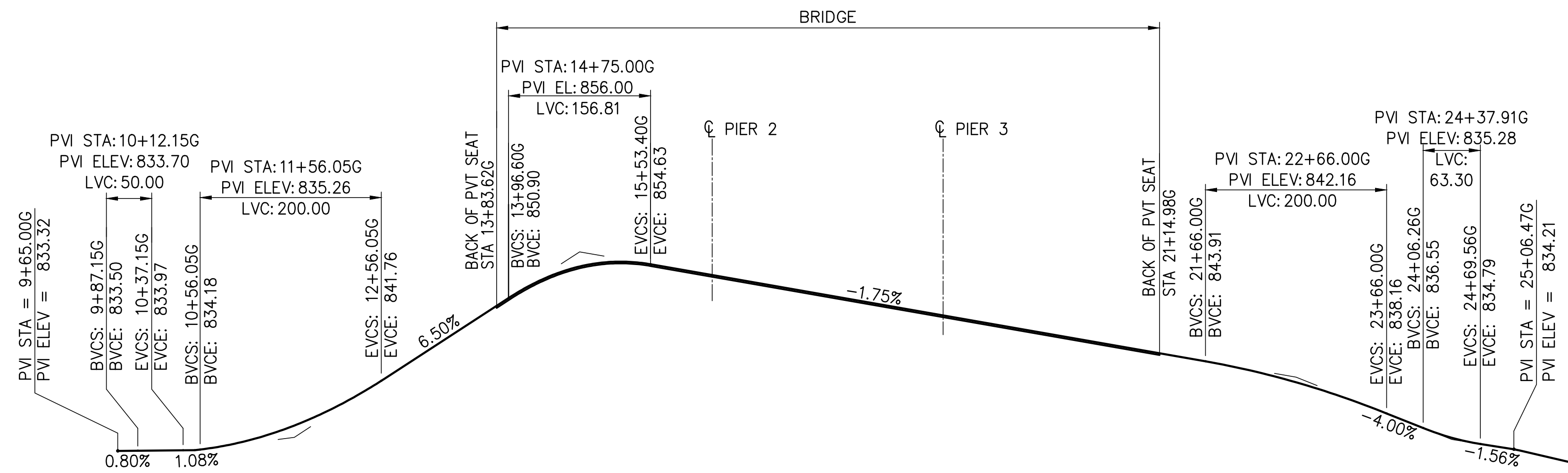

BELLEVUE OFFICE:
365 - 118th AVE. SE, STE 100
BELLEVUE, WA 98005
WWW.TRANTECHENG.COM
PH: 425-453-5545
FAX: 425-453-6779

DATE:	ISSUED / REVISED	BY:



Chelan County
Public Works Department
316 Washington Street, Suite 402
Wenatchee, Washington, 98801
Phone: 509. 667. 6415
Web Address: www.co.chelan.wa.us

WEST CASHMERE BRIDGE REPLACEMENT PROJECT
PROFILE, SUPERELEVATION & TYPICAL SECTION

PROJECT NUMBER
CRP693
SHEET
B3
PAGE
87 OF 155

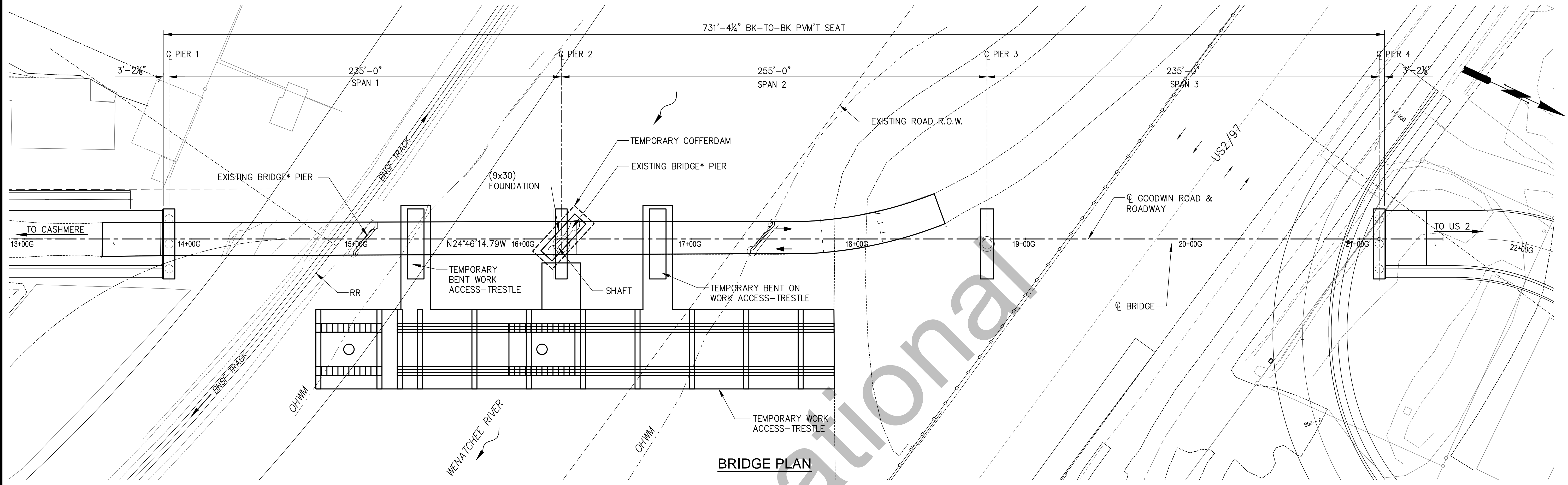

BRIDGE PLAN

* EXISTING BRIDGE IS GOODWIN ROAD WEST CASHMERE BRIDGE, BRIDGE 401
 ** THE 2 YR AND 100 YR FLOOD LEVEL ARE WATER LEVELS AFTER ALL CONSTRUCTION IS COMPLETED. THESE NUMBERS DO NOT REFLECT THE CONSTRUCTION OF TEMPORARY COFFERDAM AND TEMPORARY WORK ACCESS TRESTLE.

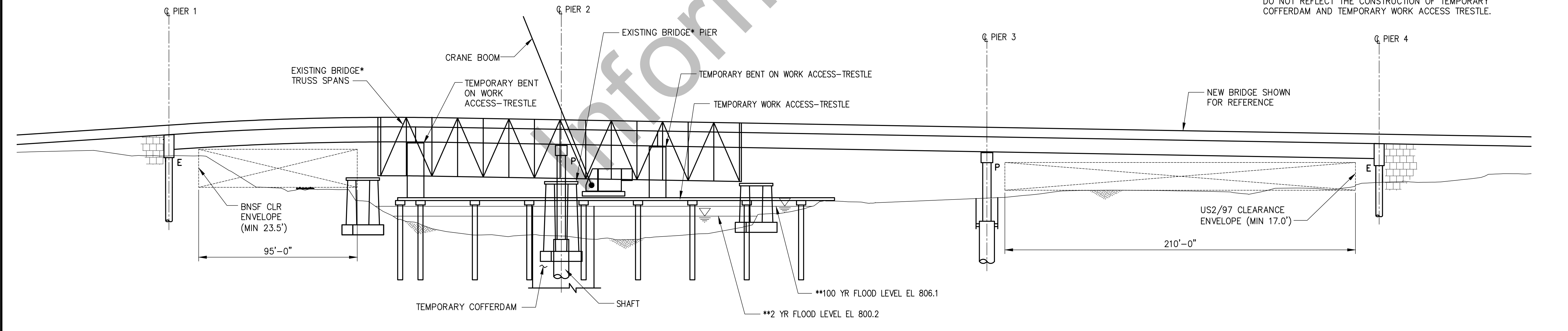

BRIDGE ELEVATION

STEP 3



BELLEVUE OFFICE:
 365 - 118th AVE. SE, STE 100
 BELLEVUE, WA 98005
 WWW.TRANTECHENG.COM
 PH: 425-453-5545
 FAX: 425-453-6779

DATE:	ISSUED / REVISED	BY:

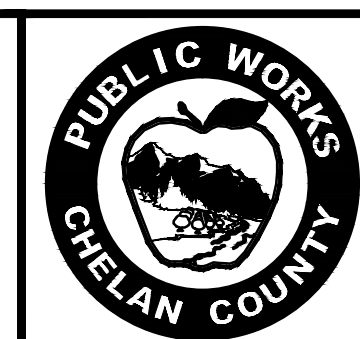
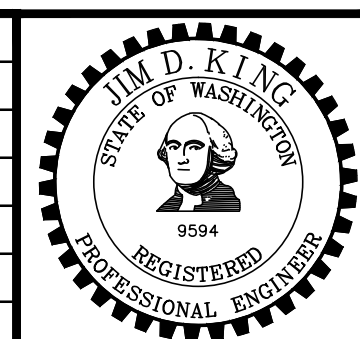

Chelan County
 Public Works Department
 316 Washington Street, Suite 402
 Wenatchee, Washington, 98801
 Phone: 509. 667. 6415
 Web Address: www.co.chelan.wa.us

WEST CASHMERE BRIDGE REPLACEMENT PROJECT
CONSTRUCTION SEQUENCE CONCEPT 3 OF 6

PROJECT NUMBER
CRP693
 SHEET
B6
 PAGE
 90 OF 155

P:\2016\2016001 - Chelan County - Doublin Bridge Replacement\1000 CAD\PS&E\SUBMITTALS\B6.B6 modified by djpsen on Oct 09, 2019 - 2:1:13

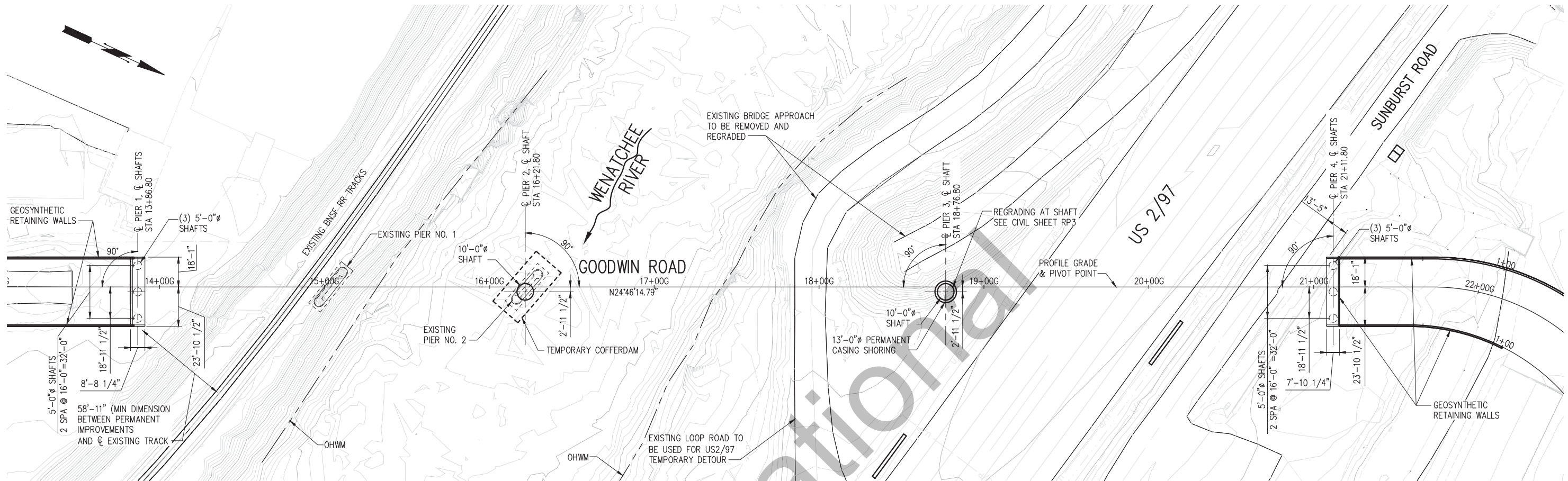

BRIDGE FOUNDATION LAYOUT PLAN

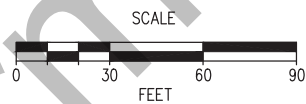

BEARING OF ALL PIERS IS N65° 13' 45.21"E

NOTES:

- TEMPORARY COFFERDAM AND WORK ACCESS - BR. NO. 401 SHALL BE DESIGNED BY CONTRACTOR BASED ON THE PARAMETERS DESCRIBED IN THE GEOTECHNICAL REPORT AND THE REQUIREMENTS OF THE PROJECT SPECIFICATIONS.

V:\160023 (W Cashmere Bridge)\Design\WCB-B10.dwg\16B10.dwg modified by nabin on Oct 09, 2019 - 11:40



Know what's below.
Call before you dig.
Determina lo que esta bajo tierra.
Llama antes de excavar.



1601 5th Avenue
Suite 1600
Seattle, WA 98101
206.622.5822
www.kpff.com

DATE:	ISSUED / REVISED	BY:



Chelan County
Public Works Department
316 Washington Street, Suite 402
Wenatchee, Washington, 98801
Phone: 509.667.6415
Web Address: www.co.chelan.wa.us

WEST CASHMERE BRIDGE REPLACEMENT PROJECT
BRIDGE FOUNDATION LAYOUT

PROJECT NUMBER
CRP693
SHEET
B10
PAGE
94 OF 155

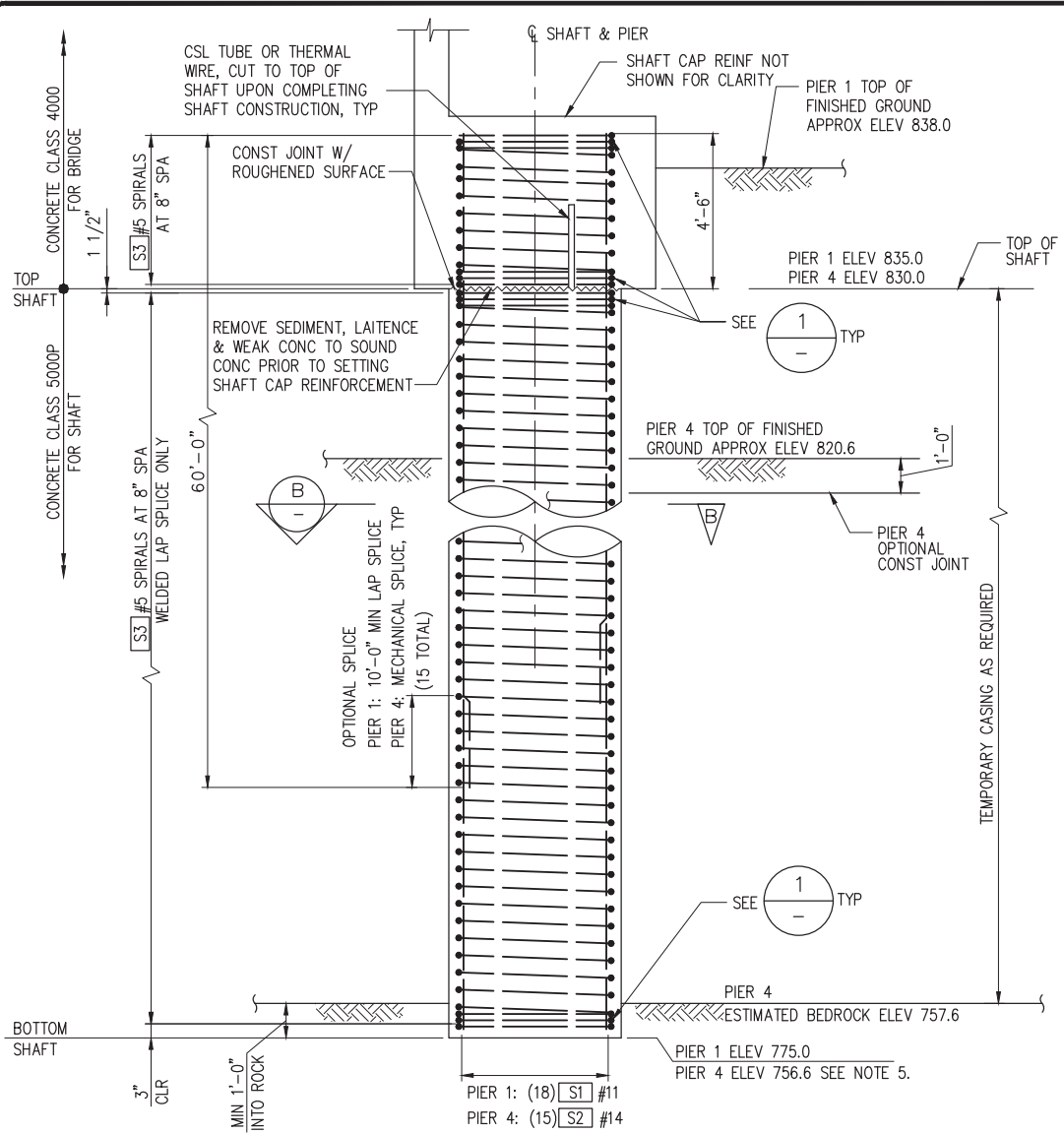

A SHAFT ELEVATION
SCALE: 3/8"=1'-0"

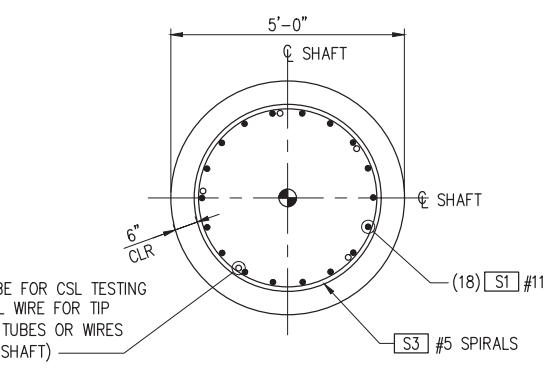

B SECTION - PIER 1 SHAFT
SCALE: 1/2"=1'-0"

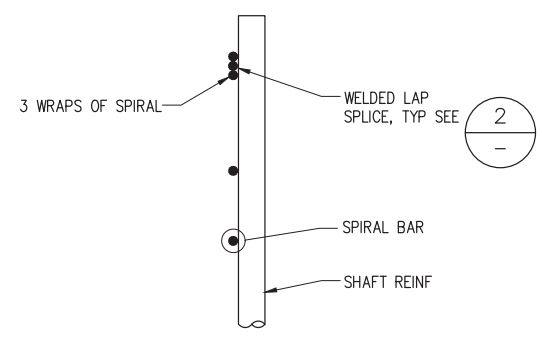

1 DETAIL
SCALE: N.T.S.

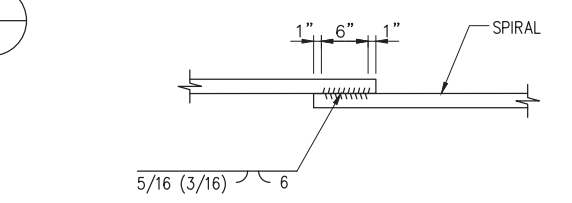

2 WELDED LAP SPLICE DETAIL
SCALE: N.T.S.

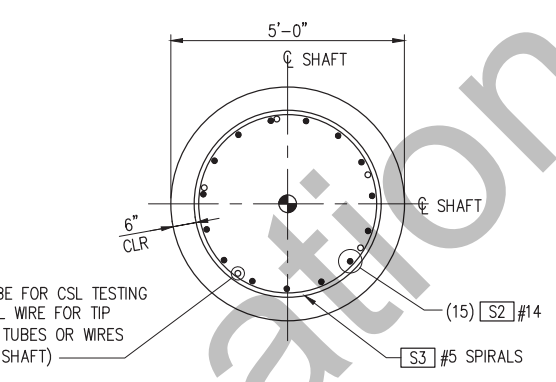

B SECTION - PIER 4 SHAFT
SCALE: 1/2"=1'-0"

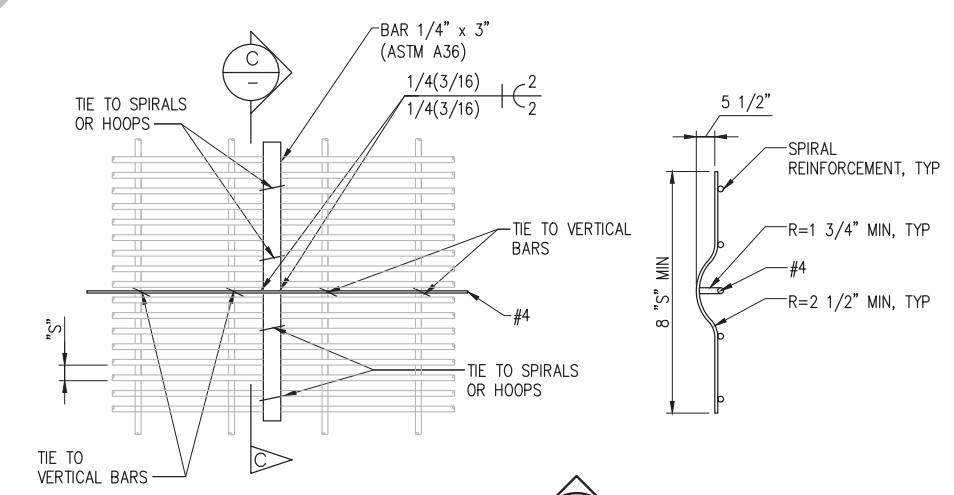

C CENTRALIZER
SCALE: NTS

C VIEW
SCALE: NTS

SHAFT NOTES:

- PIER 1 AND 4 DRILLED SHAFTS SHALL NOT BE INSTALLED UNTIL AFTER THE GEOSYNTHETIC RETAINING WALLS HAVE BEEN INSTALLED.
- STAGGER LAP SPLICE LOCATION BY SPLICE LENGTH FOR PIER 1. STAGGER MECHANICAL SPLICE LOCATION BY 4'-0" FOR ADJACENT BARS FOR PIER 4.
- LONGITUDINAL REINFORCEMENT MECHANICAL SPLICE IN PIER 4 SHALL MEET THE REQUIREMENT OF THE WSDOT STD SPECS, SECTION 6-02.3(24)F.
- SHAFT SPIRAL REINFORCEMENT SHALL HAVE WELDED LAP SPLICE ONLY AS SHOWN IN WELDED LAP SPLICE DETAIL, THIS SHEET. WELDING SHALL MEET THE REQUIREMENT OF THE WSDOT STD SPECS, SECTION 6-02.3(24)E.
- NO WELDING OF SPIRAL IS PERMITTED AFTER THE SHAFT CAGE IS ASSEMBLED. SPIRALS SHALL BE FIELD OR SHOP WELDED INDEPENDENTLY AND THEN ASSEMBLED AROUND THE SHAFT LONGITUDINAL REINFORCEMENT.
- ELEVATION GIVEN IS BASED ON ESTIMATED BEDROCK ELEVATION, AND SHALL BE THE BASIS FOR BIDS. CONTRACTOR TO VERIFY ACTUAL BEDROCK ELEVATION IN FIELD AND EXTEND SHAFT A MINIMUM OF 12" INTO ROCK AT PIER 4 ONLY.

CENTRALIZER NOTES:

- CENTRALIZERS SHALL BE EPOXY COATED OR PAINTED WITH INORGANIC ZINC AFTER FABRICATION.
- EACH LEG SHALL BE TIED TO TWO VERTICAL BAR BUNDLES AND TWO SPIRAL WRAPS OR TWO HOOPS.
- SEE STANDARD SPECIFICATION 6-19.3(5)B FOR CENTRALIZER SPACING REQUIREMENTS.

SHAFT BAR LIST				
LOCATION	MARK	SIZE	NO.	BEND TYPE *
PIER 1	S1	#11	54	89
	S3	#5	3	67
PIER 4	S2	#14	45	50
	S3	#5	3	67

* SEE SHEET B55 FOR BEND TYPE DIAGRAMS

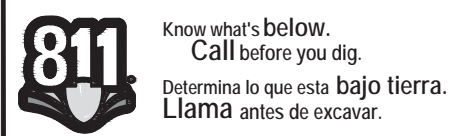

1601 5th Avenue
Suite 1600
Seattle, WA 98101
206.622.5822
www.kpff.com

DATE:	ISSUED / REVISED	BY:

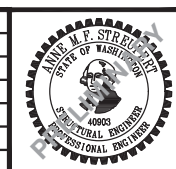

Chelan County
Public Works Department
316 Washington Street, Suite 402
Wenatchee, Washington, 98801
Phone: 509.667.6415
Web Address: www.co.chelan.wa.us

WEST CASHMERE BRIDGE REPLACEMENT PROJECT
SHAFT DETAILS - PIER 1 & 4

PROJECT NUMBER
CRP693
SHEET
B11
PAGE
95 OF 155

V:\160023 (W Cashmere Bridge)\Design\WCB-B12.dwg\16B12.dwg modified by nabin on Oct 09, 2019 - 8:05

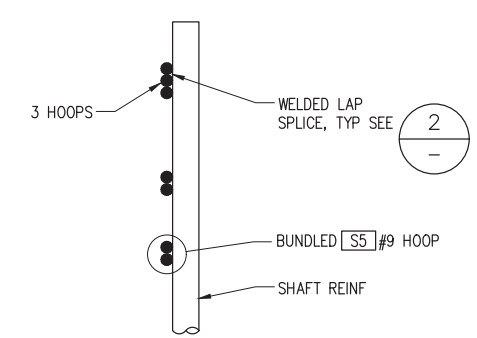
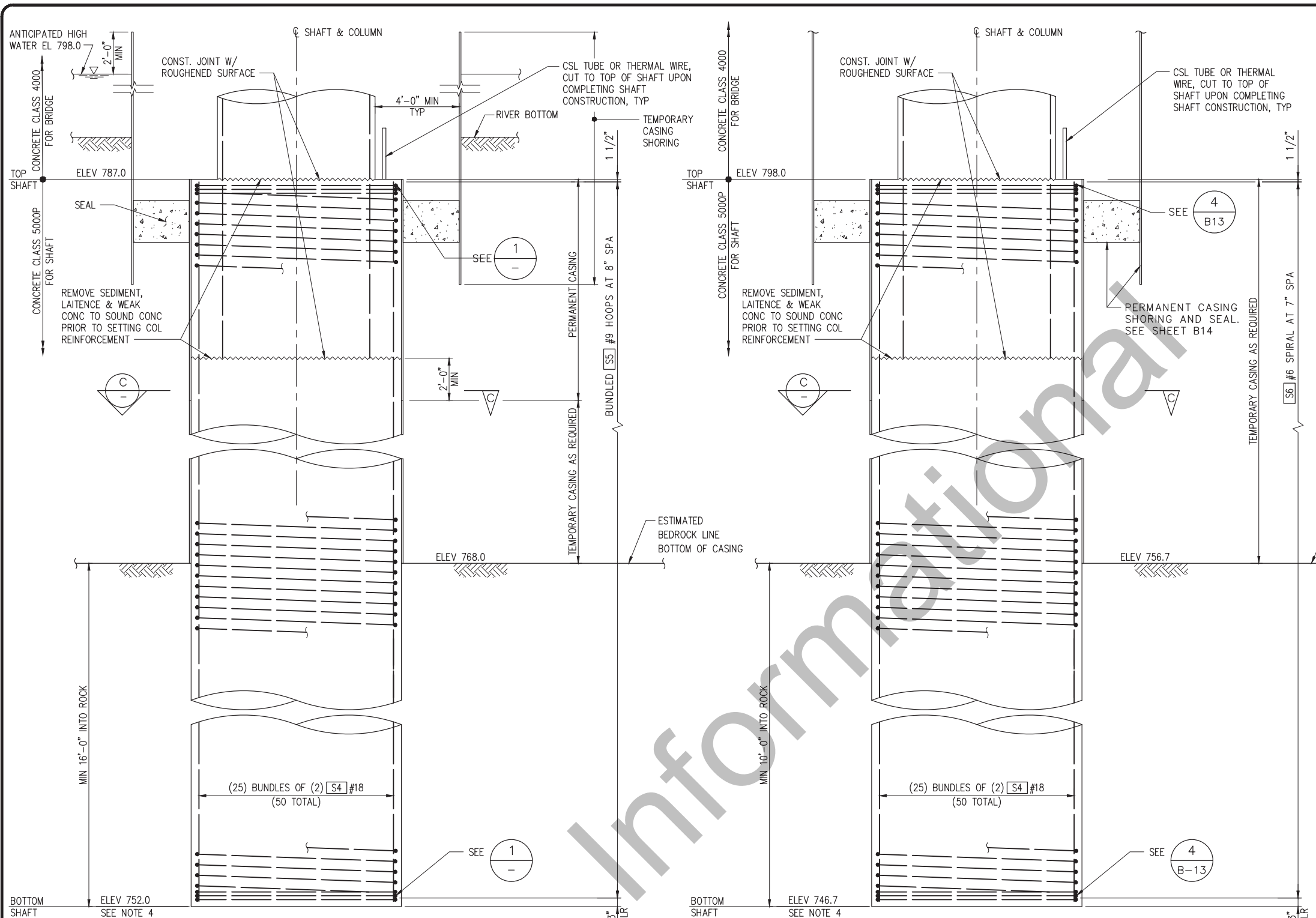

1 DETAIL
SCALE: N.T.S.

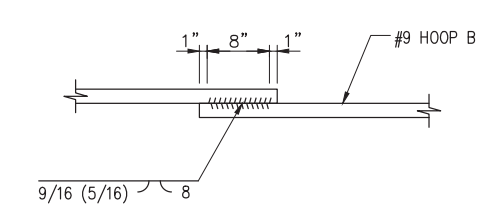

NOTE: WELDING SHALL MEET REQUIREMENTS OF STD SPEC 6-02.3(24)E
2 WELDED LAP SPLICE DETAIL
SCALE: N.T.S.

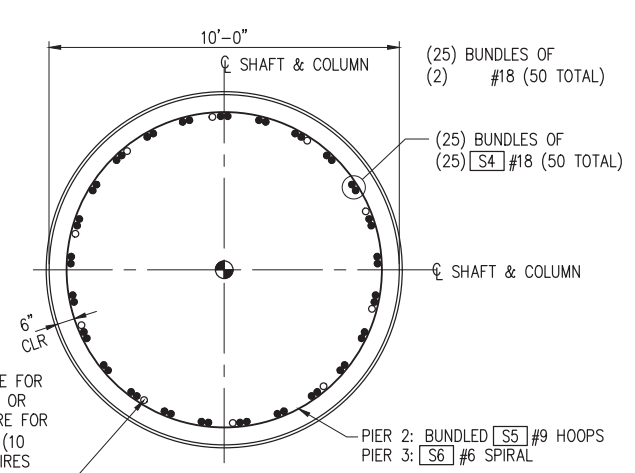

C SECTION - SHAFT
SCALE: 3/8"=1'-0"

A PIER 2 SHAFT ELEVATION
SCALE: 3/8"=1'-0"

SHAFT NOTES:

- SEE SHAFT NOTES ON B11.
- SEE SHEET B11 FOR CENTRALIZER DETAILS AND NOTES.
- PIER 2 AND PIER 3 SHAFT LONGITUDINAL REINFORCEMENT SHALL CONFORM TO ASTM A706, GRADE 80.
- ELEVATION GIVEN IS BASED ON ESTIMATED BEDROCK ELEVATION, AND SHALL BE THE BASIS FOR BIDS. CONTRACTOR TO VERIFY ACTUAL BEDROCK ELEVATION IN FIELD AND EXTEND SHAFTS THE REQUIRED DEPTHS INTO BEDROCK.

B PIER 3 SHAFT ELEVATION
SCALE: 3/8"=1'-0"

SHAFT BAR LIST				
LOCATION	MARK	SIZE	NO.	BEND TYPE *
PIER 2	S4	#18	50	50
	S5	#9	92	66
PIER 3	S4	#18	50	50
	S6	#6	1	67

* SEE SHEET B55 FOR BEND TYPE DIAGRAMS

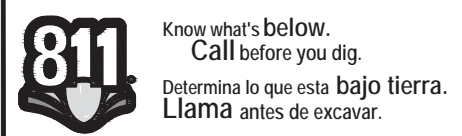

1601 5th Avenue
Suite 1600
Seattle, WA 98101
206.622.5822
www.kpff.com

DATE:	ISSUED / REVISED	BY:

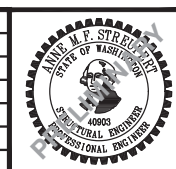

Chelan County
Public Works Department
316 Washington Street, Suite 402
Wenatchee, Washington, 98801
Phone: 509.667.6415
Web Address: www.co.chelan.wa.us

WEST CASHMERE BRIDGE REPLACEMENT PROJECT
SHAFT DETAILS - PIER 2 & 3

PROJECT NUMBER
CRP693
SHEET
B12
PAGE
96 OF 155

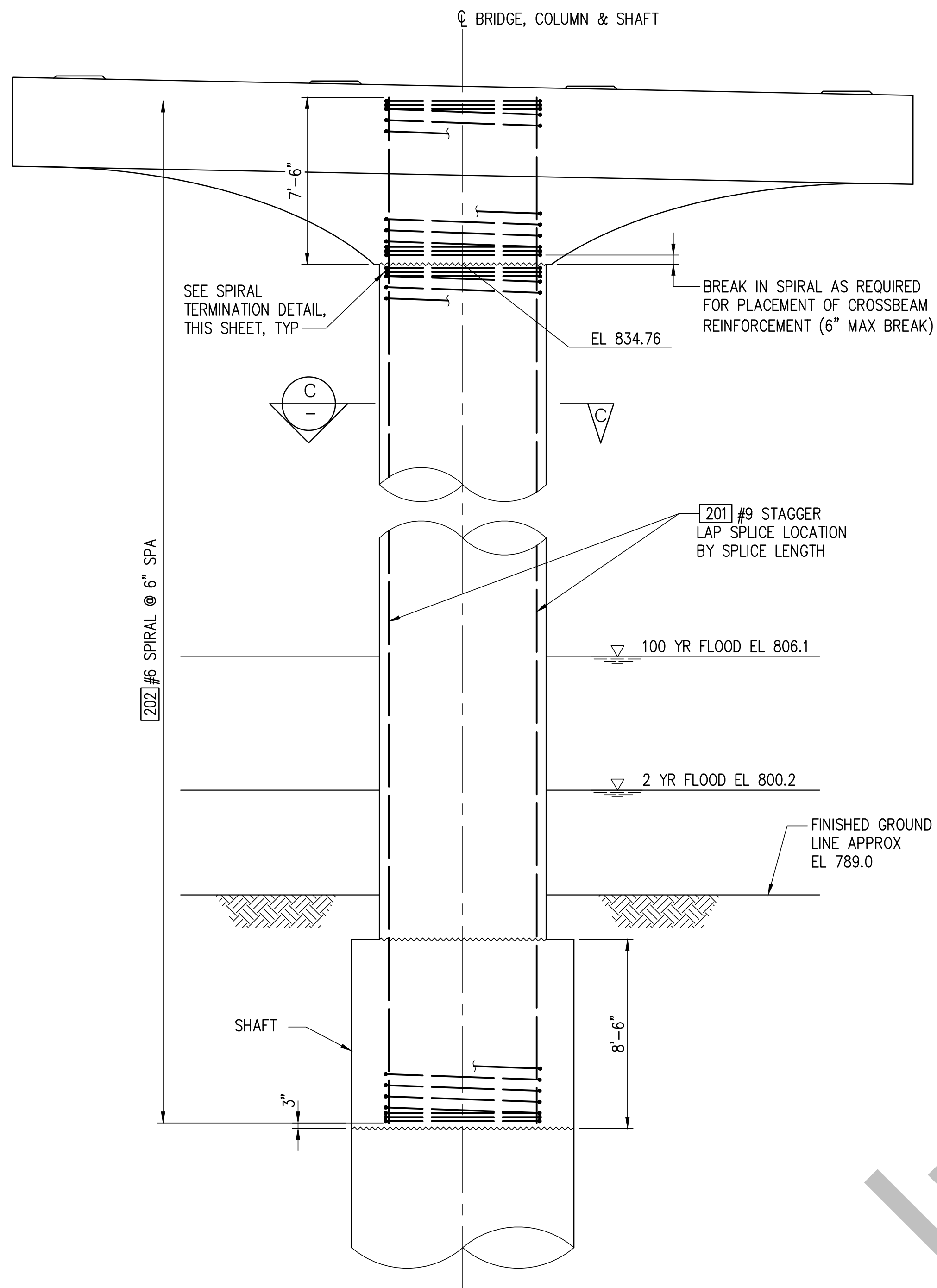

LOOKING AHEAD ON STATIONING
A PIER 2 ELEVATION
 SCALE: 1/4"=1'-0"

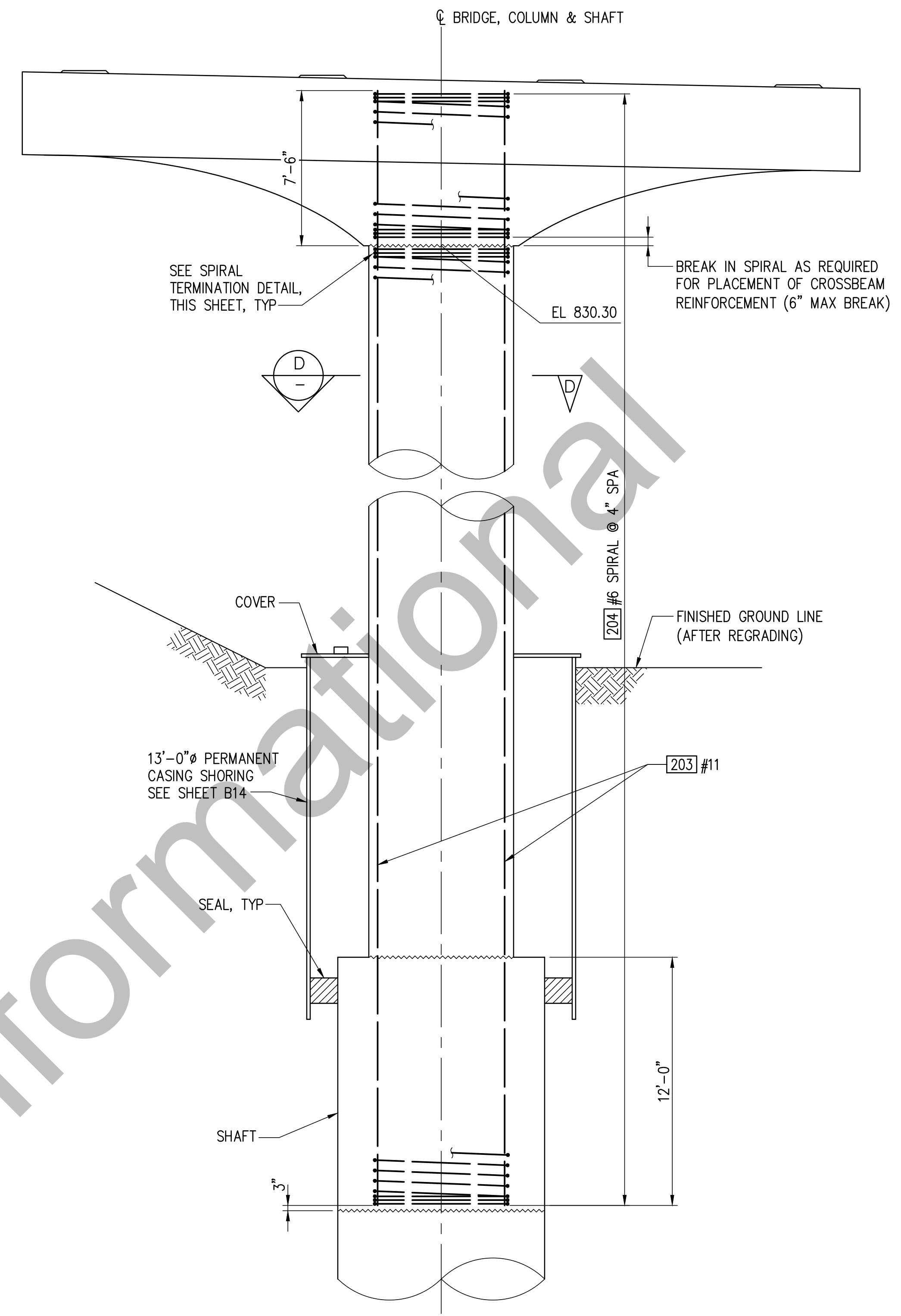

LOOKING AHEAD ON STATIONING
B PIER 3 ELEVATION
 SCALE: 1/4"=1'-0"

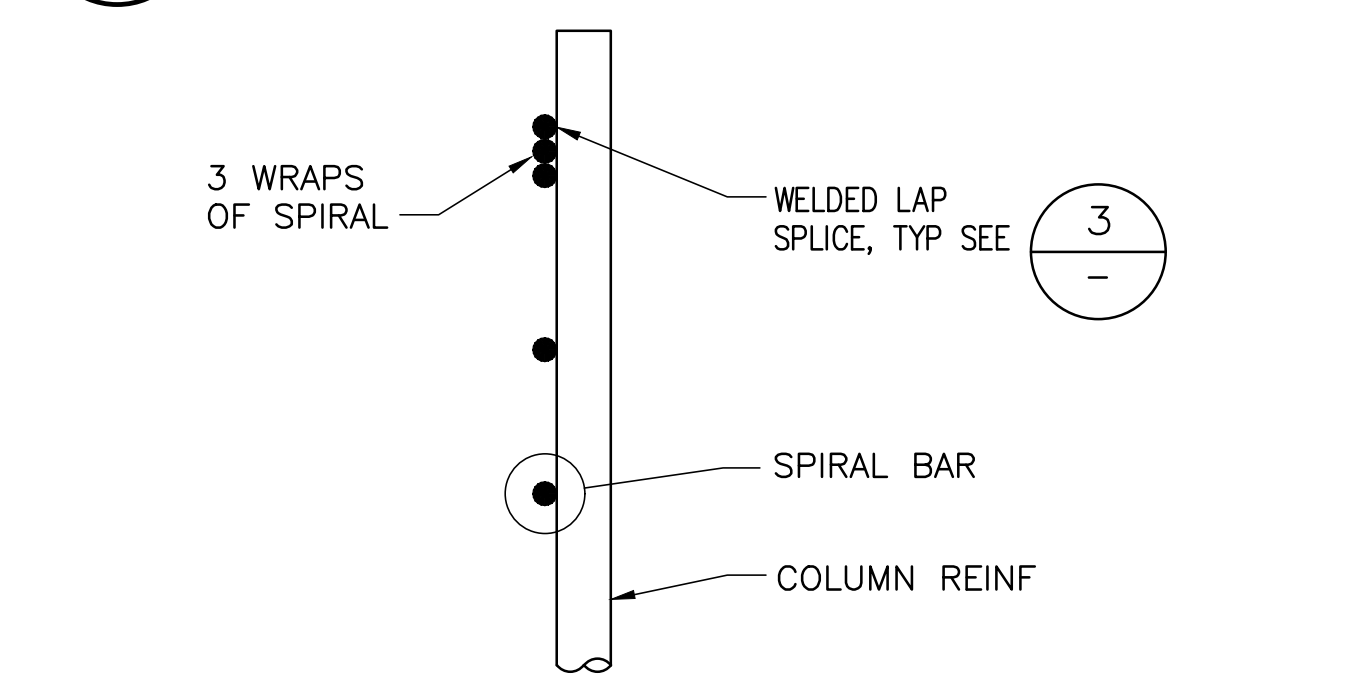
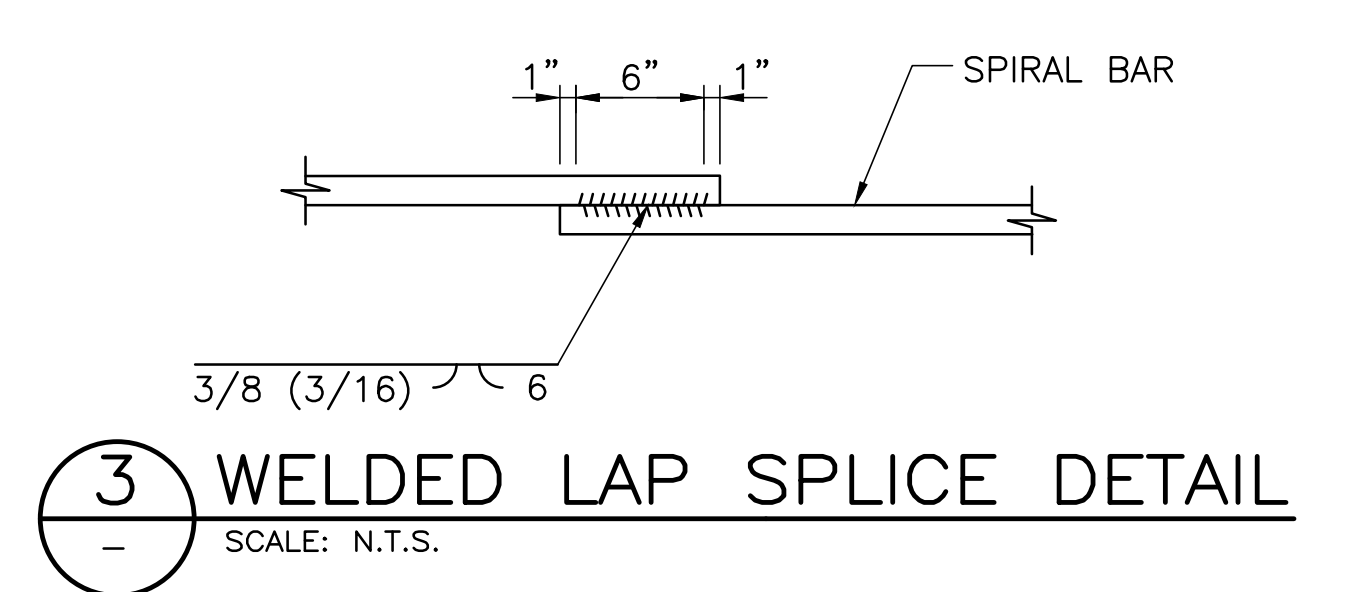
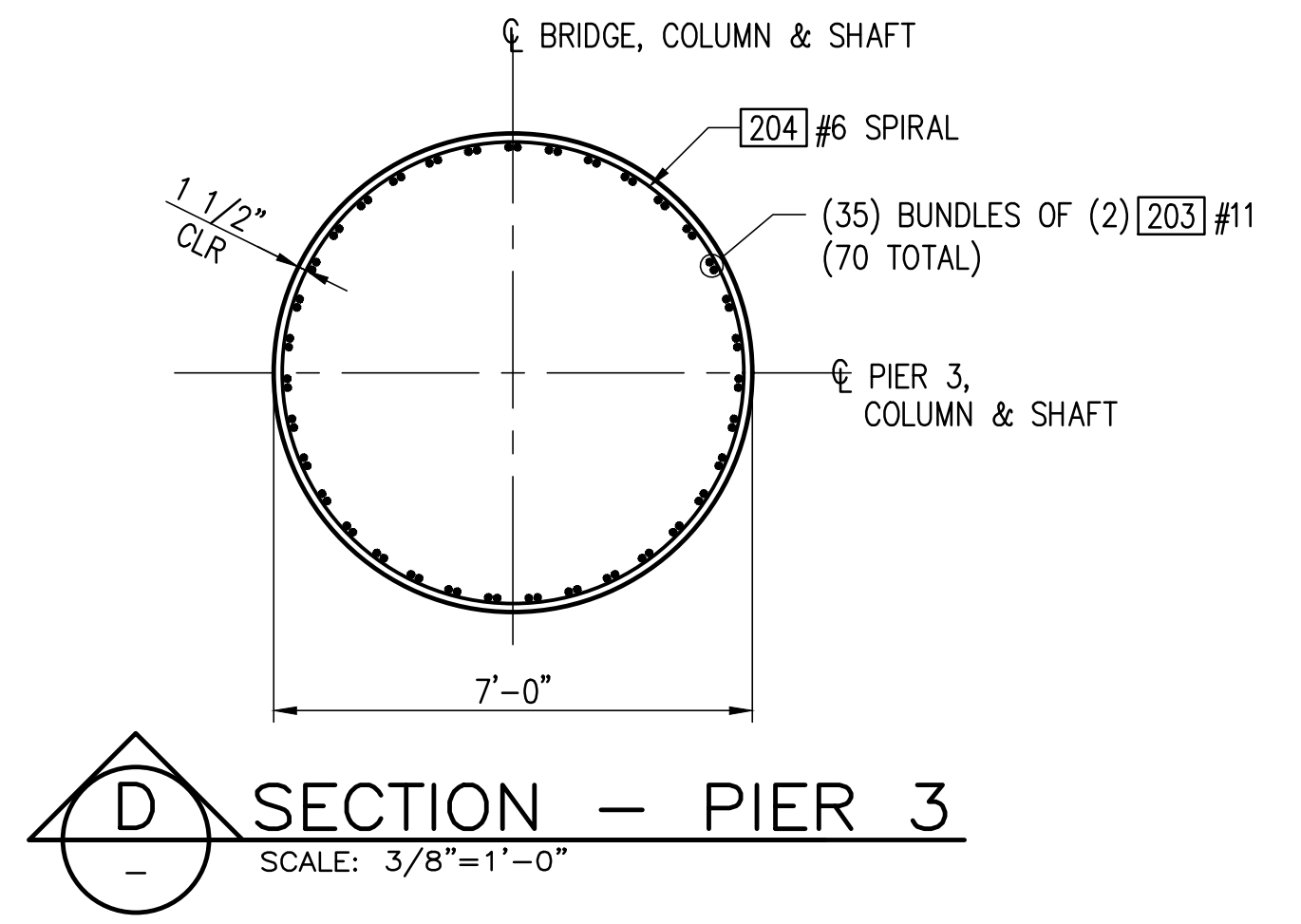
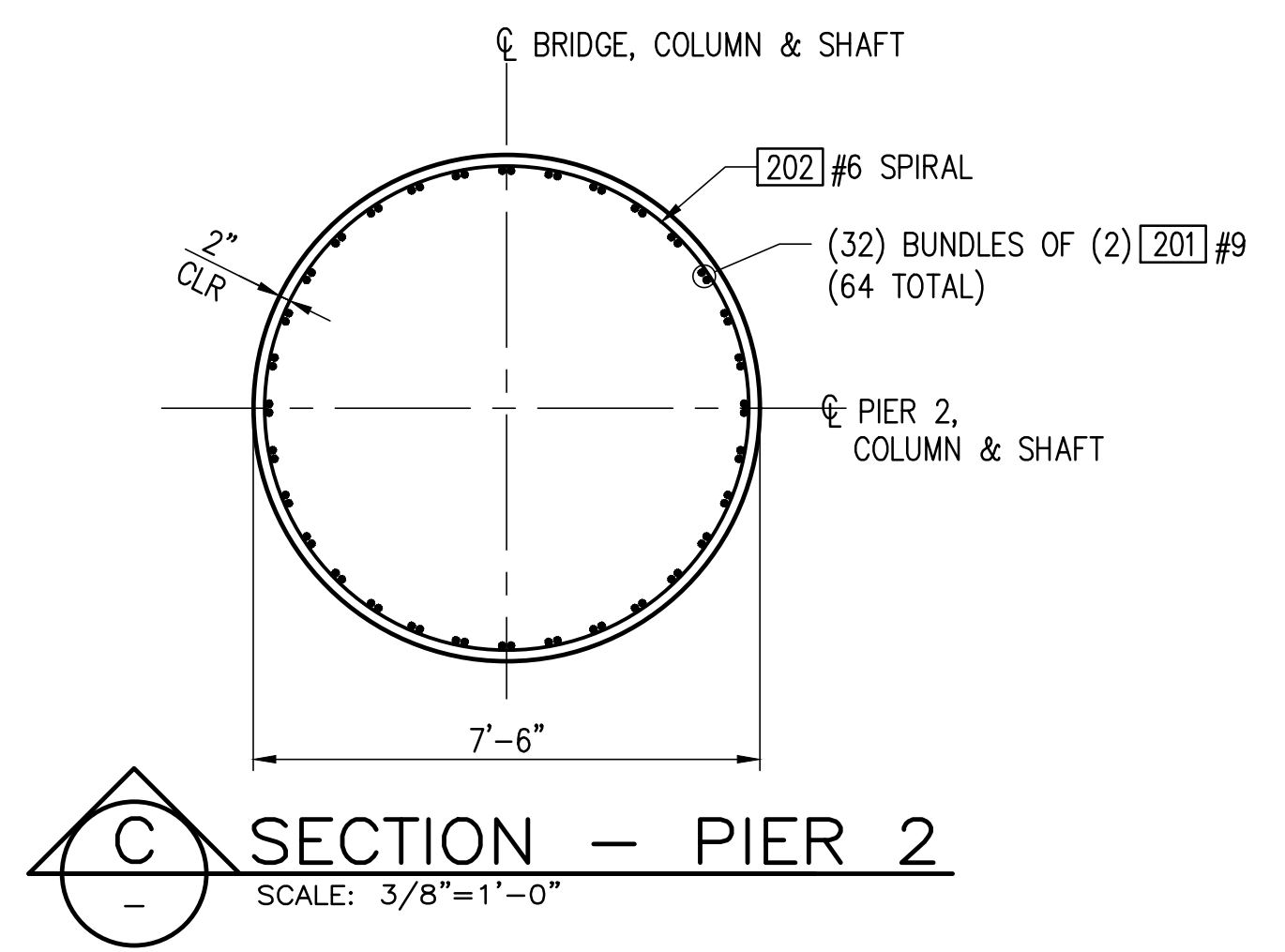

V:\160023 (W Cashmere Bridge)\Design\WCB-B13.dwg\TAB Layout1 modified by rubin on Oct 01, 2019 - 11:06

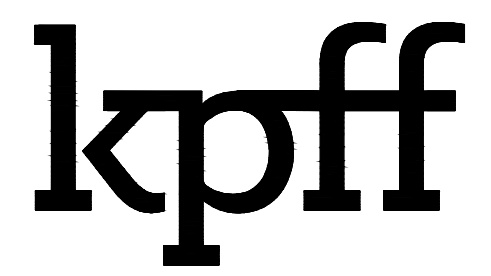
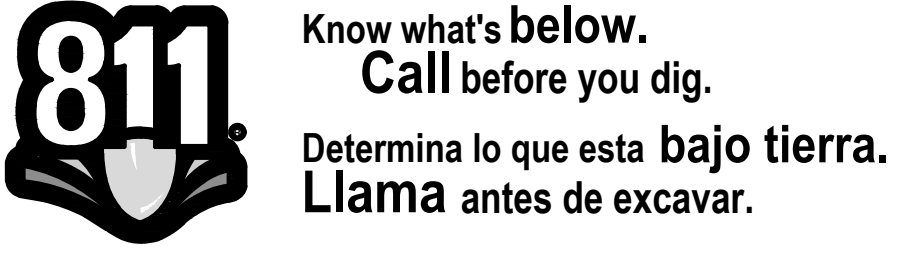

1601 5th Avenue
 Suite 1600
 Seattle, WA 98101
 206.622.5822
 www.kpff.com

DATE:	ISSUED / REVISED	BY:

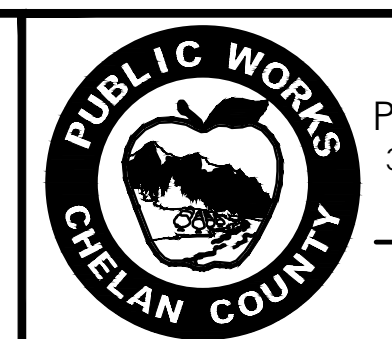
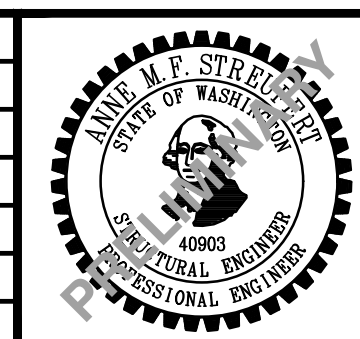

Chelan County
 Public Works Department
 316 Washington Street, Suite 402
 Wenatchee, Washington, 98801
 Phone: 509.667.6415
 Web Address: www.co.chelan.wa.us

WEST CASHMERE BRIDGE REPLACEMENT PROJECT
PIER 2 & 3 COLUMNS

PROJECT NUMBER
CRP693
 SHEET
B13
 PAGE
 97 OF 155

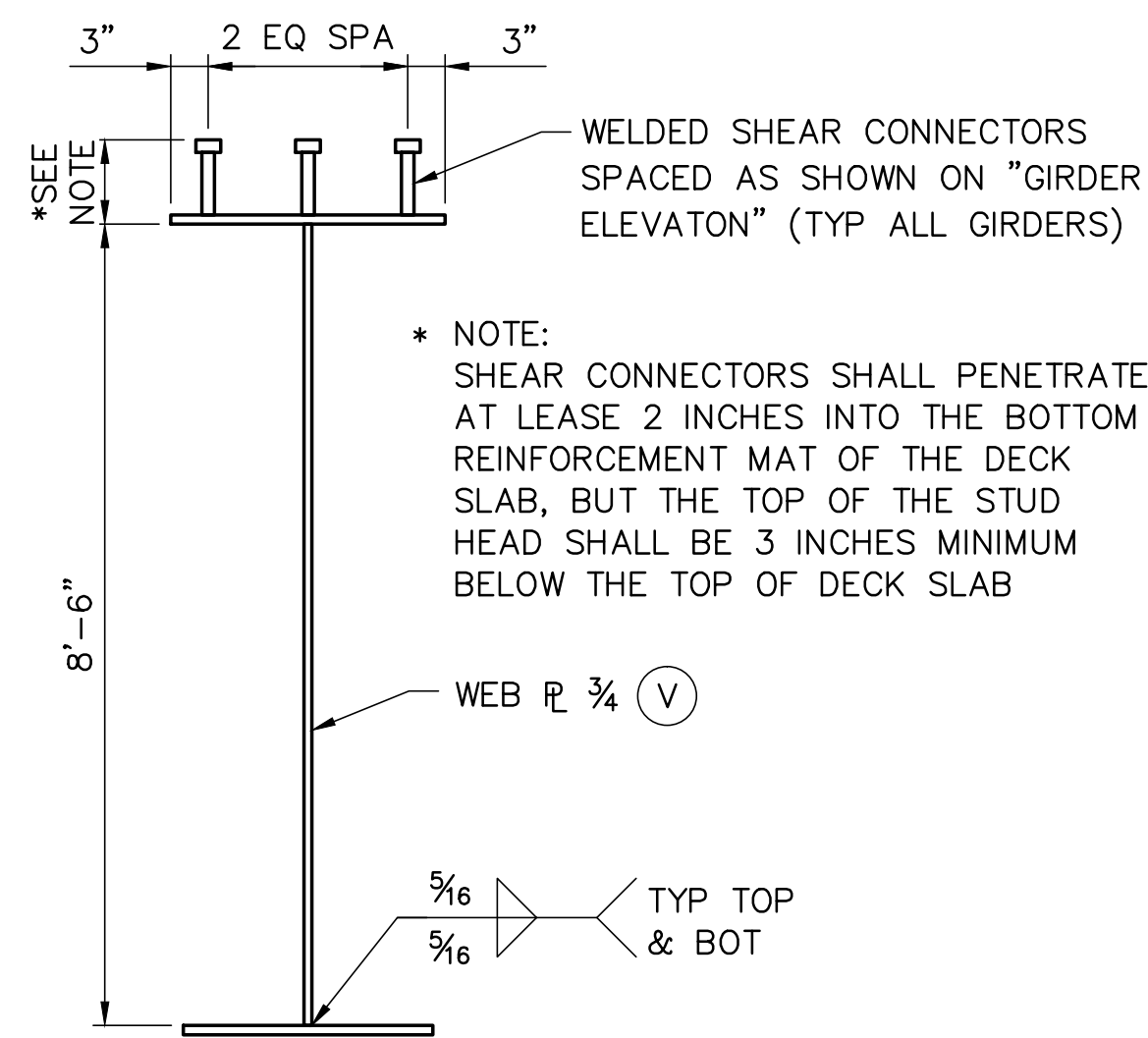

TYPICAL GIRDER SECTION

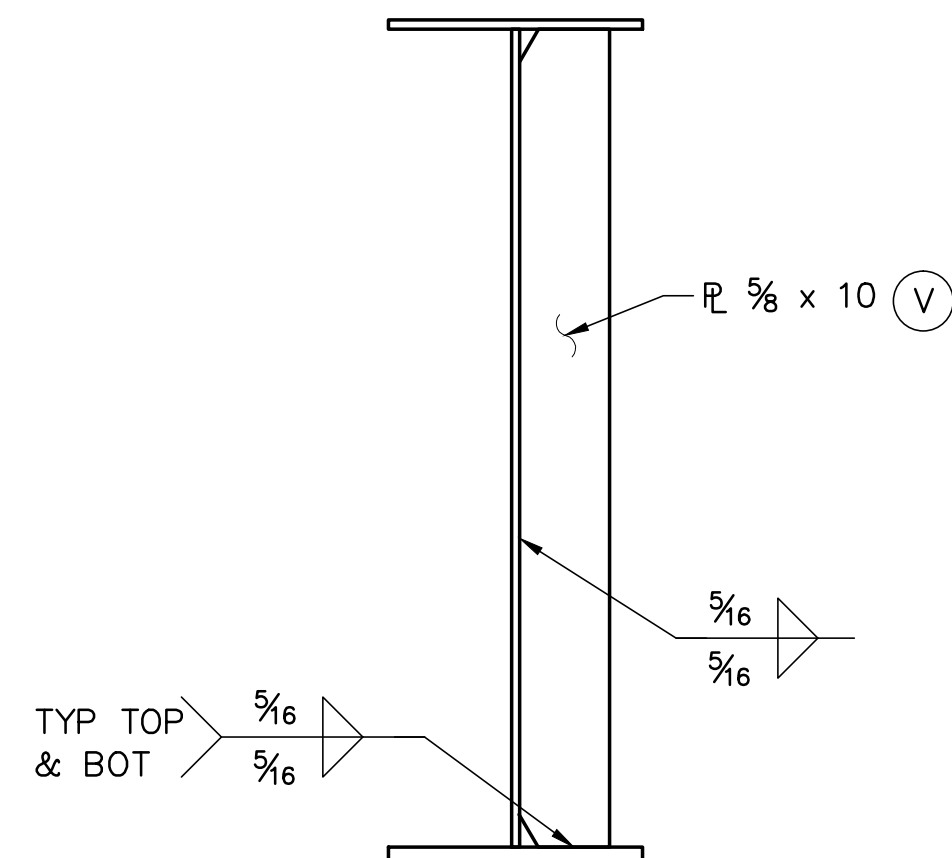

TYPICAL STIFFENER BETWEEN CROSSFRAMES

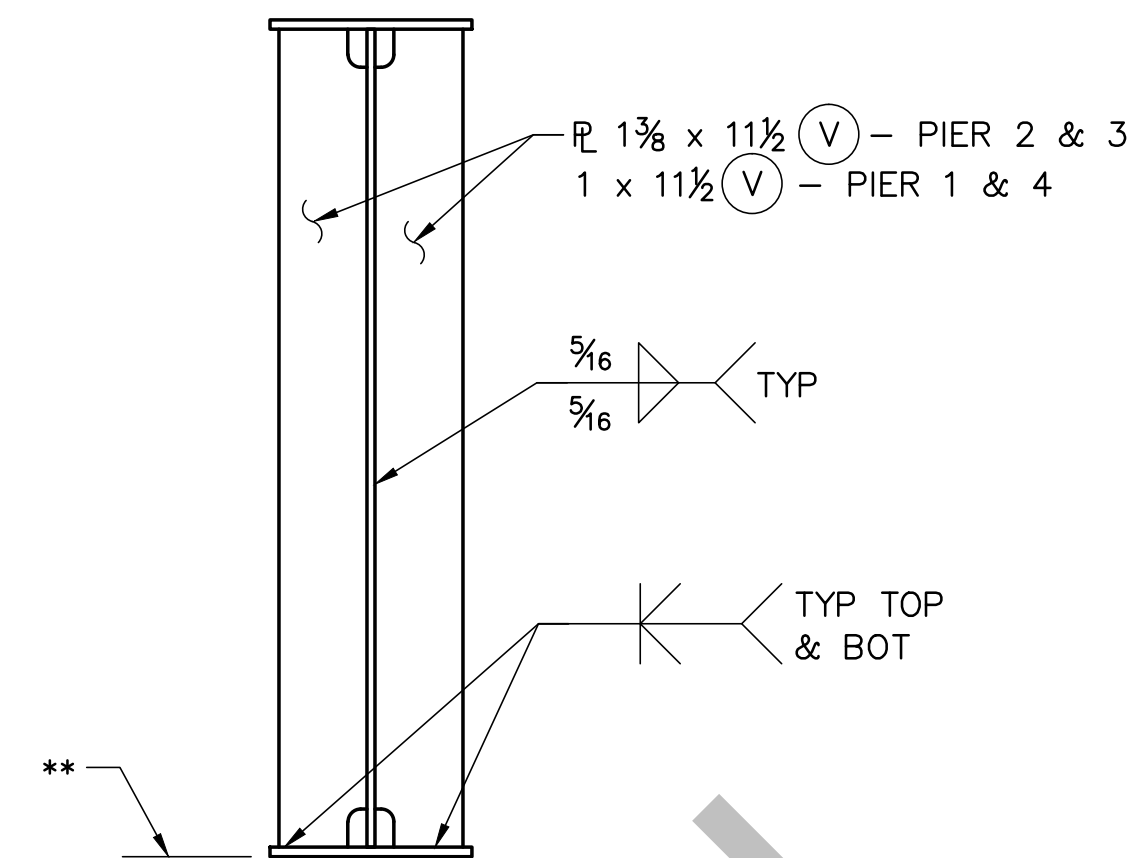

BEARING AND JACKING STIFFENERS

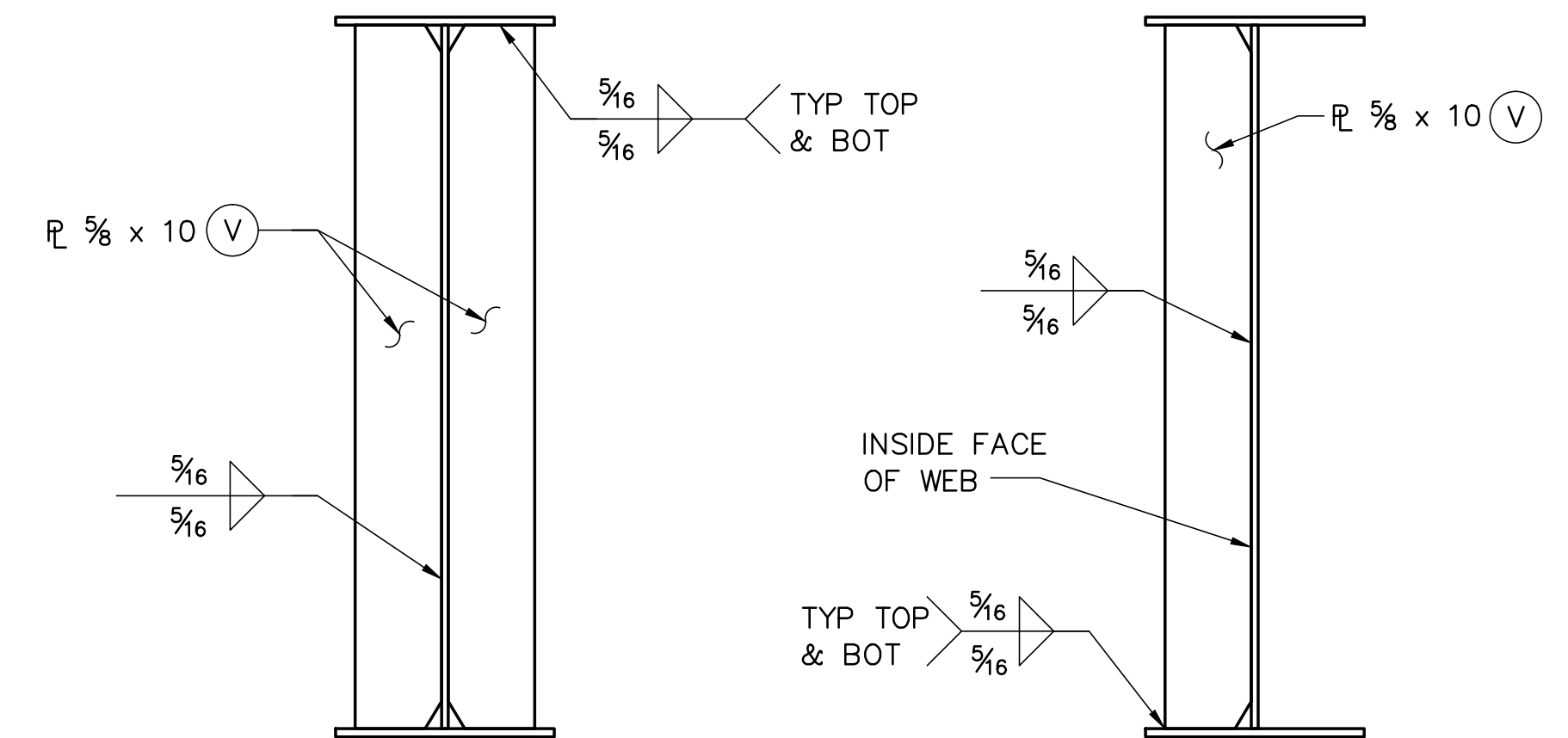

INTERIOR GIRDERS
TYPICAL STIFFENER AT INTERMEDIATE CROSSFRAME
EXTERIOR GIRDERS

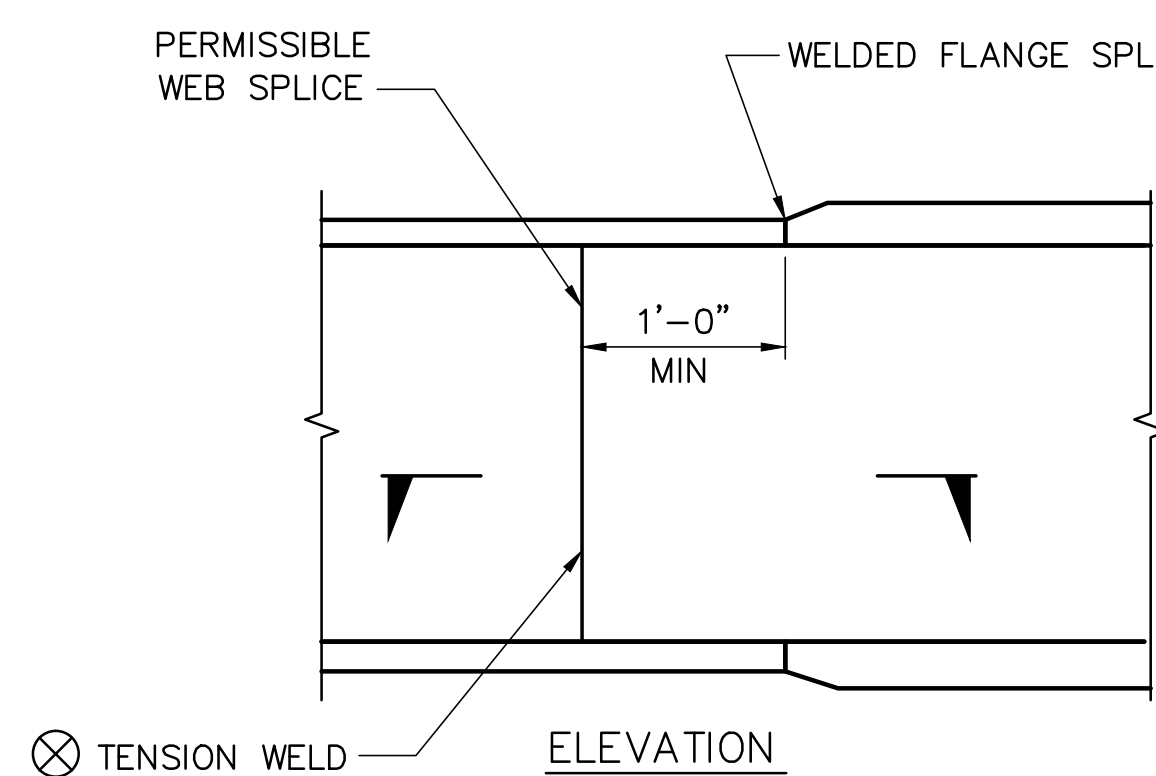

PERMISSIBLE WEB SPLICE

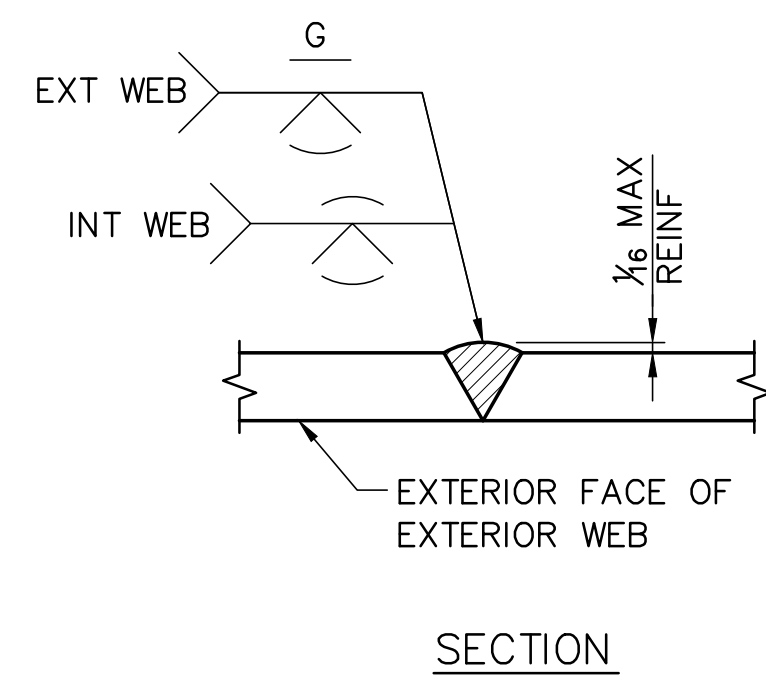

⊗ TENSION WELD

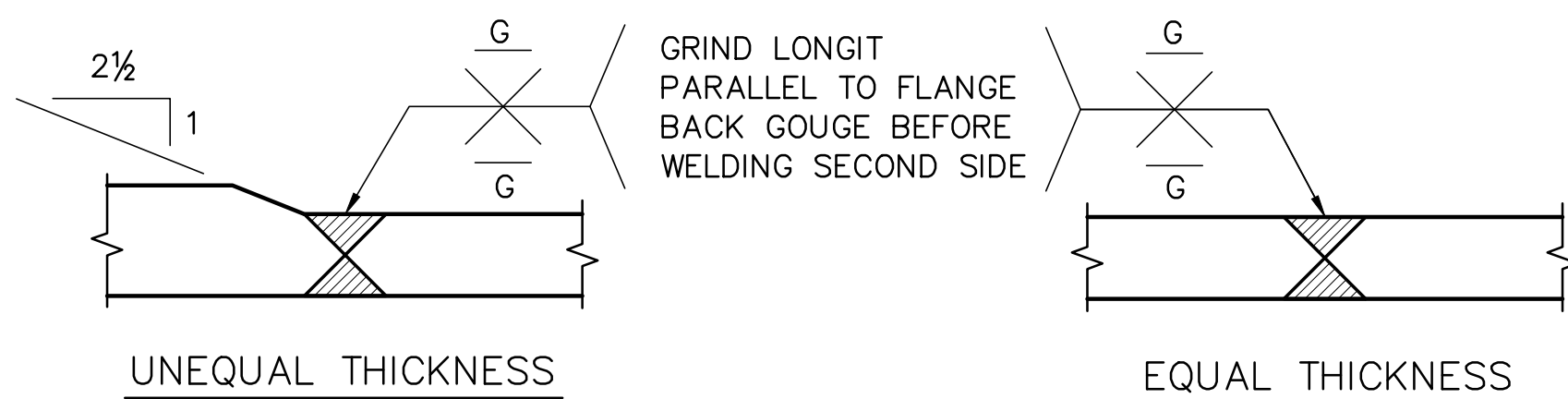

TENSION OR COMPRESSION FLANGE SPLICE

WELDED GIRDER SPLICE DETAILS

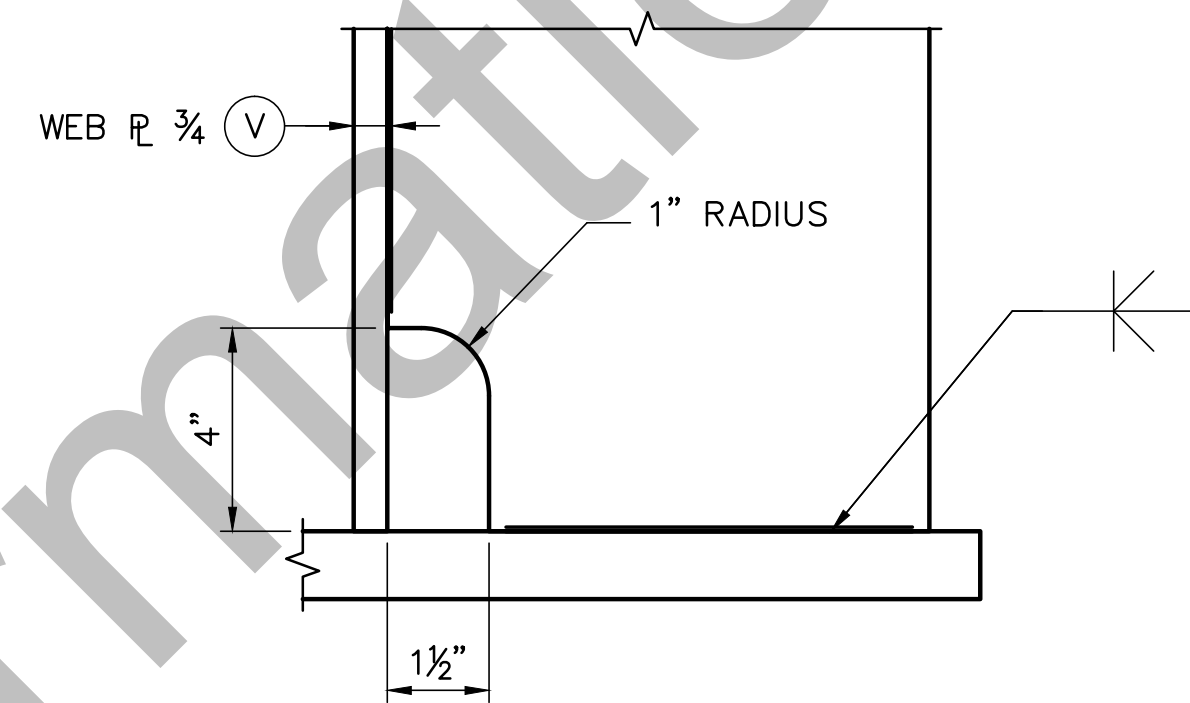

COPE DETAIL
FOR PJP OF CJP STIFFENER
TO FLANGE WELD

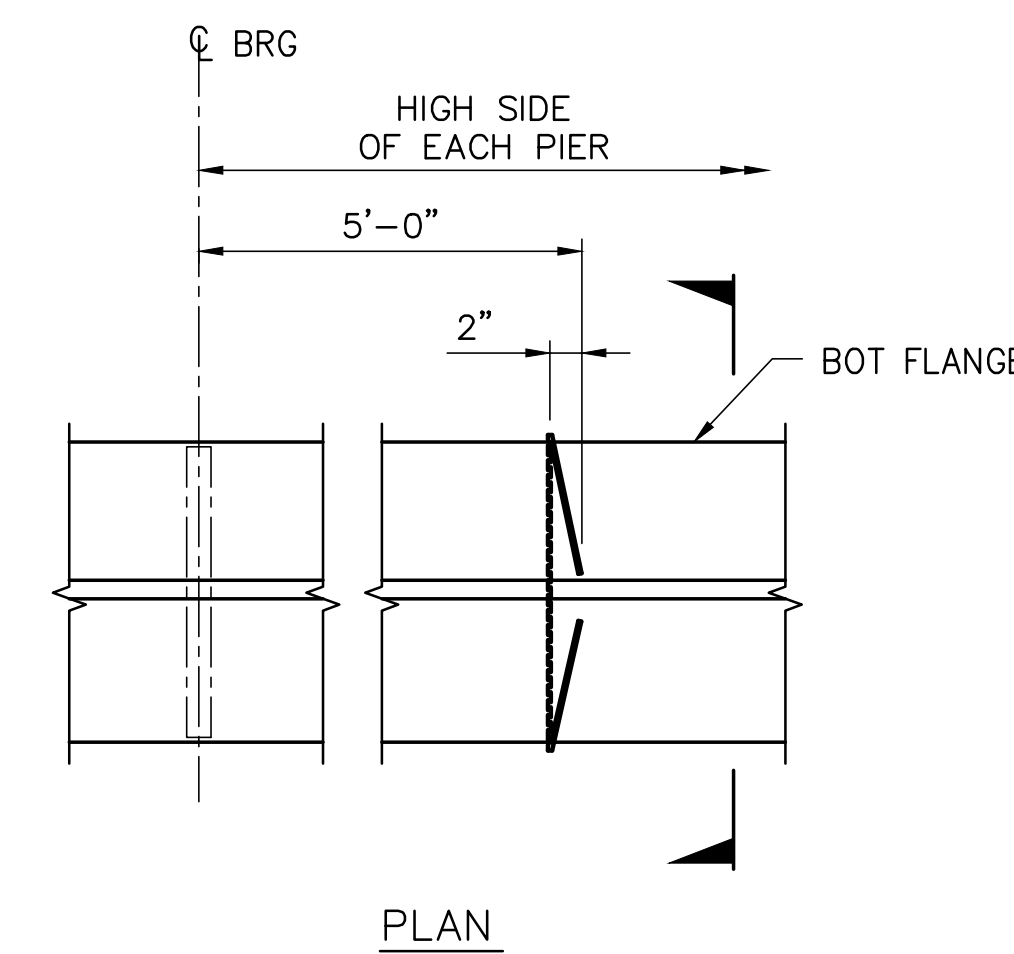

PLAN

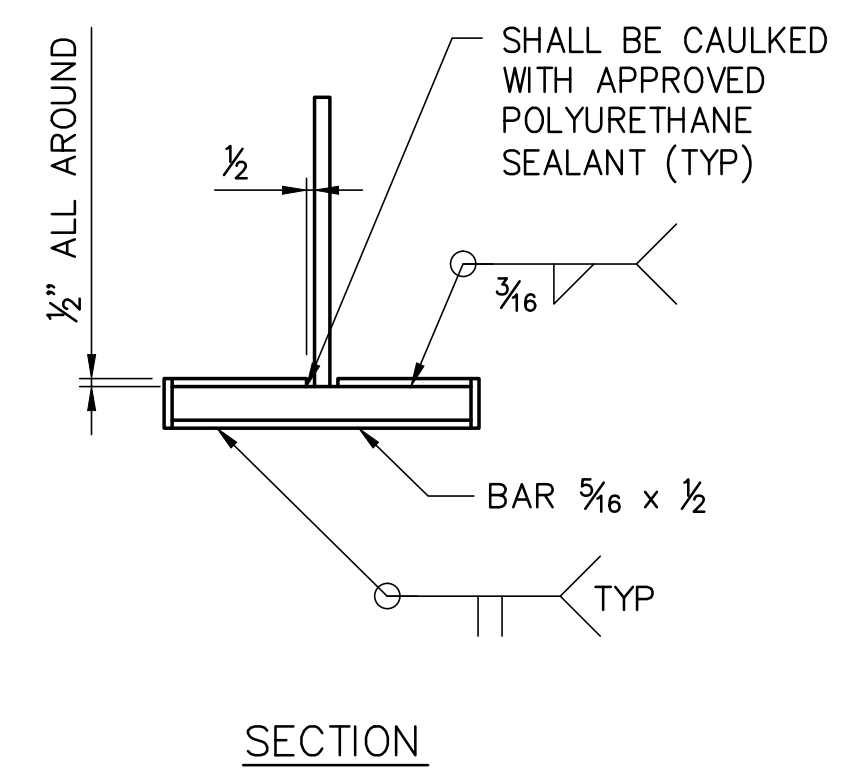

SECTION

DRIP PLATE DETAILS
EXTERIOR GIRDER

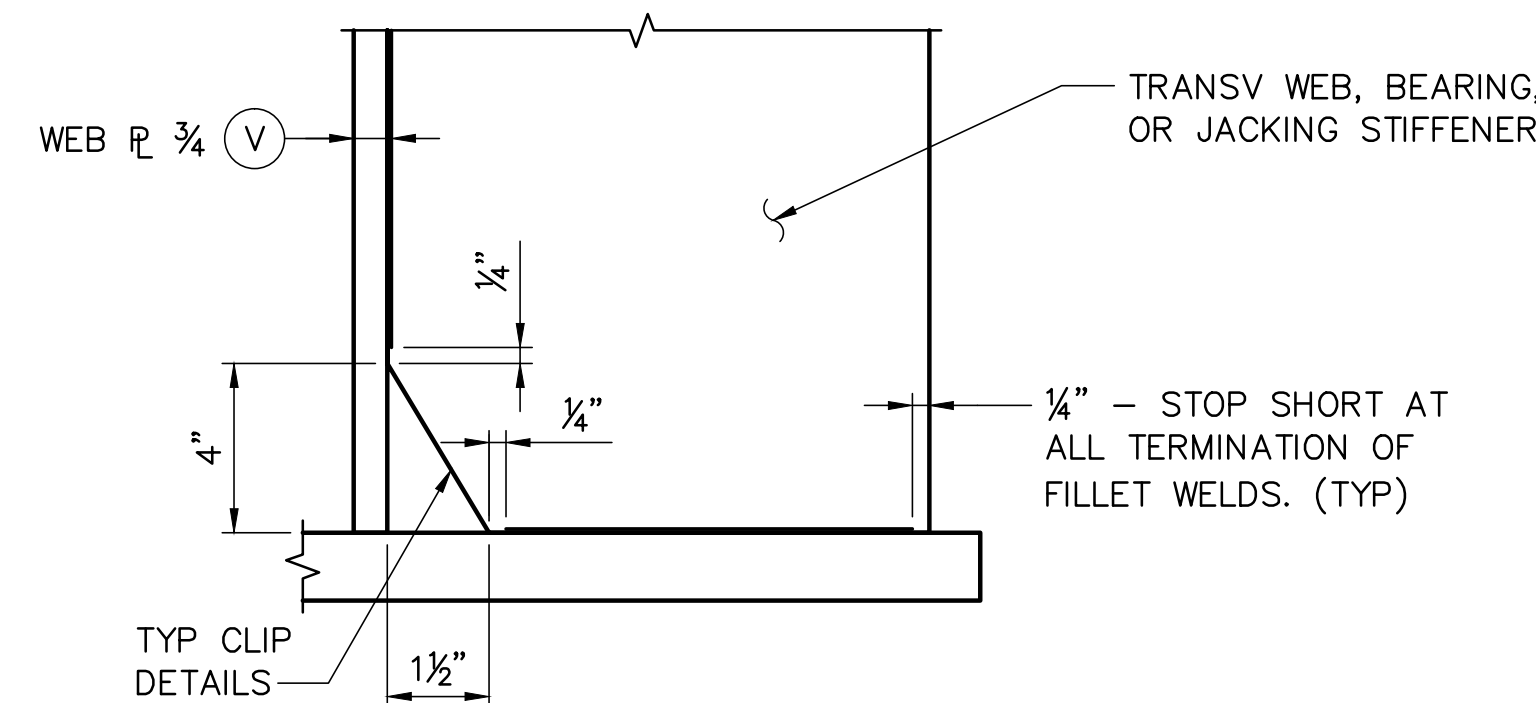

TYPICAL FILLET WELD TERMINATION DETAIL

P:\2016\2016001 - Chelan County - Doublin Bridge Replacement\100 - CAD\PS&E\SUBMITTALS\20160225\250225.dwg (R25) modified by cjsen on Oct 08, 2019 - 11:55



BELLEVUE OFFICE:
365 - 118th AVE. SE, STE 100
BELLEVUE, WA 98005
WWW.TRANTECHENG.COM
PH: 425-453-5545
FAX: 425-453-6779

DATE:	ISSUED / REVISED	BY:

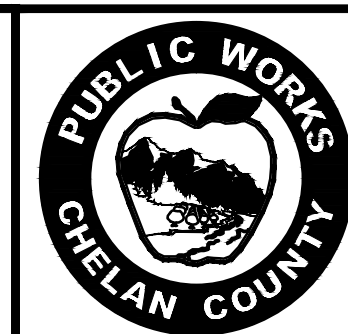
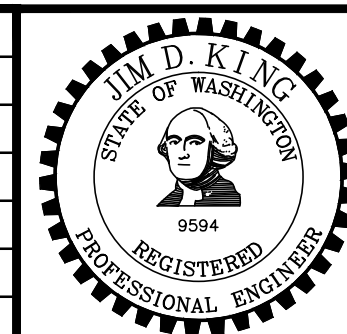

Chelan County
Public Works Department
316 Washington Street, Suite 402
Wenatchee, Washington, 98801
Phone: 509. 667. 6415
Web Address: www.co.chelan.wa.us

WEST CASHMERE BRIDGE REPLACEMENT PROJECT
GIRDER DETAILS

PROJECT NUMBER
CRP693
SHEET
B25
PAGE
109 OF 155

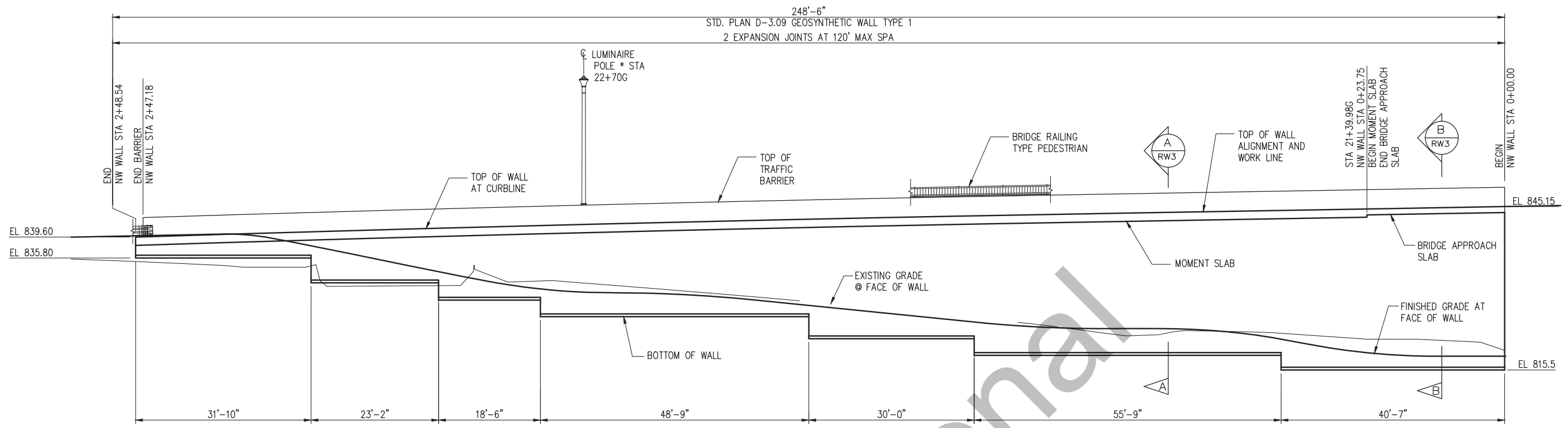

NW WALL DEVELOPED ELEVATION
SCALE: 1"=10'

* FOR LUMINAIRE ANCHORAGE DETAILS SEE SHEET B42.

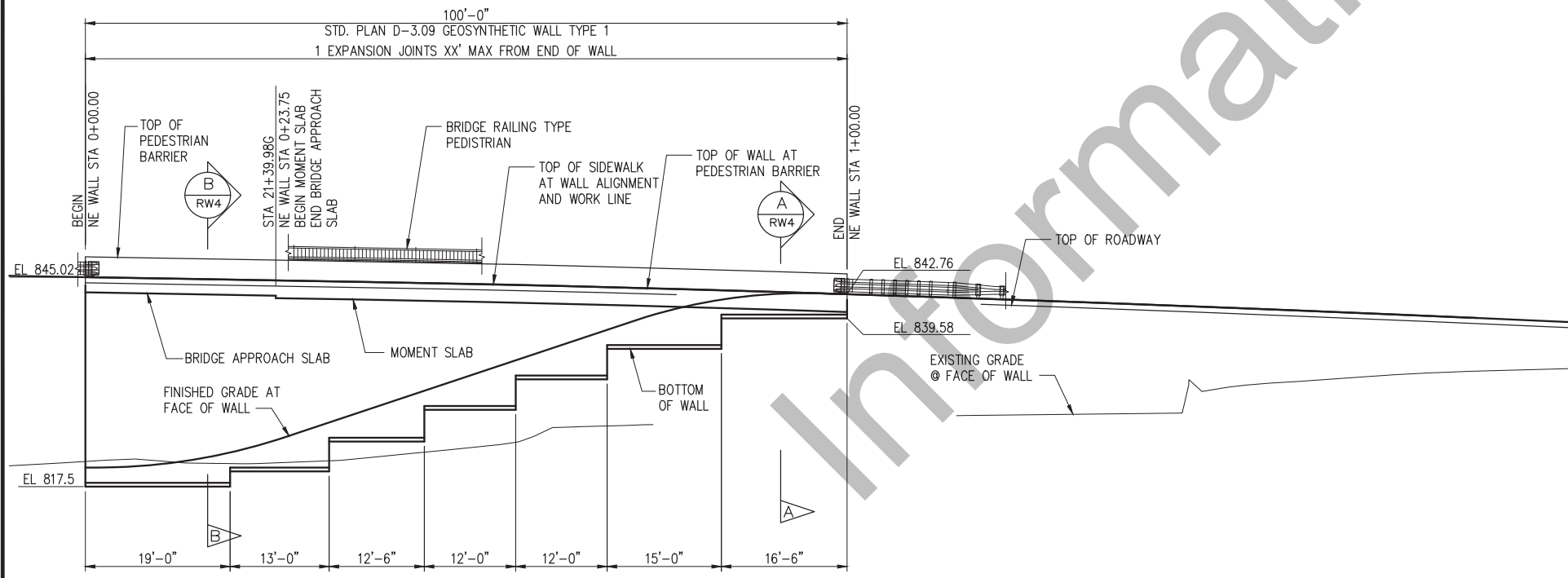

NE WALL DEVELOPED ELEVATION
SCALE: 1"=10'

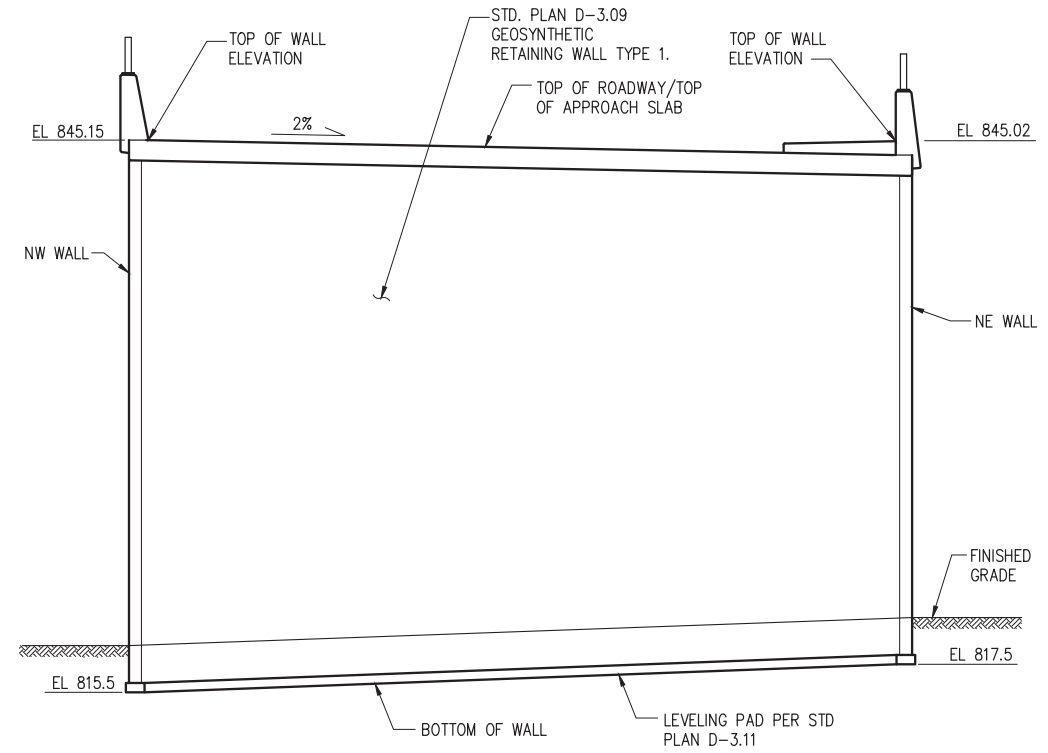

GEOSYNTHETIC RETAINING WALL
PIER 4 ELEVATION
SCALE: 1"=5'
LOOKING AHEAD ON STATIONING

811 Know what's below.
Call before you dig.
Determina lo que esta bajo tierra.
Llama antes de excavar.



1601 5th Avenue
Suite 1600
Seattle, WA 98101
206.622.5822
www.kpff.com

DATE:	ISSUED / REVISED	BY:

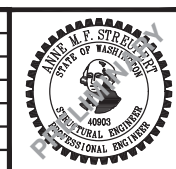

PUBLIC WORKS
CHELAN COUNTY
Chelan County
Public Works Department
316 Washington Street, Suite 402
Wenatchee, Washington, 98801
Phone: 509.667.6415
Web Address: www.co.chelan.wa.us

WEST CASHMERE BRIDGE REPLACEMENT PROJECT
WALL ELEVATIONS - NORTH APPROACH

PROJECT NUMBER
CRP693
SHEET
RW2
PAGE
142 OF 155

V:\160023 (W Cashmere Bridge)\Design\WCB-RW2.dwg [TAB:Layout1] modified by rubin on Oct 06, 2019 - 9:12

V:\160023 (W Cashmere Bridge)\Design\WCB-RW03.dwg (TAB:Layout) modified by rubin on Oct 09, 2019 - 8:45

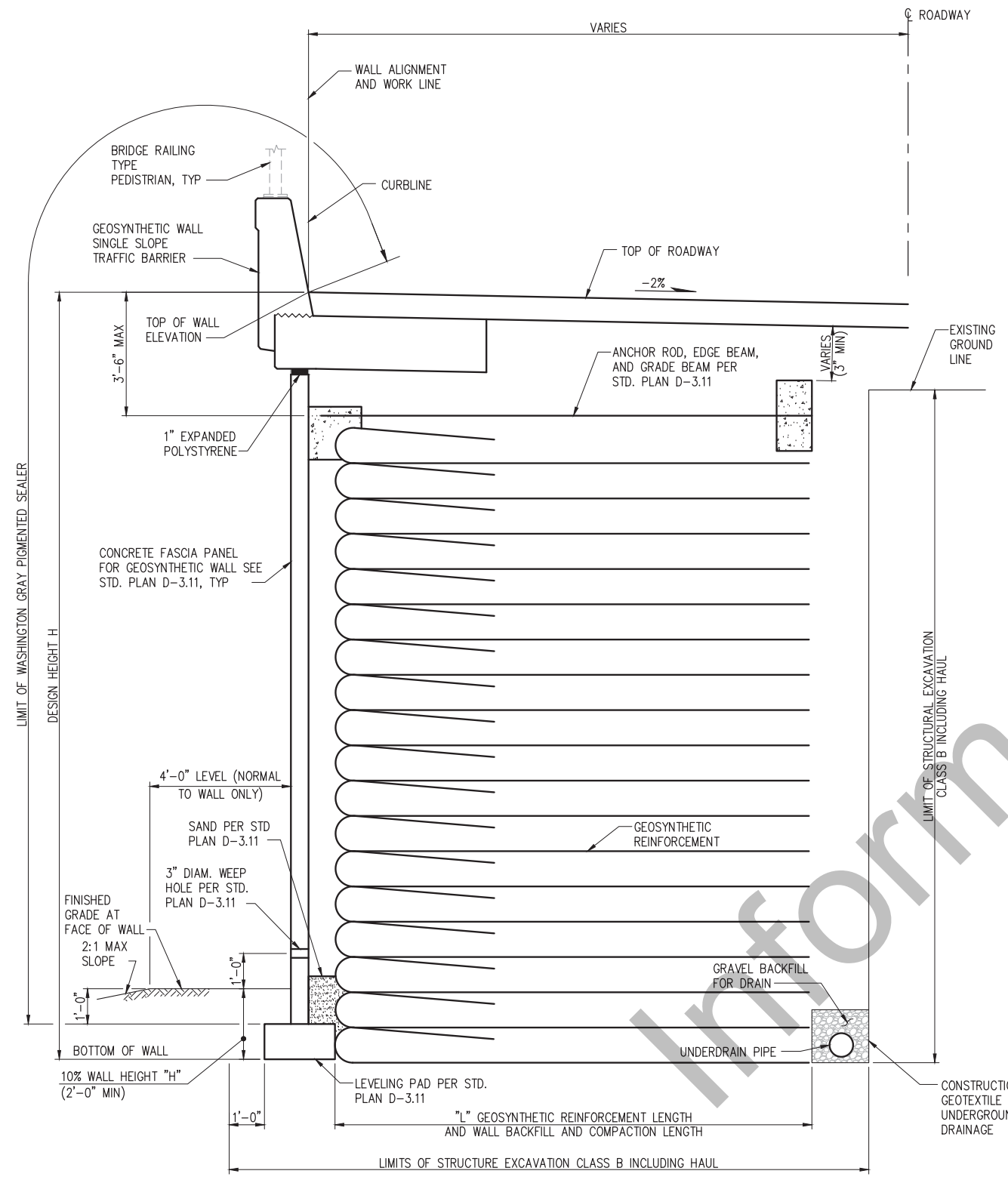

A
RW2
TYPICAL SECTION - WALL AND BARRIER
BEYOND BRIDGE APPROACH SLAB LIMITS
SCALE: 1/2"=1'-0"

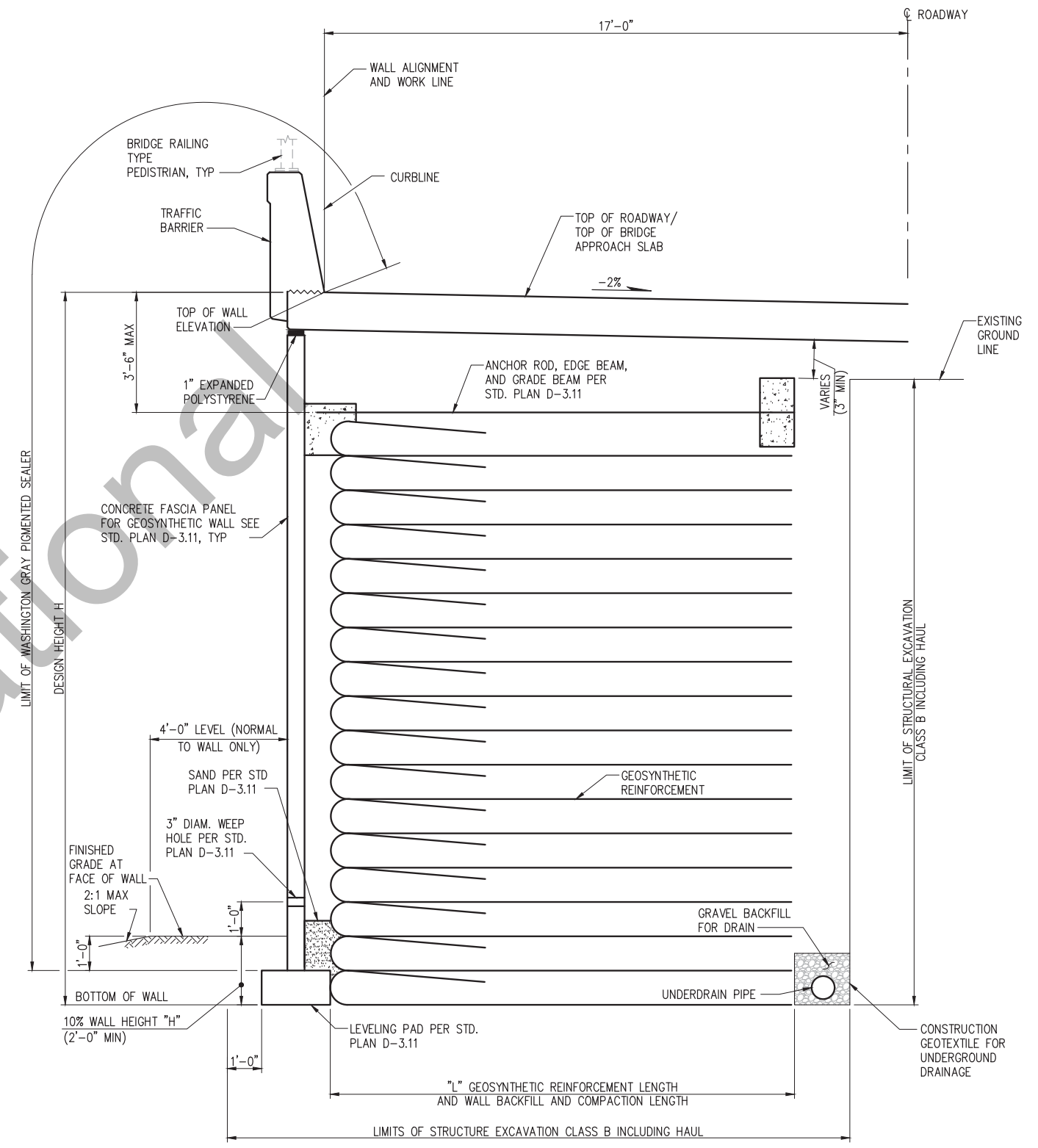

B
RW2
TYPICAL SECTION - WALL AND BARRIER
WITHIN BRIDGE APPROACH SLAB LIMITS
SCALE: 1/2"=1'-0"

NOTES:
1. GEOSYNTHETIC RETAINING WALLS SHALL BE INSTALLED PRIOR TO THE PIER 1 AND PIER 4 SHAFTS.

811
Know what's below.
Call before you dig.
Determina lo que esta bajo tierra.
Llama antes de excavar.



1601 5th Avenue
Suite 1600
Seattle, WA 98101
206.622.5822
www.kpff.com

DATE:	ISSUED / REVISED	BY:

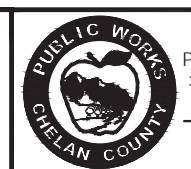
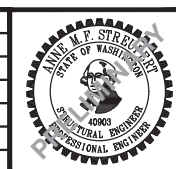

Chelan County
Public Works Department
316 Washington Street, Suite 402
Wenatchee, Washington, 98801
Phone: 509.667.6415
Web Address: www.co.chelan.wa.us

WEST CASHMERE BRIDGE REPLACEMENT PROJECT
RETAINING WALL DETAILS 1 - NORTH APPROACH

PROJECT NUMBER
CRP693
SHEET
RW3
PAGE
143 OF 155