



Chelan County Public Works Department

316 Washington Street, Suite 402
Wenatchee, Washington

March 26, 2024
Addendum No. 1
Page 1 of 2

Attention: All bidders and planholders

RE: CRP 747 – Bridge Deck and Joint Rehabilitation Bundle

You are hereby notified of the following changes to the Proposal, Special Provisions, Plans and other documents comprising the contract documents for the above referenced project.

The Bid Opening will remain April 2, 2024 at 9:30:00 A.M. Pacific Time.

PROPOSAL FORMS

1. **Delete Page 4 through Page 8 of the Proposal Documents. Insert revised Page 4 through Page 8 of Proposal Documents.** Note: Changes to the proposal are shaded in grey.

SPECIAL PROVISIONS

2. On page SP-21 on line 22, insert the attached Air Quality specification.
3. On page SP-62 on line 43, insert the attached Removal of Structures and Obstructions specification.
4. Insert the attached Appendix C after the last page of Appendix B.

CONTRACT PLANS

5. Remove Plan Sheet S02 (3 of 29). Insert the attached revised Plan Sheet S02 (3 of 29).
6. Remove Plan Sheet S11 (12 of 29). Insert the attached revised Plan Sheet S11 (12 of 29).
7. Remove Plan Sheet C02 (15 of 29). Insert the attached revised Plan Sheet C02 (15 of 29).
8. Remove Plan Sheet C04 (17 of 29). Insert the attached revised Plan Sheet C04 (17 of 29).

9. Remove Plan Sheets C09 (22 of 29) through C13 (26 of 29). Insert the attached revised Plan Sheets C09 (22 of 29) through C13 (26 of 29).

All bidders will be required to furnish the Board of Chelan County Commissioners with evidence of the receipt of this addendum by noting on the proposal sheet.

Addendum Number 1 is hereby incorporated in and made part of the contract documents, and its terms and conditions are fully binding on the plan holder and contractor when awarded and when formally executed.

Chelan County Public Works



Josh Patrick, P.E.
Assistant Public Works Director

Attachments:

- Proposal Forms Pages 4-8 (5 pages total)
- Air Quality specification (1 page total)
- Removal of Structures and Obstructions specification (1 page total)
- Appendix C (2 pages total)
- Revised Plan Sheet S02 (1 plan sheet total)
- Revised Plan Sheet S11 (1 plan sheet total)
- Revised Plan Sheet C02 (1 plan sheet total)
- Revised Plan Sheet C04 (1 plan sheet total)
- Revised Plan Sheets C09 through C13 (5 plan sheets total)

BID PROPOSAL

BRIDGE DECK AND JOINT REHABILITATION BUNDLE CRP 747

To: Board of Chelan County Commissioners
400 Douglas Street, Wenatchee, Washington 98801

The undersigned certify that they have examined the location of the Bridge Deck and Joint Rehabilitation Bundle, County Road Project No. 747 (CRP 747) and read and thoroughly understand the plans, specifications and contract governing the work embraced in this improvement or as much thereof as can be completed with the money available, in accordance with the said plans, specifications, contract and the following schedule:

NOTE: Unit prices for all items, all extensions, and total amount of bid, shall be shown.

ITEM NO.	QTY.	UNIT	CONTRACT ITEMS	UNIT PRICE Dollars	AMOUNT Dollars
SCHEDULE A – PESHASTIN BRIDGE No. 411A					
1	1.00	L.S.	MOBILIZATION		
2	80.00	L.F.	REMOVING PAINT LINE		
3	1328.00	C.F.	MODIFIED CONC. OVERLAY		
4	1180.00	S.Y.	FINISHING AND CURING MODIFIED CONC. OVERLAY		
5	160.00	L.F.	EXPANSION JOINT MODIFICATION – COMPRESSION SEAL		
6	240.00	L.F.	EXPANSION JOINT MODIFICATION – RAPID CURE SILICONE SEALANT		
7	1180.00	S.Y.	SCARIFYING CONC. SURFACE		
8	480.00	S.F.	FURTHER DECK PREPARATION FOR TYPE 2 DECK REPAIR		
9	57.00	TON	HMA CL. 3/8 IN. PG 64H-28		
10	94.00	S.Y.	PAVEMENT REPAIR EXCAVATION INCL. HAUL		
11	99.00	L.F.	HMA SAWCUT AND SEAL		
12	1.00	DAY	ESC LEAD		
13	5000.00	EST	EROSION/WATER POLLUTION CONTROL	\$1.00	\$5,000.00
14	20.00	L.F.	REMOVING AND RESETTING EXISTING PERMANENT BARRIER		
15	1620.00	L.F.	PAINT LINE		
16	1.00	L.S.	PROJECT TEMPORARY TRAFFIC CONTROL		
17	1296.00	HR	PORTABLE CHANGEABLE MESSAGE SIGN		
18	1.00	L.S.	SURVEYING FOR MODIFIED CONC. OVERLAY		

ITEM NO.	QTY.	UNIT	CONTRACT ITEMS	UNIT PRICE Dollars	AMOUNT Dollars
19	500.00	EST	ROADSIDE CLEANUP	\$1.00	\$500.00
20	1.00	L.S.	SPCC PLAN		
SCHEDULE A TOTAL: \$ _____					

ITEM NO.	QTY.	UNIT	CONTRACT ITEMS	UNIT PRICE Dollars	AMOUNT Dollars
SCHEDULE B – NEW GRIFFITH BRIDGE No. 503B					
21	1.00	L.S.	MOBILIZATION		
22	500.00	L.F.	REMOVING PAINT LINE		
23	98.00	L.F.	EXPANSION JOINT MODIFICATION – COMPRESSION SEAL		
24	33.00	TON	HMA CL. 3/8 IN. PG 64H-28		
25	54.00	S.Y.	PAVEMENT REPAIR EXCAVATION INCL. HAUL		
26	91.00	L.F.	HMA SAWCUT AND SEAL		
27	1.00	DAY	ESC LEAD		
28	5000.00	EST	EROSION/WATER POLLUTION CONTROL	\$1.00	\$5,000.00
29	2700.00	L.F.	PAINT LINE		
30	1.00	L.S.	PORTABLE TEMPORARY TRAFFIC CONTROL SIGNAL		
31	1.00	L.S.	PROJECT TEMPORARY TRAFFIC CONTROL		
32	1056.00	HR	PORTABLE CHANGEABLE MESSAGE SIGN		
33	500.00	EST	ROADSIDE CLEANUP	\$1.00	\$500.00
34	1.00	L.S.	SPCC PLAN		
77	1.00	L.S.	REMOVAL AND DISPOSAL OF ASBESTOS MATERIAL		
SCHEDULE B TOTAL: \$ _____					

ITEM NO.	QTY.	UNIT	CONTRACT ITEMS	UNIT PRICE Dollars	AMOUNT Dollars
SCHEDULE C – ARDENVOIR BRIDGE No. 505A					
35	1.00	L.S.	MOBILIZATION		
36	390.00	C.F.	MODIFIED CONC. OVERLAY		
37	347.00	S.Y.	FINISHING AND CURING MODIFIED CONC. OVERLAY		
38	37.00	L.F.	EXPANSION JOINT MODIFICATION – COMPRESSION SEAL		
39	52.00	L.F.	REMOVING STEEL ANGLE AND RECONSTRUCT CONCRETE EDGE		
40	347.00	S.Y.	SCARIFYING CONC. SURFACE		
41	380.00	S.F.	FURTHER DECK PREPARATION FOR TYPE 2 DECK REPAIR		
42	30.00	TON	HMA CL. 3/8 IN. PG 64H-28		
43	50.00	S.Y.	PAVEMENT REPAIR EXCAVATION INCL. HAUL		
44	52.00	L.F.	HMA SAWCUT AND SEAL		
45	1.00	DAY	ESC LEAD		
46	5000.00	EST	EROSION/WATER POLLUTION CONTROL	\$1.00	\$5,000.00
47	1.00	L.S.	PROJECT TEMPORARY TRAFFIC CONTROL		
48	1.00	L.S.	SURVEYING FOR MODIFIED CONC. OVERLAY		
49	500.00	EST	ROADSIDE CLEANUP	\$1.00	\$500.00
50	1.00	L.S.	SPCC PLAN		
SCHEDULE C TOTAL:				\$	_____

ITEM NO.	QTY.	UNIT	CONTRACT ITEMS	UNIT PRICE Dollars	AMOUNT Dollars
SCHEDULE D – CHELAN FALLS 2 BRIDGE No. 805A					
51	1.00	L.S.	MOBILIZATION		
52	500.00	L.F.	REMOVING PAINT LINE		
53	205.00	L.F.	EXPANSION JOINT MODIFICATION – COMPRESSION SEAL		
54	25.00	TON	HMA CL. 3/8 IN. PG 64H-28		
55	38.00	S.Y.	PAVEMENT REPAIR EXCAVATION INCL. HAUL		
56	65.00	L.F.	HMA SAWCUT AND SEAL		
57	1.00	DAY	ESC LEAD		
58	5000.00	EST	EROSION/WATER POLLUTION CONTROL	\$1.00	\$5,000.00
59	1440.00	L.F.	TEMPORARY BARRIER		
60	3500.00	L.F.	PAINT LINE		
61	1.00	L.S.	PORTABLE TEMPORARY TRAFFIC CONTROL SIGNAL		
62	1.00	L.S.	PROJECT TEMPORARY TRAFFIC CONTROL		
63	1056.00	HR	PORTABLE CHANGEABLE MESSAGE SIGN		
64	500.00	EST	ROADSIDE CLEANUP	\$1.00	\$500.00
65	1.00	L.S.	SPCC PLAN		
SCHEDULE D TOTAL:				\$ _____	

ITEM NO.	QTY.	UNIT	CONTRACT ITEMS	UNIT PRICE Dollars	AMOUNT Dollars
SCHEDULE E – STONE HILL BRIDGE No. 915					
66	1.00	L.S.	MOBILIZATION		
67	48.00	L.F.	EXPANSION JOINT MODIFICATION – RAPID CURE SILICONE SEALANT		
68	48.00	L.F.	REMOVE STEEL ANGLE AND RECONSTRUCT CONCRETE EDGE		
69	18.00	TON	HMA CL. 3/8 IN. PG 64H-28		
70	27.00	S.Y.	PAVEMENT REPAIR EXCAVATION INCL. HAUL		
71	48.00	L.F.	HMA SAWCUT AND SEAL		
72	1.00	DAY	ESC LEAD		
73	5000.00	EST	EROSION/WATER POLLUTION CONTROL	\$1.00	\$5,000.00
74	1.00	L.S.	PROJECT TEMPORARY TRAFFIC CONTROL		
75	500.00	EST	ROADSIDE CLEANUP	\$1.00	\$500.00
76	1.00	L.S.	SPCC PLAN		
SCHEDULE E TOTAL: \$				_____	

SCHEDULE A TOTAL: \$ _____

SCHEDULE B TOTAL: \$ _____

SCHEDULE C TOTAL: \$ _____

SCHEDULE D TOTAL: \$ _____

SCHEDULE E TOTAL: \$ _____

BID TOTAL (SUM SCHEDULE A THROUGH E): \$ _____

Air Quality

Asbestos Containing Material

Section 1-07.5(4)C is supplemented with the following:

(October 4, 2021)

Asbestos Good Faith Investigation

An asbestos Good Faith Investigation (GFI) has been conducted for this project and it has been determined that known Asbestos Containing Material (ACM), and/or Presumed Asbestos Containing Material (PACM), will be disturbed by the work on this project. The asbestos GFI has been provided in Appendix *** C ***.

Division 2 Earthwork

Removal of Structures and Obstructions

Description

Section 2-02.1 is supplemented with the following:

(October 4, 2021)

Removal and Disposal of Asbestos Material

This work shall consist of removing, handling, and disposing of Asbestos Containing Material and Presumed Asbestos Containing Material identified in the Good Faith Investigation (GFI). The Contractor shall remove and dispose of asbestos in any and all 6 areas as identified in the GFI.

Construction Requirements

Section 2-02.3 is supplemented with the following:

(October 4, 2021)

Removal and Disposal of Asbestos Material

Prior to performance of any contract work, the Contractor shall obtain all permits from and provide notification to, the Washington State Department of Labor and Industries, the Washington State Department of Ecology, the local clean air agency, and other permitting and regulatory agencies with jurisdiction over the work involving asbestos as the laws, rules, and regulations require.

Prior to commencing asbestos related work, the Contractor shall submit as a Type 1 Working Drawing any and all written verification of approvals and notifications that have been given and/or obtained from the required jurisdictional agencies. The Contractor shall include a schedule of activities for all work involving asbestos removal as part of the Type 1 Working Drawing. Asbestos related work shall also be shown on the Contractor's project progress schedule.

The Contractor shall designate a Washington State Certified Asbestos Supervisor (CAS), certified in accordance with WAC 295-65-012, to supervise the asbestos removal and to ensure that the handling and removal of asbestos is accomplished by certified asbestos workers, pursuant to Washington State Department of Labor and Industries standards. The Contractor shall ensure that the removal and disposal of asbestos meets the requirements of EPA regulation 40 CFR Part 61, local health department regulations, and all other applicable regulations.

The Contractor shall ensure the safety of all workers, visitors to the site, and the public in accordance with all applicable laws, rules, and regulations.

Payment

Section 2-02.5 is supplemented with the following:

(September 30, 1996)

"Removal and Disposal of Asbestos Material", lump sum.

APPENDIX C

Asbestos GFI

MEMO



Date: March 26, 2024
To: Shaun Honeycutt, Chelan County Public Works
From: Aaron Olson, PE
Subject: CRP 747 – Asbestos Presence New Griffith Bridge

Based on information contained within the as-built plans for the New Griffith Bridge (Bridge No. 503B), there is Asbestos Containing Material (ACM) present in the traffic barrier that is likely to be disturbed during construction activities associated with the project. This ACM shall be removed and disposed of in accordance with all requirements listed within Special Provisions.

ACM that may be present on other bridges on the project is not expected to be disturbed during construction activities.

SCHEDULE A - PESHASTIN BRIDGE NO. 411A

ITEM NO.	STD. ITEM NO.	SPECS REF.	DESCRIPTION	UNIT	QTY.
PREPARATION					
1	0001	1-09.7	MOBILIZATION	LS	1
2	0187	8-22	REMOVING PAINT LINE	LF	80
STRUCTURE					
3	4232	6-09	MODIFIED CONC. OVERLAY	CF	1328
4	4233	6-02	FINISHING AND CURING MODIFIED CONC. OVERLAY	SY	1180
5	4444	6-02	EXPANSION JOINT MODIFICATION - COMPRESSION SEAL	LF	160
6	4444	6-02	EXPANSION JOINT MODIFICATION - RAPID CURE SILICONE SEALANT	LF	240
7	4456	6-09	SCARIFYING CONC. SURFACE	SY	1180
8	4467	6-09	FURTHER DECK PREPARATION FOR TYPE 2 DECK REPAIR	SF	480
HOT MIX ASPHALT					
9	5766	5-04	HMA CL. 3/8 IN. PG 64H-28	TON	57
10	0332	5-04	PAVEMENT REPAIR EXCAVATION INCL. HAUL	SY	94
11	6511	5-03	HMA SAWCUT AND SEAL	LF	99
EROSION CONTROL AND ROADSIDE PLANTING					
12	6403	8-01	ESC LEAD	DAY	1
13	6490	8-01	EROSION/ WATER POLLUTION CONTROL	EST	1
TRAFFIC					
14	6784	6-10	REMOVING AND RESETTING EXISTING PERMANENT BARRIER	LF	20
15	6806	8-22	PAINT LINE	LF	1620
16	6971	1-10	PROJECT TEMPORARY TRAFFIC CONTROL	LS	1
17	6993	1-10	PORTABLE CHANGEABLE MESSAGE SIGN	HR	1296
OTHER					
18	7044	6-21	SURVEYING FOR MODIFIED CONCRETE OVERLAY	LS	1
19	7480	2-01	ROADSIDE CLEANUP	EST	1
20	7736	1-07	SPCC PLAN	LS	1

SCHEDULE B - NEW GRIFFITH BRIDGE NO. 503B

ITEM NO.	STD. ITEM NO.	SPECS REF.	DESCRIPTION	UNIT	QTY.
PREPARATION					
21	0001	1-09.7	MOBILIZATION	LS	1
22	0187	8-22	REMOVING PAINT LINE	LF	500
STRUCTURE					
23	4444	6-02	EXPANSION JOINT MODIFICATION - COMPRESSION SEAL	LF	98
HOT MIX ASPHALT					
24	5766	5-04	HMA CL. 3/8 IN. PG 64H-28	TON	33
25	0332	5-04	PAVEMENT REPAIR EXCAVATION INCL. HAUL	SY	54
26	6511	5-03	HMA SAWCUT AND SEAL	LF	91
EROSION CONTROL AND ROADSIDE PLANTING					
27	6403	8-01	ESC LEAD	DAY	1
28	6490	8-01	EROSION/ WATER POLLUTION CONTROL	EST	1
TRAFFIC					
29	6806	8-22	PAINT LINE	LF	2700
30	6807	1-10	PORTABLE TEMPORARY TRAFFIC CONTROL SIGNAL	LS	1
31	6971	1-10	PROJECT TEMPORARY TRAFFIC CONTROL	LS	1
32	6993	1-10	PORTABLE CHANGEABLE MESSAGE SIGN	HR	1056
OTHER					
33	7480	2-01	ROADSIDE CLEANUP	EST	1
34	7736	1-07	SPCC PLAN	LS	1
77	SP	2-02	REMOVAL AND DISPOSAL OF ASBESTOS MATERIAL	LS	1

SCHEDULE C - ARDENVOIR BRIDGE NO. 505A

ITEM NO.	STD. ITEM NO.	SPECS REF.	DESCRIPTION	UNIT	QTY.
PREPARATION					
35	0001	1-09.7	MOBILIZATION	LS	1
STRUCTURE					
36	4232	6-09	MODIFIED CONC. OVERLAY	CF	390
37	4233	6-02	FINISHING AND CURING MODIFIED CONC. OVERLAY	SY	347
38	4444	6-02	EXPANSION JOINT MODIFICATION - COMPRESSION SEAL	LF	37
39	SP	6-02	REMOVE STEEL ANGLE AND RECONSTRUCT CONCRETE EDGE	LF	52
40	4456	6-09	SCARIFYING CONC. SURFACE	SY	347
41	4467	6-09	FURTHER DECK PREPARATION FOR TYPE 2 DECK REPAIR	SF	380
HOT MIX ASPHALT					
42	5766	5-04	HMA CL. 3/8 IN. PG 64H-28	TON	30
43	0332	5-04	PAVEMENT REPAIR EXCAVATION INCL. HAUL	SY	50
44	6511	5-03	HMA SAWCUT AND SEAL	LF	52
EROSION CONTROL AND ROADSIDE PLANTING					
45	6403	8-01	ESC LEAD	DAY	1
46	6490	8-01	EROSION/ WATER POLLUTION CONTROL	EST	1
TRAFFIC					
47	6971	1-10	PROJECT TEMPORARY TRAFFIC CONTROL	LS	1
OTHER					
48	7044	6-21	SURVEYING FOR MODIFIED CONCRETE OVERLAY	LS	1
49	7480	2-01	ROADSIDE CLEANUP	EST	1
50	7736	1-07	SPCC PLAN	LS	1

SCHEDULE D - CHELAN FALLS 2 BRIDGE NO. 805A

ITEM NO.	STD. ITEM NO.	SPECS REF.	DESCRIPTION	UNIT	QTY.
PREPARATION					
51	0001	1-09.7	MOBILIZATION	LS	1
52	0187	8-22	REMOVING PAINT LINE	LF	500
STRUCTURE					
53	4444	6-02	EXPANSION JOINT MODIFICATION - COMPRESSION SEAL	LF	205
HOT MIX ASPHALT					
54	5766	5-04	HMA CL. 3/8 IN. PG 64H-28	TON	25
55	0332	5-04	PAVEMENT REPAIR EXCAVATION INCL. HAUL	SY	38
56	6511	5-03	HMA SAWCUT AND SEAL	LF	65
EROSION CONTROL AND ROADSIDE PLANTING					
57	6403	8-01	ESC LEAD	DAY	1
58	6490	8-01	EROSION/ WATER POLLUTION CONTROL	EST	1
TRAFFIC					
59	6781	6-10	TEMPORARY BARRIER	LF	1440
60	6806	8-22	PAINT LINE	LF	3500
61	6913	1-10	PORTABLE TEMPORARY TRAFFIC CONTROL SIGNAL	LS	1
62	6971	1-10	PROJECT TEMPORARY TRAFFIC CONTROL	LS	1
63	6993	1-10	PORTABLE CHANGEABLE MESSAGE SIGN	HR	1056
OTHER					
64	7480	2-01	ROADSIDE CLEANUP	EST	1
65	7736	1-07	SPCC PLAN	LS	1

SCHEDULE E - STONE HILL BRIDGE NO. 915

ITEM NO.	STD. ITEM NO.	SPECS REF.	DESCRIPTION	UNIT	QTY.
PREPARATION					
66	0001	1-09.7	MOBILIZATION	LS	1
STRUCTURE					
67	4444	6-02	EXPANSION JOINT MODIFICATION - RAPID CURE SILICONE SEALANT	LF	48
68	SP	6-02	REMOVE STEEL ANGLE AND RECONSTRUCT CONCRETE EDGE	LF	48
HOT MIX ASPHALT					
69	5766	5-04	HMA CL. 3/8 IN. PG 64H-28	TON	18
70	0332	5-04	PAVEMENT REPAIR EXCAVATION INCL. HAUL	SY	27
71	6511	5-03	HMA SAWCUT AND SEAL	LF	48
EROSION CONTROL AND ROADSIDE PLANTING					
72	6403	8-01	ESC LEAD	DAY	1
73	6490	8-01	EROSION/ WATER POLLUTION CONTROL	EST	1
TRAFFIC					
74	6971	1-10	PROJECT TEMPORARY TRAFFIC CONTROL	LS	1
OTHER					
75	7480	2-01	ROADSIDE CLEANUP	EST	1
76	7736	1-07	SPCC PLAN	LS	1

CAD USER: johnb PLOT DATE: Mar 12, 2024-04:20pm
PATH: V:\2300398 (CRP 747 Bridge Deck & Joint Rehab-Chelan County)\02_Design (v20XX)\S02-Summary of Quantities.dwg



1601 5th Avenue, Suite 1600
Seattle, WA 98101
206.622.5822
www.kpff.com



NO.	DATE	BY	REVISION
1	3/21/24	JEP	ADDENDUM 1

Chelan County

316 Washington Street, Suite 402
Wenatchee, Washington, 98801

509.667.6415
www.co.chelan.wa.us



CRP 747 Bridge Deck & Joint Rehabilitation
CHELAN COUNTY, WA

SUMMARY OF QUANTITIES

DRAWN: RRT	PROJECT NO.: 2300398
DESIGN: JEP	SCALE: AS SHOWN
CHECKED: AWO	DATE: 03-12-2024
DRAWING NO.	S02
SHEET NO.	3 OF 29

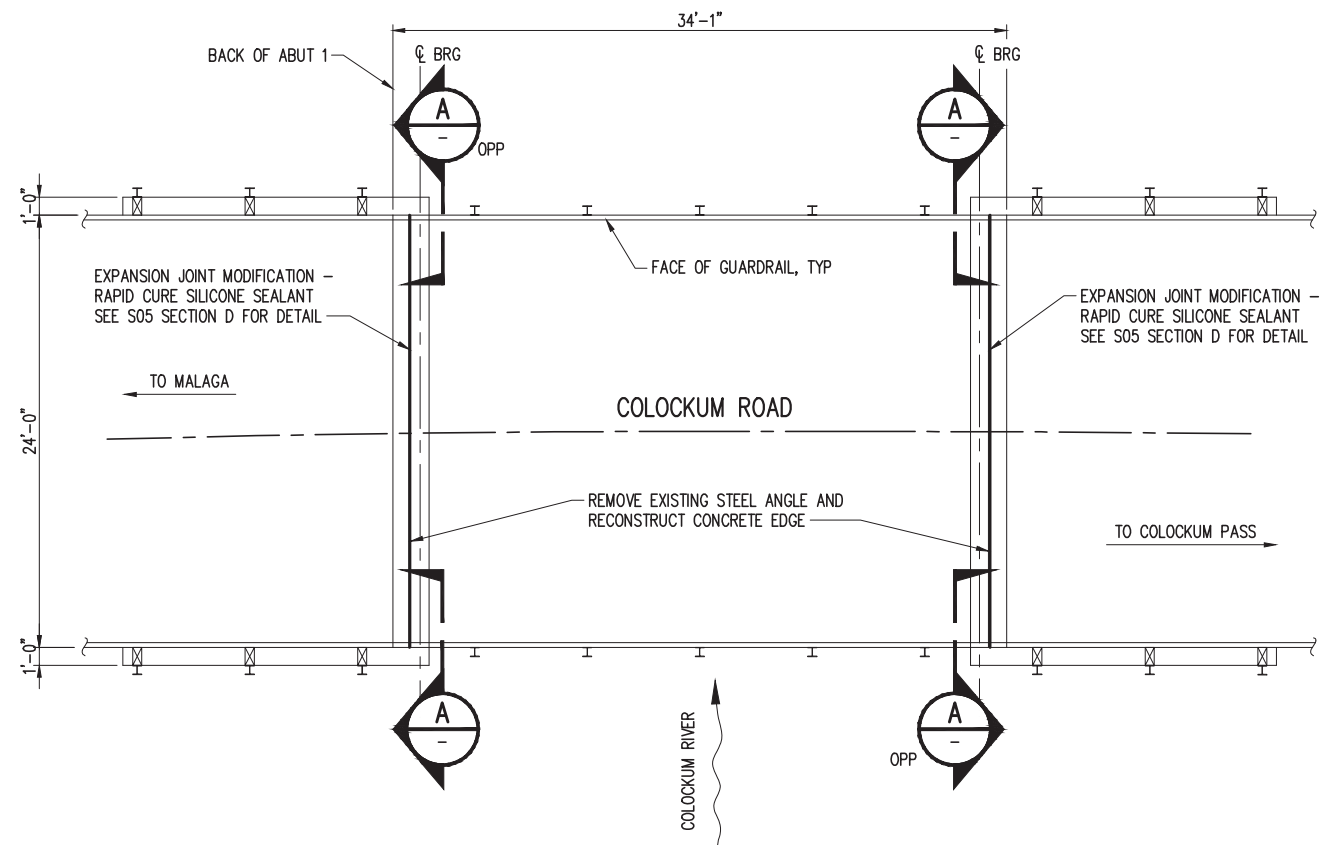

PLAN

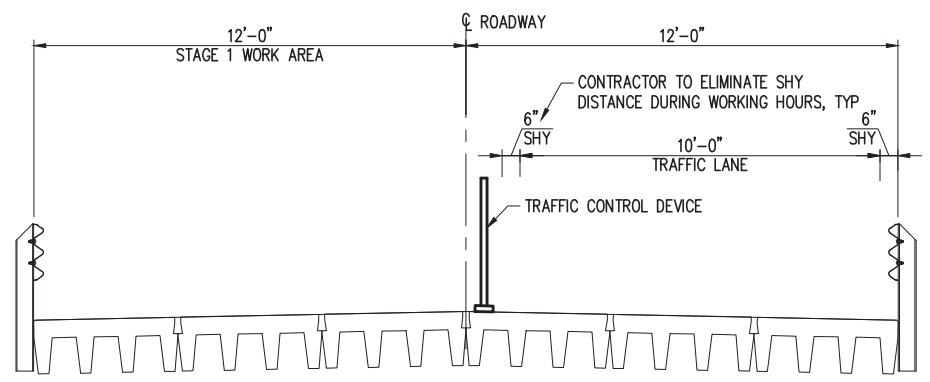

STAGE 1 - TYPICAL SECTION

SCALE: 3/8" = 1'-0"

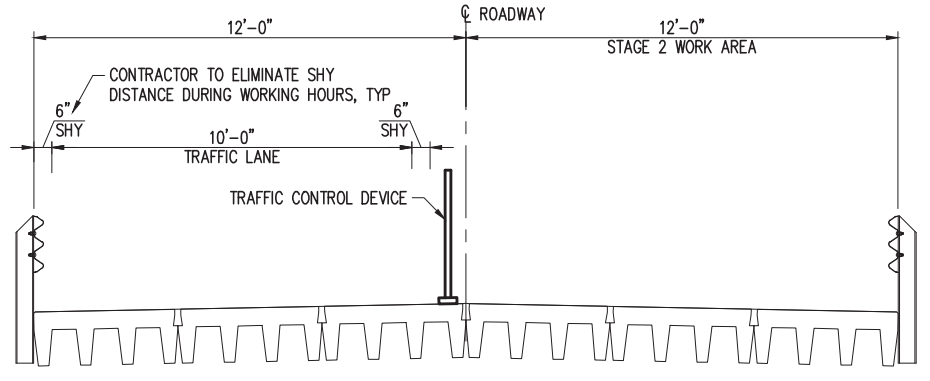

STAGE 2 - TYPICAL SECTION

SCALE: 3/8" = 1'-0"

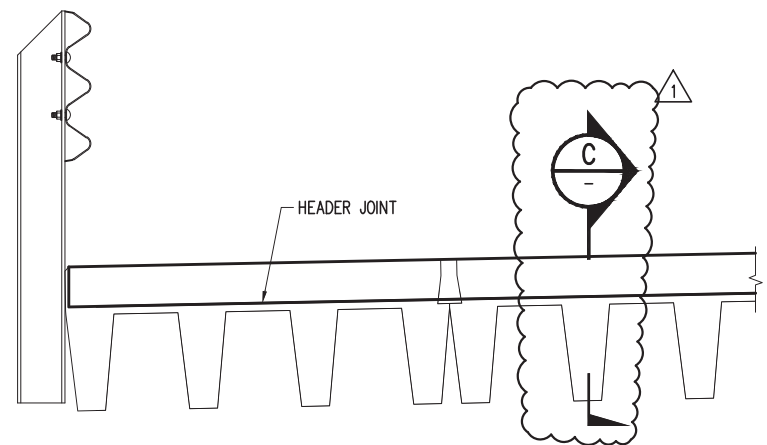

EXPANSION JOINT SECTION A

SCALE: 1" = 1'-0"

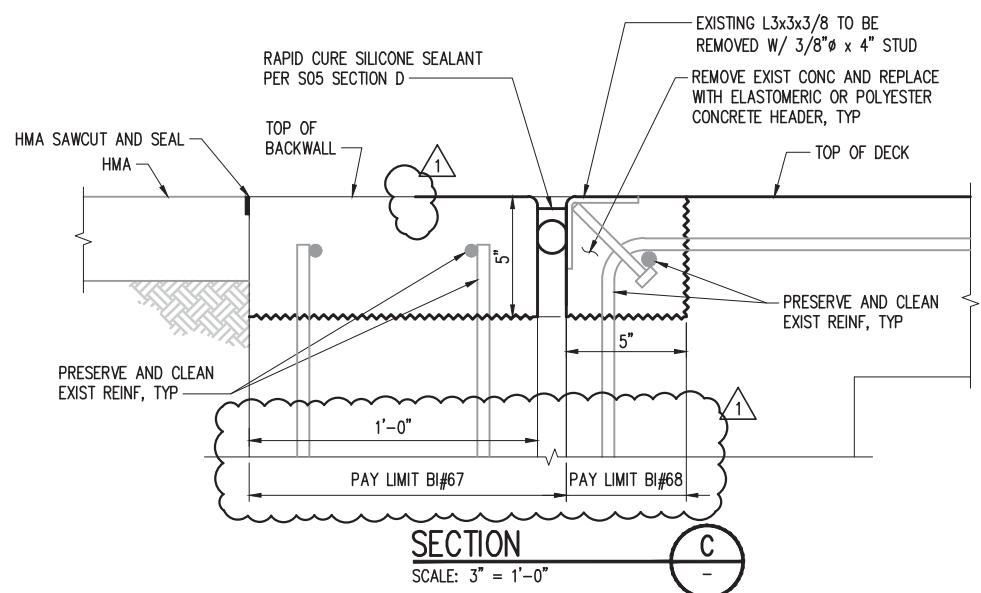

SECTION C

SCALE: 3" = 1'-0"

EXPANSION JOINT REPLACEMENT

CAD USER: jhnb PLOT DATE: Mar 21, 2024-09:04am
 PATH: V:\2300398 (CRP 747 Bridge Deck & Joint Rehab-Chelan County)\02_Design (v20XX)\S11-Stone Hill Br 915.dwg



NO.	DATE	BY	REVISION
1	3/21/24	JEP	ADDENDUM 1

Chelan County
 316 Washington Street, Suite 402
 Wenatchee, Washington, 98801
 509.667.6415
 www.co.chelan.wa.us



CRP 747 Bridge Deck & Joint Rehabilitation
 CHELAN COUNTY, WA
 STONE HILL BRIDGE NO. 915
 PLAN AND TYPICAL SECTION

DRAWN: RRT	PROJECT NO.: 2300398
DESIGN: JEP	SCALE: AS SHOWN
CHECKED: AWO	DATE: 03-12-2024
DRAWING NO.	S11
SHEET NO.	12 OF 29

SIGN SPACING = X (1)		
RURAL HIGHWAYS	60-65 MPH	800'
RURAL ROADS	45-55 MPH	500'

(1) ALL SPACING MAY BE ADJUSTED TO ACCOMMODATE INTERCHANGE RAMPS, AT-GRADE INTERSECTIONS AND DRIVEWAYS.

MAXIMUM CHANNELIZATION DEVICE SPACING	
TAPER	TANGENT
10'	20'

SPEED REDUCTION AHEAD SIGN SPACING = Z					
EXISTING SPEED LIMIT (MPH)	45	50	55	60	65
SPACING (feet)	230	470	740	1030	1340

WAIT-TIME DISPLAY VMS		
GREEN	YELLOW	RED
25 MPH ZONE	(Blank)	WAIT
		##:##

FOR DRIVEWAY, BUSINESS ACCESS, AND INTERSECTING ROADWAY DETAILS SEE TC341, SHEET 3.

##:## = MINUTES:SECONDS UNTIL GREEN.
LOCATE VMS ON TEMP SIGNAL MAST ARM.

mPCMS		
1	2	3
TRAFFIC SIGNAL 1.5 MILES	WATCH 4 STOPPED TRAFFIC 1.5 SEC	ROADWAY NARROWS 13' WIDE 1.5 SEC

FIELD LOCATE 1.5+/- MILES PRIOR TO TEMP SIGNAL. RELOCATE TO REMAIN 0.5%+ MILE IN ADVANCE OF TRAFFIC QUEUE IF NEEDED.

LOCATE PER STD. SPEC. 1-10.3(3)C.



LEGEND	
	CONSTRUCTION SIGN, CLASS A
	WORK ZONE

GENERAL NOTES:

1. CONTRACTOR SHALL MIRROR TRAFFIC CONTROL SETUP FOR WORK IN OPPOSITE DIRECTION.

B/W - BLACK ON WHITE BACKGROUND SIGN
B/O - BLACK ON ORANGE BACKGROUND SIGN
B/W/O - BLACK, RED, WHITE ON ORANGE BACKGROUND SIGN

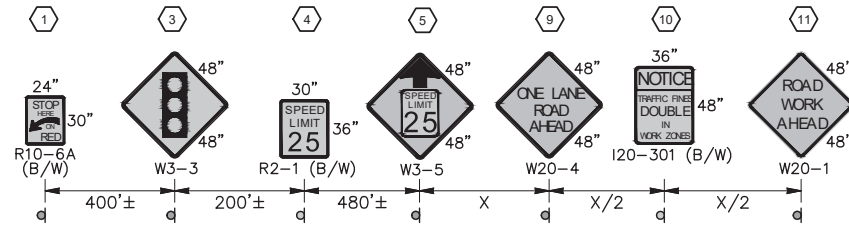
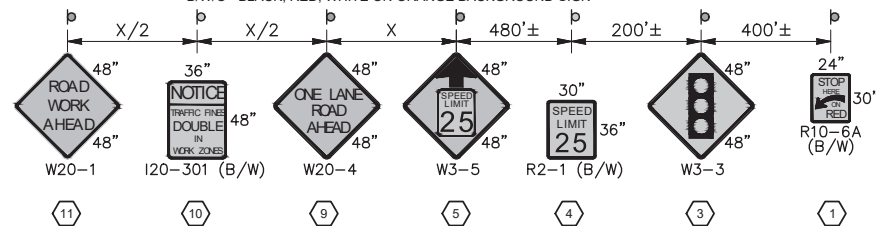

CAD USER: emurguia PLOT DATE: Mar 21, 2024-01:37pm
PATH: Z:\Civitech\Projects\23-0680 KPFF- WSDOT Chelan Co CRP747 Bridge Rehab\Drawings\23-0680_TC02.dwg



NO.	DATE	BY	REVISION
1	3/21/24	HMR	ADDENDUM 1

Chelan County
316 Washington Street, Suite 402
Wenatchee, Washington, 98801
509.667.6415
www.co.chelan.wa.us



CRP 747 Bridge Deck & Joint Rehabilitation
CHELAN COUNTY, WA
NEW GRIFFITH BRIDGE
(BRIDGE #503B)
TRAFFIC CONTROL PLAN

DRAWN:	PROJECT NO.: 2300398
DESIGN:	SCALE:
CHECKED:	DATE: 03-12-2024
DRAWING NO.	C02
SHEET NO.	15 OF 29

SIGN SPACING = X (1)		
RURAL HIGHWAYS	60-65 MPH	800'
RURAL ROADS	45-55 MPH	500'
RURAL ROADS	25-35 MPH	100'

(1) ALL SPACING MAY BE ADJUSTED TO ACCOMMODATE INTERCHANGE RAMPS, AT-GRADE INTERSECTIONS AND DRIVEWAYS.

MAXIMUM CHANNELIZATION DEVICE SPACING	
TAPER	TANGENT
10'	20'

mPCMS		
1	2	3
TRAFFIC SIGNAL 1.5 MILES 1.5 SEC	WATCH 4 STOPPED TRAFFIC 1.5 SEC	ROADWAY NARROWS 13' WIDE 1.5 SEC

FIELD LOCATE 1.5+/- MILES PRIOR TO TEMP SIGNAL. RELOCATE TO REMAIN 0.5%± MILE IN ADVANCE OF TRAFFIC QUEUE IF NEEDED.

LOCATE PER STD. SPEC. 1-10.3(3)C.

SPEED REDUCTION AHEAD SIGN SPACING = Z					
EXISTING SPEED LIMIT (MPH)	45	50	55	60	65
SPACING (feet)	230	470	740	1030	1340

FOR DRIVEWAY, BUSINESS ACCESS, AND INTERSECTING ROADWAY DETAILS SEE TC341, SHEET 3.

WAIT-TIME DISPLAY VMS		
GREEN	YELLOW	RED
25 MPH ZONE	(Blank)	WAIT
###	###	###

= MINUTES:SECONDS UNTIL GREEN. LOCATE VMS ON TEMP SIGNAL MAST ARM.



LEGEND	
	CONSTRUCTION SIGN, CLASS A
	WORK ZONE

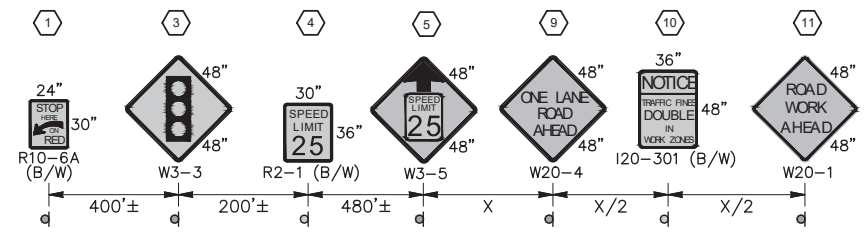
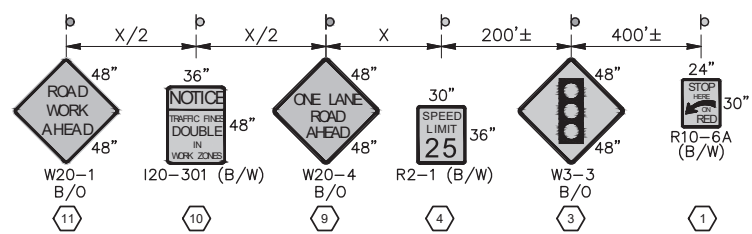

GENERAL NOTES:

- CONTRACTOR SHALL MIRROR TRAFFIC CONTROL SETUP FOR WORK IN OPPOSITE DIRECTION.
- B/W - BLACK ON WHITE BACKGROUND SIGN
 B/O - BLACK ON ORANGE BACKGROUND SIGN
 B/W/O - BLACK, RED, WHITE ON ORANGE BACKGROUND SIGN

CAD USER: emurguia PLOT DATE: Mar 21, 2024-01:37pm PATH: Z:\Civitech\Projects\23-0680 KPFF- WSDOT Chelan Co CRP747 Bridge Rehab\Drawg\Sheets\23-0680_TC04.dwg



NO.	DATE	BY	REVISION
1	3/21/24	HMR	ADDENDUM 1

Chelan County
 316 Washington Street, Suite 402
 Wenatchee, Washington, 98801
 509.667.6415
 www.co.chelan.wa.us

CRP 747 Bridge Deck & Joint Rehabilitation
 CHELAN COUNTY, WA
 CHELAN FALLS 2 BRIDGE
 (BRIDGE #805A)
 TRAFFIC CONTROL PLAN

DRAWN:	PROJECT NO.: 2300398
DESIGN:	SCALE:
CHECKED:	DATE: 03-12-2024
DRAWING NO.	C04
SHEET NO.	17 OF 29

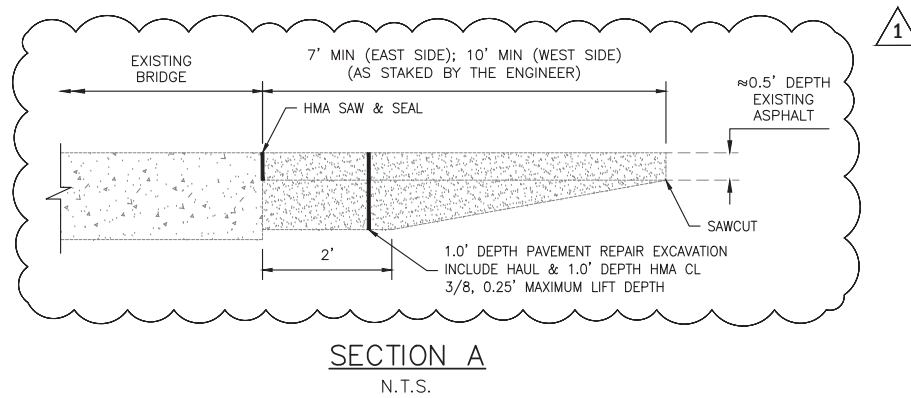
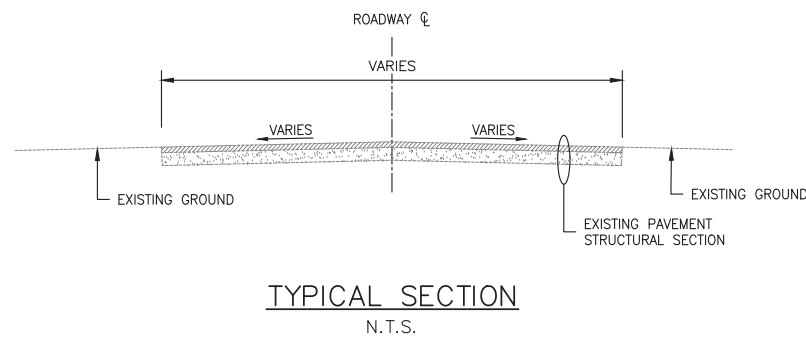

GENERAL NOTES:

1. ALL MATERIALS AND WORK SHALL BE DONE IN ACCORDANCE WITH THE REQUIREMENTS OF THE WASHINGTON STATE DEPARTMENT OF TRANSPORTATION STANDARD SPECIFICATIONS FOR ROAD, BRIDGE, AND MUNICIPAL CONSTRUCTION, DATED 2023.
2. THE DIMENSIONS SHOWN IN THE PLANS ARE APPROXIMATE. ALL RELEVANT DETAILS AND DIMENSIONS SHALL BE FIELD MEASURED AND VERIFIED BY THE CONTRACTOR PRIOR TO ORDERING MATERIALS AND PROCEEDING WITH CONSTRUCTION.
3. CONTRACTOR SHALL NOT PLACE EXCAVATED MATERIAL ON THE BRIDGE.

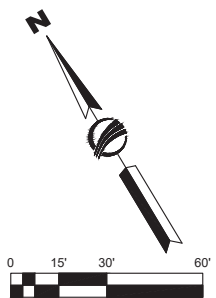

CAD USER: emurguia PLOT DATE: Mar 21, 2024-01:37pm
PATH: Z:\Civitech\Projects\23-0680 KPFF- WSDOT Chelan Co CRP747 Bridge Rehab\Drawings\Sheets\23-0680_P01.dwg



NO.	DATE	BY	REVISION
1	3/21/24	HMR	ADDENDUM 1

Chelan County
316 Washington Street, Suite 402
Wenatchee, Washington, 98801
509.667.6415
www.co.chelan.wa.us



CRP 747 Bridge Deck & Joint Rehabilitation
CHELAN COUNTY, WA
ARDENVOIR BRIDGE
(BRIDGE #505A)
MILL & OVERLAY PLAN

DRAWN:	PROJECT NO.: 2300398
DESIGN:	SCALE:
CHECKED:	DATE: 03-12-2024
DRAWING NO.	C09
SHEET NO.	22 OF 29

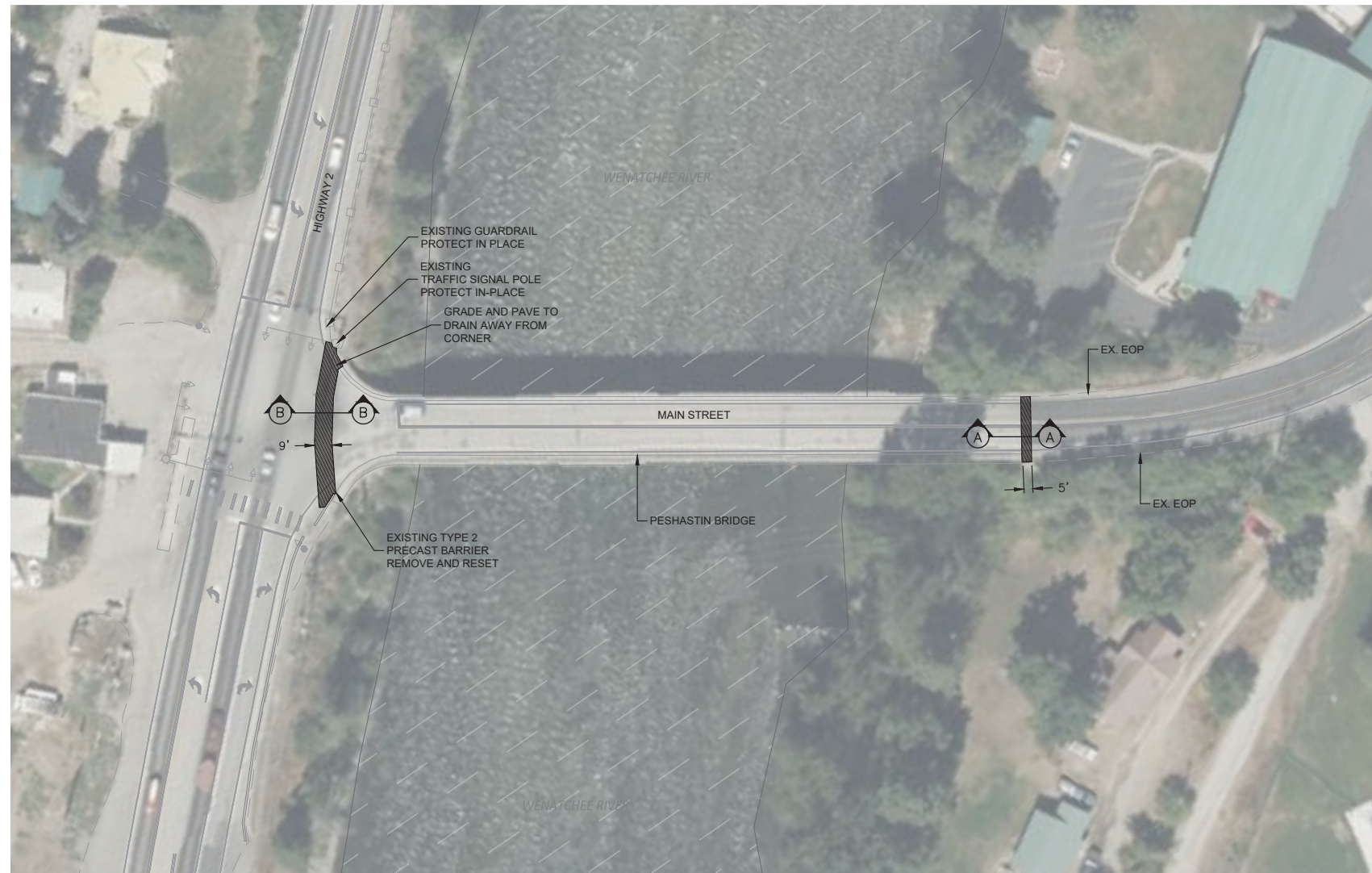

- GENERAL NOTES:**
1. ALL MATERIALS AND WORK SHALL BE DONE IN ACCORDANCE WITH THE REQUIREMENTS OF THE WASHINGTON STATE DEPARTMENT OF TRANSPORTATION STANDARD SPECIFICATIONS FOR ROAD, BRIDGE, AND MUNICIPAL CONSTRUCTION, DATED 2023.
 2. THE DIMENSIONS SHOWN IN THE PLANS ARE APPROXIMATE. ALL RELEVANT DETAILS AND DIMENSIONS SHALL BE FIELD MEASURED AND VERIFIED BY THE CONTRACTOR PRIOR TO ORDERING MATERIALS AND PROCEEDING WITH CONSTRUCTION.
 3. CONTRACTOR SHALL NOT PLACE EXCAVATED MATERIAL ON THE BRIDGE.

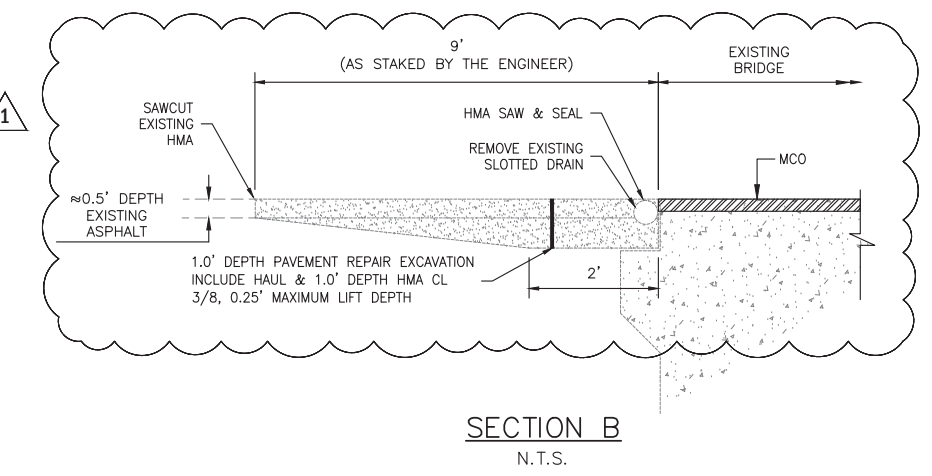
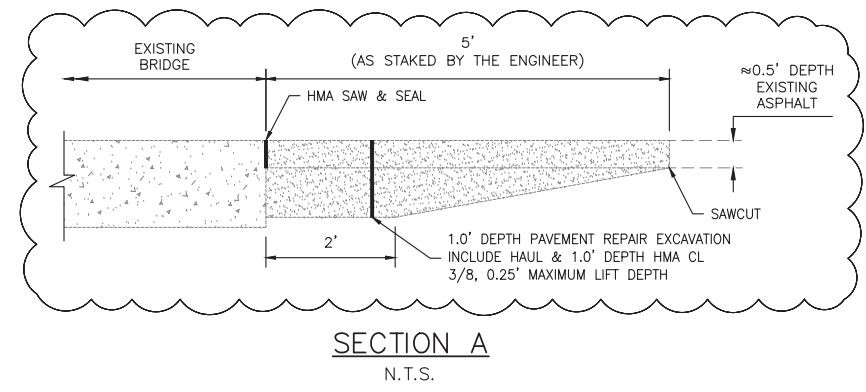
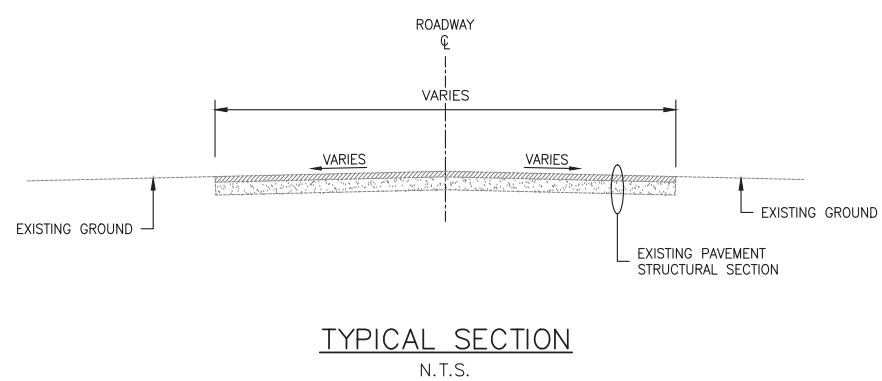

CAD USER: emurguia PLOT DATE: Mar 21, 2024-01:38pm
 PATH: Z:\Civitech\Projects\23-0680 KPFF- WSDOT Chelan Co CRP747 Bridge Rehab\Drawings\Sheets\23-0680_P02.dwg



NO.	DATE	BY	REVISION
1	3/21/24	HMR	ADDENDUM 1

Chelan County
 316 Washington Street, Suite 402
 Wenatchee, Washington, 98801
 509.667.6415
 www.co.chelan.wa.us

CRP 747 Bridge Deck & Joint Rehabilitation
 CHELAN COUNTY, WA
PESHASTIN BRIDGE
 (BRIDGE #411A)
 MILL & OVERLAY PLAN

DRAWN:	PROJECT NO.: 2300398
DESIGN:	SCALE:
CHECKED:	DATE: 03-12-2024
DRAWING NO.	C10
SHEET NO.	23 OF 29

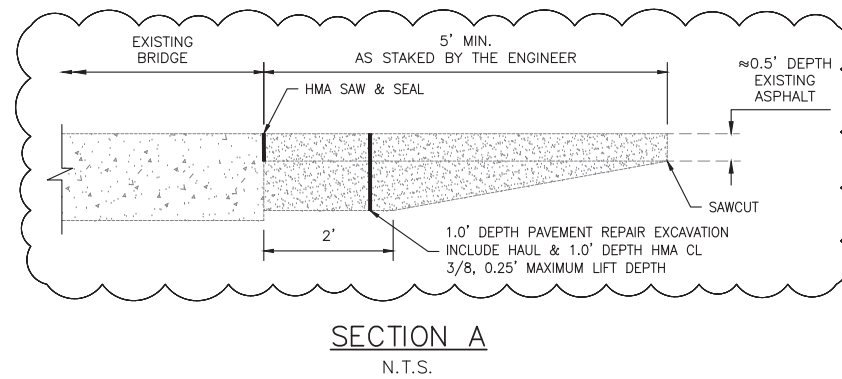
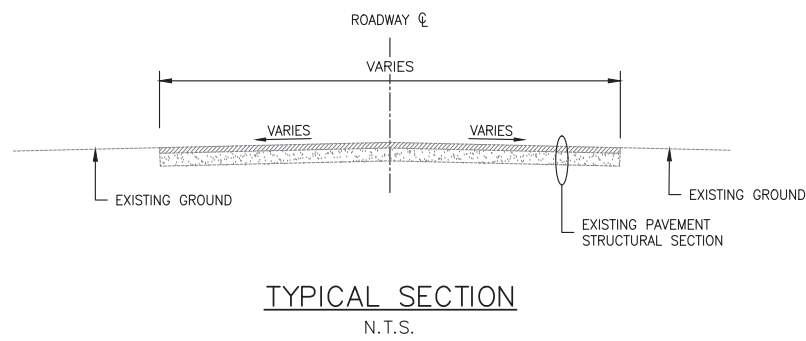

GENERAL NOTES:

1. ALL MATERIALS AND WORK SHALL BE DONE IN ACCORDANCE WITH THE REQUIREMENTS OF THE WASHINGTON STATE DEPARTMENT OF TRANSPORTATION STANDARD SPECIFICATIONS FOR ROAD, BRIDGE, AND MUNICIPAL CONSTRUCTION, DATED 2023.
2. THE DIMENSIONS SHOWN IN THE PLANS ARE APPROXIMATE. ALL RELEVANT DETAILS AND DIMENSIONS SHALL BE FIELD MEASURED AND VERIFIED BY THE CONTRACTOR PRIOR TO ORDERING MATERIALS AND PROCEEDING WITH CONSTRUCTION.
3. CONTRACTOR SHALL NOT PLACE EXCAVATED MATERIAL ON THE BRIDGE.

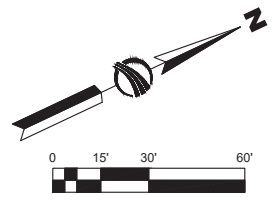

CAD USER: emurguia PLOT DATE: Mar 21, 2024-01:38pm
 PATH: Z:\Civitech\Projects\23-0680 KPFF- WSDOT Chelan Co CRP747 Bridge Rehab\Drawings\Sheets\23-0680_P03.dwg



NO.	DATE	BY	REVISION
1	3/21/24	HMR	ADDENDUM 1

Chelan County
 316 Washington Street, Suite 402
 Wenatchee, Washington, 98801
 509. 667. 6415
 www.co.chelan.wa.us



CRP 747 Bridge Deck & Joint Rehabilitation
 CHELAN COUNTY, WA
CHELAN FALLS 2 BRIDGE
 (BRIDGE #805A)
MILL & OVERLAY PLAN

DRAWN:	PROJECT NO.: 2300398
DESIGN:	SCALE:
CHECKED:	DATE: 03-12-2024
DRAWING NO.	C11
SHEET NO.	24 OF 29

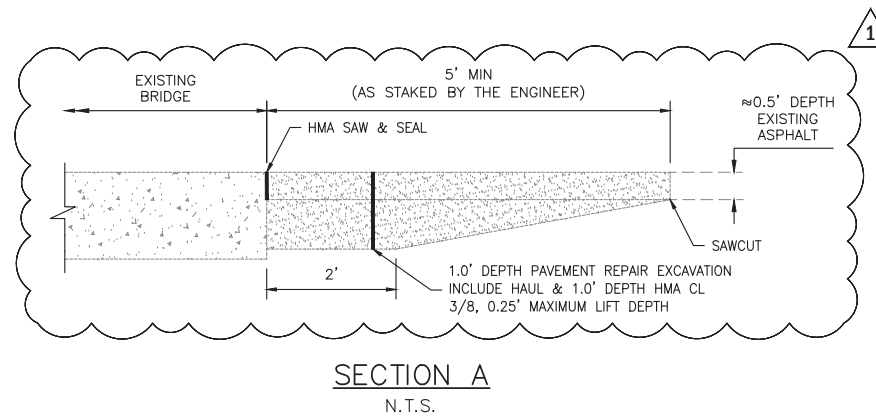
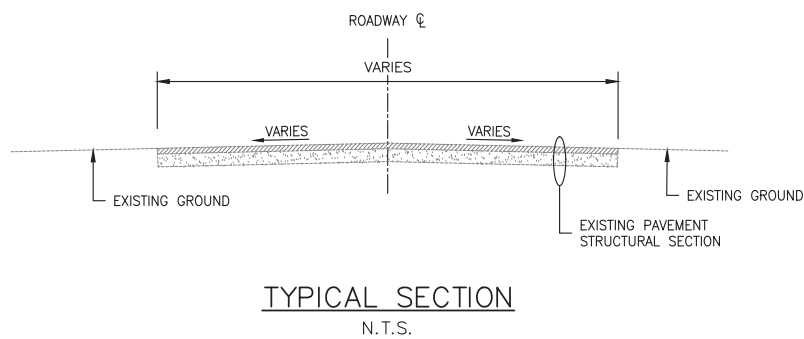
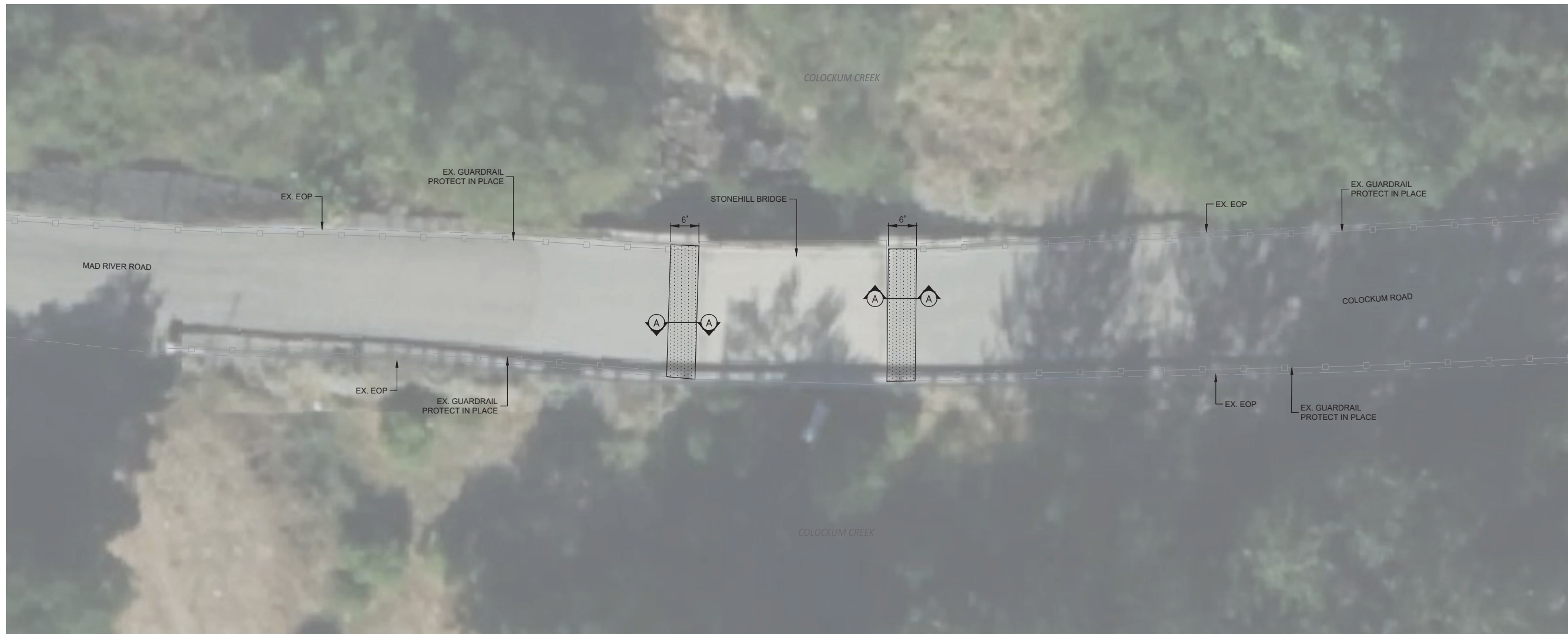

GENERAL NOTES:

1. ALL MATERIALS AND WORK SHALL BE DONE IN ACCORDANCE WITH THE REQUIREMENTS OF THE WASHINGTON STATE DEPARTMENT OF TRANSPORTATION STANDARD SPECIFICATIONS FOR ROAD, BRIDGE, AND MUNICIPAL CONSTRUCTION, DATED 2023.
2. THE DIMENSIONS SHOWN IN THE PLANS ARE APPROXIMATE. ALL RELEVANT DETAILS AND DIMENSIONS SHALL BE FIELD MEASURED AND VERIFIED BY THE CONTRACTOR PRIOR TO ORDERING MATERIALS AND PROCEEDING WITH CONSTRUCTION.
3. CONTRACTOR SHALL NOT PLACE EXCAVATED MATERIAL ON THE BRIDGE.



CAD USER: emurguia PLOT DATE: Mar 21, 2024-01:38pm PATH: Z:\Civitech\Projects\23-0680 KPFF- WSDOT Chelan Co CRP747 Bridge Rehab\DWG\Sheets\23-0680_P04.dwg



NO.	DATE	BY	REVISION
1	3/21/24	HMR	ADDENDUM 1

Chelan County
316 Washington Street, Suite 402
Wenatchee, Washington, 98801
509.667.6415
www.co.chelan.wa.us



CRP 747 Bridge Deck & Joint Rehabilitation
CHELAN COUNTY, WA
STONE HILL BRIDGE
(BRIDGE #915)
MILL & OVERLAY PLAN

DRAWN:	PROJECT NO.: 2300398
DESIGN:	SCALE:
CHECKED:	DATE: 03-12-2024
DRAWING NO.	C12
SHEET NO.	25 OF 29

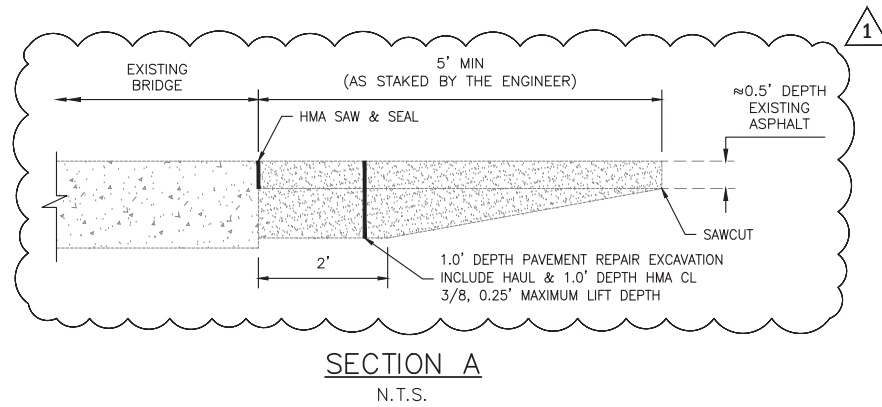
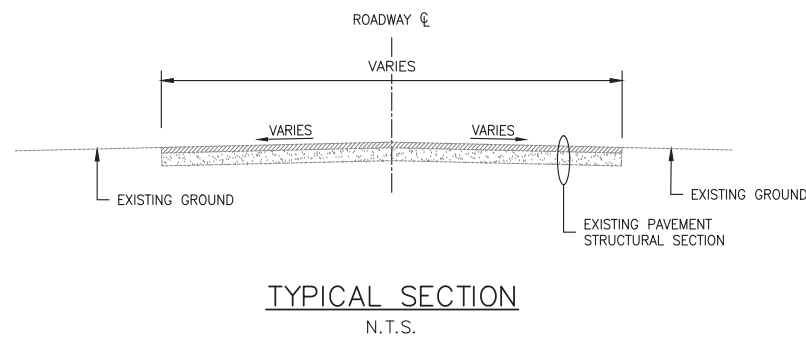

GENERAL NOTES:

1. ALL MATERIALS AND WORK SHALL BE DONE IN ACCORDANCE WITH THE REQUIREMENTS OF THE WASHINGTON STATE DEPARTMENT OF TRANSPORTATION STANDARD SPECIFICATIONS FOR ROAD, BRIDGE, AND MUNICIPAL CONSTRUCTION, DATED 2023.
2. THE DIMENSIONS SHOWN IN THE PLANS ARE APPROXIMATE. ALL RELEVANT DETAILS AND DIMENSIONS SHALL BE FIELD MEASURED AND VERIFIED BY THE CONTRACTOR PRIOR TO ORDERING MATERIALS AND PROCEEDING WITH CONSTRUCTION.
3. CONTRACTOR SHALL NOT PLACE EXCAVATED MATERIAL ON THE BRIDGE.

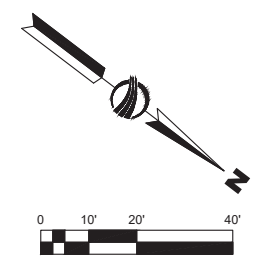

CAD USER: emurguia PLOT DATE: Mar 21, 2024-01:38pm PATH: Z:\Civitech\Projects\23-0680 KPFF- WSDOT Chelan Co CRP747 Bridge Rehab\DWG\Sheets\23-0680_P05.dwg



NO.	DATE	BY	REVISION
1	3/21/24	HMR	ADDENDUM 1

Chelan County
 316 Washington Street, Suite 402
 Wenatchee, Washington, 98801
 509.667.6415
 www.co.chelan.wa.us



CRP 747 Bridge Deck & Joint Rehabilitation
 CHELAN COUNTY, WA
NEW GRIFFITH BRIDGE
 (BRIDGE #503B)
MILL & OVERLAY PLAN

DRAWN:	PROJECT NO.: 2300398
DESIGN:	SCALE:
CHECKED:	DATE: 03-12-2024
DRAWING NO.	C13
SHEET NO.	26 OF 29