



Annual Report

Number	Permit Section	Question
1	S5.A.4.	Attach updated annual Stormwater Management Program Plan (SWMP Plan) or website address in the Comment field where it can be found. (S5.A.4.) 1 - 2020 SWMP_1_03172021153131
1.a	S5.A.4.	Cite website of SWMP if unable to attach https://www.wenatcheewa.gov/government/public-works/stormwater/wvstac
2	S9.C.6.	Attach a map and copy of any annexations, incorporations, or boundary changes resulting in an increase or decrease in the Permittee's geographic area of permit coverage during the reporting period per S9.C.6. 2 - 2020 Utility Boundary and _2_03152021153711
3	S5.A.5.a.ii.	Tracked the estimated costs of implementation of each component of the SWMP. (S5.A.5.a.ii.) Yes
4	S5.A.6.b.	Coordinated among departments within the jurisdiction to eliminate barriers to permit compliance. (S5.A.6.b.) Yes
4a	S5.A.6.b.	Attach a written description of internal coordination mechanisms among departments within the jurisdiction to eliminate barriers to permit compliance. (Required to be submitted no later than March 31, 2021, S5.A.6.b.) 4a - Internal Coordination Mec_4a_03042021085647
5	S5.B.1	Were elements of a regional program implemented to complete any part of your education and outreach program? (S5.B.1) Yes
5a	S5.B.1	If yes, list the elements, and the regional program WVSTAC mobile contractor education and outreach program, radio advertisements on smart irrigation, seasonal (spring/fall) BMPs reminders, free dog poop kits provided to local animal shelters
6	S5.B.1.a.i.-iii.	Attach description of public education and outreach programs and stewardship activities conducted per S5.B.1.a.i.-iii. 6 - 2020 Public Education and _6_03082021152242
7	S5.B.1.a.ii.	Which types of businesses were targeted per S.5.B.1.a.ii.? Irrigation and landscaping companies, homeless waste disposal outreach, animal shelters, mobile contractor, construction operators

Number	Permit Section	Question
8	S5.B.1.b.	Used results of measuring the understanding and adoption of targeted behaviors among at least one audience in at least one subject area to direct education and outreach resources and evaluate changes in adoption of targeted behaviors. (Required no later than December 31, 1347, S5.B.1.b.) Not Applicable
9	S5.B.2.a.	Describe in Comments field the opportunities created for the public to participate in the decision making processes involving the development, implementation, and updates of the Permittee's SWMP. (S5.B.2.a.) As a result of COVID, opportunities were limited. Input from the Wenatchee Valley Stormwater Steering Committee was via an emailed survey. Additionally, the WVSTAC webpage retained the survey online for several weeks allowing participation. Chelan County Board of County Commissioners have weekly meetings where the public can provide comments on the stormwater program and available via Zoom.
10	S5.B.2.b.	Posted the updated SWMP Plan and latest annual report on your website no later than May 31. Yes
10a	S5.B.2.b.	List the website address in Comments field. (S5.B.2.b.) https://www.co.chelan.wa.us/public-works/pages/storm-water
11	S5.B.3.a.	Maintained a map of the MS4 that includes the requirements listed in S5.B.3.a. (Updated maps required no later than August 1, 2023) No
12	S5.B.3.a.i.	Attach a spreadsheet that lists the known outfalls and discharge points, including the outfalls' size and material(s). (Required to update no later than August 1, 2023, S5.B.3.a.i.) Not Applicable
13	S5.B.3.a.ix.	Developed an electronic format for map, with fully described mapping standards in accordance with S5.B.3.a.ix. (Required no later than August 1, 2021) Not Applicable
14	S5.B.3.b.	Implemented an ordinance or other regulatory mechanism to effectively prohibit non-stormwater, illicit discharges as described in S5.B.3.b. Yes
15	S.5.B.3.b.vii.	Updated ordinance or regulatory mechanism to meet the requirements of this permit, if necessary. (Required no later than February 2, 2023, S.5.B.3.b.vii.) Yes
15a	S.5.B.3.b.vii.	Cite the code reference in Comments field. Chelan County Code chapter 13.14 https://www.codepublishing.com/WA/ChelanCounty/

Number	Permit Section	Question
16	S5.B.3.b.vi.	Implemented a compliance strategy, including informal compliance actions as well as enforcement provisions of the regulatory mechanism described in S5.B.3.b. (S5.B.3.b.vi.) Yes
17	S5.B.3.c.	Implemented procedures for conducting illicit discharge investigations in accordance with S5.B.3.c. Yes
18	S5.B.3.c.iv.	Percentage of MS4 coverage area screened in reporting year per S5.B.3.c.iv. (Required to screen 12% on average each year, S5.B.3.c.iv.) 12
18a	S5.B.3.c.iv.	Cite field screening techniques used to determine percent of MS4 screened. WinCAMS time tracking, GIS tracking.
18b	S5.B.3.c.iv.	Percentage of total MS4 screened from permit effective date through end of the reporting year. 25
19	S5.B.3.c.v.	Describe how you publicized a hotline telephone number for public reporting of spills and other illicit discharges in the Comments field. (S5.B.3.c.v.) https://www.co.chelan.wa.us/public-works/pages/storm-water Hotline listed on education and outreach material provided to the public.
20	S5.B.3.c.vi.	Implemented an ongoing illicit discharge training program for all municipal field staff per S5.B.3.c.vi. Yes
21	S5.B.3.c.vii.	Informed public employees, businesses, and the general public of hazards associated with illicit discharges and improper disposal of waste. Describe actions in Comments field. (S5.B.3.c.vii.) Website, education and outreach program, radio advertisements.
22	S5.B.3.d.	Implemented an ongoing program designed to address illicit discharges, including spills and illicit connections into the MS4 per S5.B.3.d. Yes
23	S5.B.3.e.	Implemented an ongoing illicit discharge training program for all staff responsible for implementing the procedures and program, as described in S5.B.3.e. Yes
24	S5.B.3.f.	Attach a report with data describing the actions taken to investigate, characterize, trace and eliminate each illicit discharge found by or reported to the permittee. The submittal must include all of the applicable information and must follow the format and timelines described in Appendix 7. (S5.B.3.f.) 24 - IDDE Reporting tool 2020_24_03172021141340 Comment: PUD domestic water line break.

Number	Permit Section	Question
25	S5.B.4.a.	Implemented an ordinance or other regulatory mechanism and enforcement procedures for construction site stormwater runoff control as described in S5.B.4. Yes
26	S5.B.4.a.i.-iv.	Adopted ordinance or other regulatory mechanism and enforcement procedures for construction site stormwater runoff control as described in S5.B.4.a.i.-iv. (Required no later than December 31, 2022) Not Applicable
27	S5.B.4.b.	Reviewed site plans for all new development and redevelopment projects as described in S5.B.4.b. Yes
27a	S5.B.4.b.i.	Number of site plans reviewed during the reporting period. (S5.B.4.b.i.) 8
27b	S5.B.4.b.i.	The number of construction sites that provided their intent to apply for the "Erosivity Waiver" during the reporting period as described in S5.B.4.b.i. 0
27c	S5.B.4.b.i.	The number of complaints investigated about sites that have received an "Erosivity Waiver" . (S5.B.4.b.i.) 0
28	S5.B.4.	Implemented procedures for site inspection and enforcement of construction stormwater pollution control measures. (S5.B.4.) Yes
28a	S5.B.4.c.i.	Number of permitted construction sites inspected during the reporting period. (S5.B.4.c.i.) 8
28b	S5.B.4.f.	Number of enforcement actions taken during the reporting period based on construction phase inspections at new development and redevelopment projects. (S5.B.4.f.) 0
29	S5.B.4.d.	Trained the staff involved in permitting, plan review, field inspections, and enforcement for construction site runoff control. (S5.B.4.d.) Yes
30	S5.B.4.e.	Provided information to construction site operators and design professionals about training available on how to comply with the requirements in Appendix 1 and the BMPs in the SWMMEW, or an equivalent document. Describe information provided in the Comments field. (S5.B.4.e.) Yes
30a	S5.B.4.e.	Describe information provided in the Comments field. (S5.B.4.e.) Email communication, WVSTAC/County website, pre-application meetings, building permit conditions.

Number	Permit Section	Question
31	S5.B.5.a.	Implemented ordinance or other regulatory mechanism and enforcement procedures to address post-construction stormwater controls runoff to the MS4 from new development and redevelopment as described in S5.B.5.a. Yes
32	S5.B.5.a.	Revised ordinance or other regulatory mechanism and enforcement procedures to address post-construction stormwater controls runoff to the MS4 from new development and redevelopment as described in S5.B.5.a. (Adopted no later than December 31, 2022) Not Applicable
33	S5.B.5.b.ii.(a)	Allowed non-structural preventive actions and source reduction approaches such as Low Impact Development (LID) techniques to be used. (S5.B.5.b.ii.(a)) Yes
34	S5.B.5.b.ii.(b)(2)	Required projects approved under S5.B.5. to retain runoff generate on-site for, at a minimum, the 10-year, 24-hour rainfall event or a local equivalent, using either on-site or regional stormwater facilities. (S5.B.5.b.ii.(b)(2)) Yes
35	S5.B.5.d.	Inspected post-construction stormwater controls, including structural BMPs, at new development and redevelopment sites. (S5.B.5.d.) Yes
35a	S5.B.5.d.i.	Number of new and redeveloped sites inspected during installation of structural BMPs during the reporting period. (S5.B.5.d.i.) 8
35b	S5.B.5.d.i.	Number of new and redeveloped sites inspected upon final installation of BMPs or upon completion of the project during the reporting period. (S5.B.5.d.i.) 8
36	S5.B.5.d.ii.	Inspected structural BMPs at least once every five years after final installation. (S5.B.5.d.ii.) Yes
36a	S5.B.5.d.ii.	Number of BMPs inspected during the reporting period. 3
37	S5.B.5.d.	Number of enforcement actions taken as a result of these inspections during the reporting period? (S5.B.5.d.) 0
38	S5.B.5.e.	Trained the staff involved in permitting, plan review, inspection, and enforcement for post-construction stormwater control. (S5.B.5.e.) Yes

Number	Permit Section	Question
39	S5.B.5.f.	<p>Provided information to design professionals about training available on how to comply with the requirements in Appendix 1 and apply the BMPs in the SWMMEW, or an equivalent document. (S5.B.5.f.)</p> <p>Yes</p>
39a	S5.B.5.f.	<p>Describe information provided and cite the manual used</p> <p>Department of Ecology Stormwater Management Manual for Eastern Washington. WVSTAC webpage, email communication, Ecology website.</p>
40	S5.B.6.a.	<p>Reviewed and, if needed, updated Operations and Maintenance Plan. (Required no later than December 31, 2022, S5.B.6.a.)</p> <p>Not Applicable</p>
41	S5.B.6.a.	<p>Implemented the schedule of Operation and Maintenance activities for municipal operations. (S5.B.6.a.)</p> <p>Yes</p>
42	S5.B.6.a.i.(f) and (g)	<p>Have NPDES permit coverage for all applicable Permittee construction projects and industrial facilities. (S5.B.6.a.i.(f) and (g))</p> <p>Yes</p>
43	S5.B.6.a.i.(h)	<p>Implemented a Stormwater Pollution Prevention Plan for all heavy equipment maintenance or storage yards, and material storage facilities owned or operated by the Permittee in areas subject to this Permit that are not required to have coverage under an NPDES permit that covers stormwater discharges associated with the activity. (S5.B.6.a.i.(h))</p> <p>Yes</p>
44	S5.B.6.a.ii.(a)	<p>Inspected stormwater treatment and flow control facilities (except catch basins) owned or operated by the Permittee at least once every two years. (S5.B.6.a.ii.(a))</p> <p>Yes</p>
44a	S5.B.6.a.ii.(a)	<p>Number of facilities inspected during the reporting period.</p> <p>2</p>
45	S5.B.6.a.ii.(b)	<p>Inspected municipally owned or operated catch basins and inlets every two years or used an alternative approach? (Required at least once every two years, S5.B.6.a.ii.(b))</p> <p>Yes</p>
45a	S5.B.6.a.ii.(b)	<p>Number of known catch basins.</p> <p>668</p>
45b	S5.B.6.a.ii.(b)	<p>Number of catch basins inspected during the reporting period.</p> <p>668</p>
45c	S5.B.6.a.ii.(b)	<p>Number of known catch basins cleaned during the reporting period.</p> <p>300</p>

Number	Permit Section	Question
46	S5.B.6.a.ii.(b)	If used an alternative to standard schedule for catch basin inspections for all or a portion of the MS4, attach description of the method used. (S5.B.6.a.ii.(b)) Not Applicable
47	S5.B.6.a.ii.(c)	Conducted spot checks of stormwater facilities after major storms. (S5.B.6.a.ii.(c)) Not Applicable
48	S5.B.6.b.	Trained the staff with primary construction, operations, or maintenance job functions that are likely to impact stormwater quality. (S5.B.6.b.) Yes
49	S7.A.	Complied with the Total Maximum Daily Load (TMDL)-specific requirements identified in Appendix 2. (S7.A.) Not Applicable
50	S7.A.	For TMDLs listed in Appendix 2: Attach a summary of relevant SWMP and Appendix 2 activities to address the applicable TMDL parameter(s). (S7.A.) Not Applicable
51	S8.A.	Attach a summary of your participation in effectiveness study development and implementation during the reporting year. (S8.A.1. and S8.A.2.a.) 51 - Summary of Chelan County _51_03172021145559
56	S8.A.	Was the SWMP updated to include effectiveness study activities? (S8.A.2.f.) Yes
57	G3.	Notified Ecology in accordance with G3. of any discharge into or from the Permittees MS4 which could constitute a threat to human health, welfare, or the environment. (G3.) Not Applicable
58	G3.A.	Took appropriate action to correct or minimize the threat to human health, welfare, and/or the environment per G3.A. No
59	G20.	Notified Ecology of the failure to comply with the permit terms and conditions within 30 days of becoming aware of the non-compliance. (G20.) Not Applicable
60	G20.	Number of non-compliance notifications provided in reporting year. (G20.) Not Applicable
61	S4.F.1.	Notified Ecology within 30 days of becoming aware that a discharge from the Permittee's MS4 caused or contributed to a known or likely violation of water quality standards in the receiving water. (S4.F.1.) Not Applicable

Number Permit Section Question

62 S4.F.3.a. If requested, submitted an Adaptive Management Response report in accordance with S4.F.3.a.

Not Applicable

63 S4.F.3.d. Attach a summary of the status of implementation of any actions taken pursuant to S4.F.3. and the status of any monitoring, assessment, or evaluation efforts conducted during the reporting period. (S4.F.3.d.)

Not Applicable

Attachments:

View Files Attached to Submission

	DocDescr	DocName	DocExt	DocID	SubID	AppName
View	WAR046002_1_03172021153131	1 - 2020 SWMP_1_03172021153131	.pdf	1080809	1756665	wqwebportal
View	WAR046002_2_03152021153711	2 - 2020 Utility Boundary and _2_03152021153711	.pdf	1079714	1756665	wqwebportal
View	WAR046002_24_03172021141340	24 - IDDE Reporting tool 2020_24_03172021141340	.xlsx	1080766	1756665	wqwebportal
View	WAR046002_4a_03042021085647	4a - Internal Coordination Mec_4a_03042021085647	.pdf	1074927	1756665	wqwebportal
View	WAR046002_51_03172021145559	51 - Summary of Chelan County_51_03172021145559	.pdf	1080783	1756665	wqwebportal
View	WAR046002_6_03082021152242	6 - 2020 Public Education and _6_03082021152242	.pdf	1076367	1756665	wqwebportal

[Close](#)

[Ecology Home](#) | [WQWebPortal Home](#) | [WQWebSubmittal Home](#) | [Help](#) | [Release Notes](#) | [Contact Us](#)

Submittals (WQWebSubmittal) Version 1.5-3 | [Data Disclaimer](#) | [Privacy Policy](#)

Copyright © Washington State Department of Ecology 2021. All Rights Reserved.

Appendix A

2020 Stormwater Management Program Plan

2020 Wenatchee Valley Stormwater Management Program Plan

The following stormwater activities are regional activities unless otherwise noted. The regional partners include Chelan County, Douglas County, City of East Wenatchee, City of Wenatchee, and Wenatchee Valley College.

I. Stormwater Management Program

- a. Update Wenatchee Valley Stormwater Management Program Plan
- b. Schedule quarterly regional stormwater utility meetings.
- c. Prepare an annual report.
- d. Resubmit Internal Coordination with Annual Report (3/30/2021)

II. Public Education and Outreach

- a. Provide stormwater education and outreach through a public forum (ad, newsprint, social media, radio) and/or public event.
- b. Participate in Wenatchee School District programs (City of Wenatchee)
- c. Distribute Updated Dump Smart Program Materials
- d. Provide Education for Concrete Wash Out
- e. Measure understanding and adoption of behavior for one target audience and then re-evaluate (8/1/2021)

III. Public Involvement and Participation

- a. Contact Wenatchee Valley Stormwater Program Steering Committee meeting (Newsletter or Meeting) Post Stormwater Management Program and Plan to regional website.
- b. Provide a stormwater survey on the website and at public events.
- c. Measure understanding and adoption of behavior for one target audience (8/21/2021)

IV. Illicit Discharge Detection and Elimination

- a. Continue to review and update stormwater system map as needed
- b. Field assess an average of 12% of the stormwater system each year, track the total percentage of the MS4 assessed starting August 1, 2019.
- c. Map required in electronic format with fully described mapping standards (8/1/2021)

V. Construction Site Stormwater Runoff Control

- a. Review local regulations and prepare to update regulations to meet permit requirements if necessary (12/31/2021)
- b. Update regulatory mechanism to meet requirements, if needed (12/31/2021)
- c. CESCL Certification & Recertification Class (Online format) for Municipal Staff

VI. Post-Construction Stormwater Management for new Development and Redevelopment

- a. Continue inspections of structural best management practices during installation and upon completion
- b. Continue implementation of 5-year operation and maintenance inspections of post structural best management practices
- c. Update regulatory mechanism to meet requirements, if needed (12/31/2021)

VII. Municipal Operations and Maintenance

- a. Review and update municipal operations and maintenance plans as needed to meet new requirements by December 31, 2021
- b. Provide staff training

VIII. Monitoring and Assessment

- a. Prepare a description of an effectiveness study including participants and participant roles to submit to Ecology
- b. Prepare Detailed Study Design Proposal, due to Ecology 6/30/2022

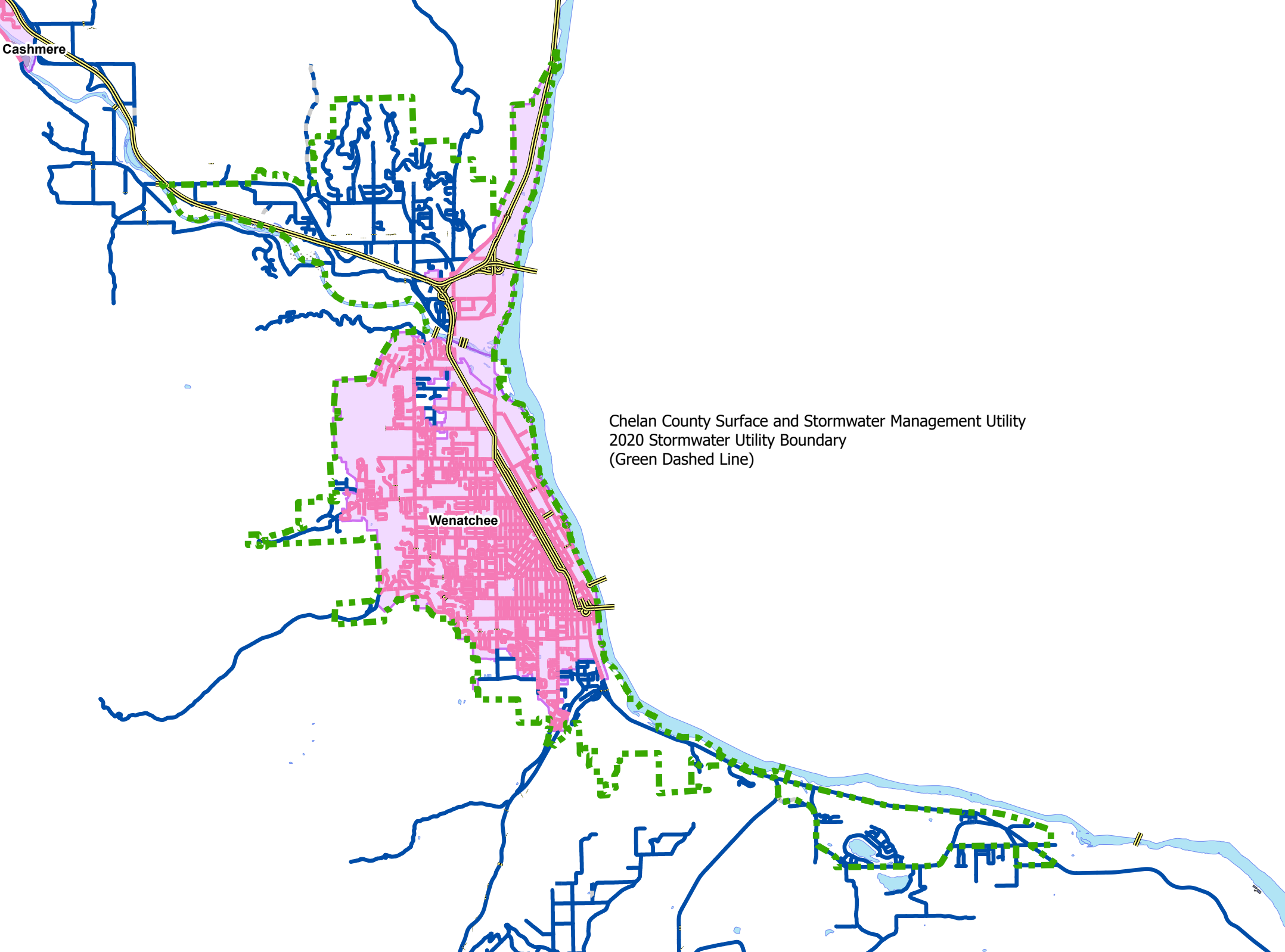

Cashmere

Chelan County Surface and Stormwater Management Utility
2020 Stormwater Utility Boundary
(Green Dashed Line)

Wenatchee

Skip Moore, Auditor, Chelan County, WA. AFN # 2509431
Recorded 01/14/2020 at 09:19 AM
ORD Pages: 6
Filing Instrument \$108.50
CITY OF WENATCHEE

Return Address:

Tammy Stanger, City Clerk
City of Wenatchee
PO Box 519
Wenatchee, WA 98807

Document Title(s) (or transactions contained therein):

1. Ordinance No. 2020-02
- 2.
- 3.
- 4.

Reference Number(s) of Documents assigned or released:

(on page of document(s))

Grantor(s) (last name first, then first name and initial(s))

1. City of Wenatchee

- 2.
- 3.
- 4.

☐ Additional names on page of document.

Grantee(s) (last name first, then first name and initial(s))

1. Public

- 2.
- 3.
- 4.

☐ Additional names on page of document.

Legal Description (abbreviated : i.e. lot, block, plat or section township and range)

Parcels of land located within the northeast quarter of the southeast quarter of Section 15, Township 22 North, Range 20 East of the Willamette Meridian, Chelan County, Washington.

☒ Additional legal is on page 5 of document

Assessor's Property Tax Parcel/Account Number: 222015680140; 222015680130;
222015680125; 222015680120; 222015680115

☐ Additional parcel numbers on page of document

Washington State County Auditor/Recorder's indexing form (cover sheet)

The Auditor/Recorder will rely on the information provided on the form. The staff will not read the document to verify the accuracy or completeness of the indexing information provided herein.

EMERGENCY NONSTANDARD REQUEST – SIGN ONLY WHEN RECORDING AS NONSTANDARD

I am requesting an emergency nonstandard recording for an additional fee of \$50.00 as provided in RCW 36.18.010. I understand that the recording processing requirements may cover up or otherwise obscure some part of the text of the original document.

SIGNATURE

DATE

ORDINANCE NO. 2020-02

AN ORDINANCE, providing for the annexation of an unincorporated area that includes five parcels located on the north side of Terminal Avenue between Methow Street to the west and extending towards Cross Street stopping at approximately midblock also known as the Isola Annexation.

WHEREAS, a petition to annex the real property hereinafter described was filed with the City Council of the City of Wenatchee, signed by owners representing 60% of the assessed valuation in the area for which annexation is petitioned, and

WHEREAS, in accordance with Chapter 1.09 of the Chelan County Code and RCW 36.96.090 the City Council of the City of Wenatchee held a public hearing on July 25, 2019 to adopt Resolution 2019-34 providing the Chelan County Boundary Review Board with notice of intent to annex; and

WHEREAS, the request to the Chelan County Boundary Review Board to provide action by reviewing and approving, disapproving or modifying the proposed annexation within forty-five (45) days in accordance with RCW 36.93.100 received no response and therefore no action from the Chelan County Boundary Review Board; and

WHEREAS, the applicable zoning for the annexed property will be Residential High as designated on the pre-annexation zoning map, and

WHEREAS, the City Council of the City of Wenatchee considered all factors relative to the proposed annexation, and

WHEREAS, a review proceeding for said annexation is not required pursuant to RCW 35A.14.220.

**NOW, THEREFORE, THE CITY COUNCIL OF THE CITY OF
WENATCHEE DO ORDAIN** as follows:

SECTION I

That the following described real property located in Chelan County, Washington, contiguous to the City of Wenatchee, to-wit:

See Exhibit "A" as depicted in Exhibit "B", attached hereto and incorporated herein by reference as if fully set forth;

and each and every part thereof be and the same is hereby annexed to the City of Wenatchee, State of Washington; and that the corporate limits of the City of Wenatchee be and they are hereby extended so as to include the property and territory hereinbefore fully described. That said property be assessed and taxed at the same rate and on the same basis as the property of the City of Wenatchee is assessed and taxed to pay for the now outstanding indebtedness of the City of Wenatchee contracted prior to or existing at the time of this annexation.

SECTION II

That the property described in Section I hereof be and the same is hereby classified and zoned as Residential Moderate. All such zoning and classification being subject to the provisions of Ordinance No. 2007-34, and all subsequent amendments thereto.

SECTION III

This Ordinance shall take effect from and after its passage on the later of sixty (60) days after publication of such Ordinance once in The Wenatchee World, the same being the official newspaper of the City of Wenatchee, and the Clerk is hereby directed to cause the same to be so publicized, or sixty (60) days from the date notice of the annexation is provided to the Chelan County Treasurer, Assessor, and light, power and gas distribution businesses.

PASSED BY THE CITY COUNCIL OF THE CITY OF
WENATCHEE, at a regular meeting thereof, this 9th day of January, 2020.

CITY OF WENATCHEE, a Municipal
Corporation

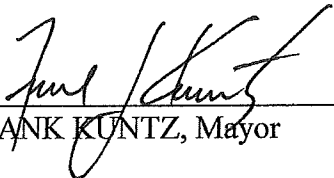
By: 
FRANK KUNTZ, Mayor

ATTEST:

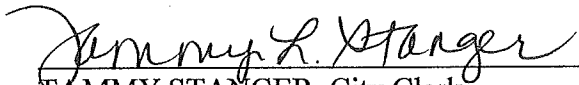
By: 
TAMMY STANGER, City Clerk

APPROVED:

By: 
STEVE D. SMITH, City Attorney

EXHIBIT A

Boundary Description of the ISOLA ANNEXATION

June 20, 2019

Parcels of land located within the northeast quarter of the southeast quarter of Section 15, Township 22 North, Range 20 East of the Willamette Meridian, Chelan County, Washington, said parcels being more particularly described as follows:

The West half of Lot 5, Block 3, Loudenback's Broadview Tracts, according to the plat thereof recorded December 14, 1933, in Volume 4 of Plats, at page 74, records of said County;

TOGETHER WITH Lot 6, Block 3, said Loudenback's Broadview Tracts;

AND TOGETHER WITH Lot 7, Block 3, said Loudenback's Broadview Tracts;

AND TOGETHER WITH the South 50 feet of Lot 8, Block 3, said Loudenback's Broadview Tracts;

EXCEPT any portion thereof previously annexed by the City of Wenatchee.

Prepared By: Erik B. Gahringer, PLS
48° North
Professional Land Surveying & Land Use Consultants
P.O. Box 4266
Wenatchee, WA 98807-4266
Phone: (509) 436-1640

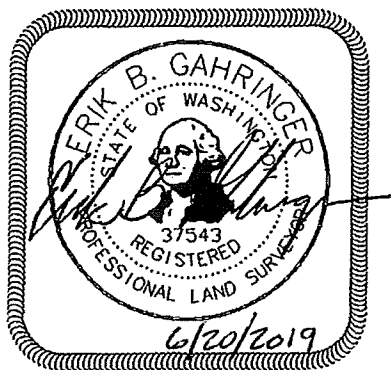
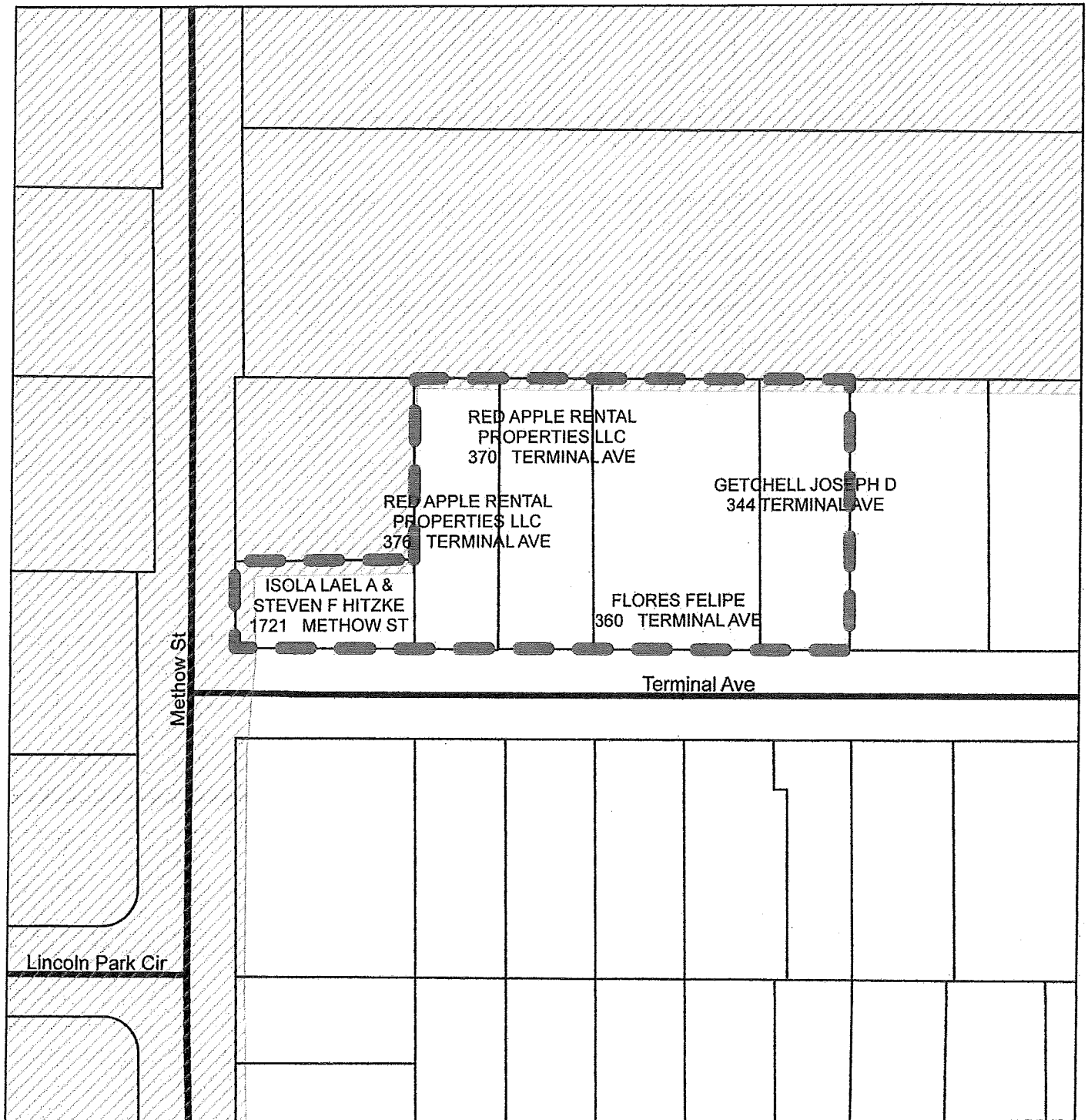

Exhibit B

Map of Proposed Isola Annexation Area



0 50 100 200 Feet

Legend



Isola Annexation Proposed Boundary for 60% Petition



Parcels



City Limits



Streets



Urban Growth Area



Skip Moore, Auditor, Chelan County, WA. AFN # 2509432
Recorded 01/14/2020 at 09:19 AM
ORD Pages: 7
Filing Instrument \$109.50
CITY OF WENATCHEE

Return Address:

Tammy Stanger, City Clerk
City of Wenatchee
PO Box 519
Wenatchee, WA 98807

Document Title(s) (or transactions contained therein):

1. Ordinance No. 2020-03
- 2.
- 3.
- 4.

Reference Number(s) of Documents assigned or released:

(on page of document(s))

Grantor(s) (last name first, then first name and initial(s))

1. City of Wenatchee
- 2.
- 3.
- 4.

☐ Additional names on page of document.

Grantee(s) (last name first, then first name and initial(s))

1. Public
- 2.
- 3.
- 4.

☐ Additional names on page of document.

Legal Description (abbreviated : i.e. lot, block, plat or section township and range)

A parcel of land being that portion of the southwest one-quarter of the southwest one-quarter of Section 9, in Township 22 North, Range 20 East of the Willamette Meridian.

☒ Additional legal is on page 5 & 6 of document

Assessor's Property Tax Parcel/Account Number: 222009705830

☐ Additional parcel numbers on page of document

Washington State County Auditor/Recorder's indexing form (cover sheet)

The Auditor/Recorder will rely on the information provided on the form. The staff will not read the document to verify the accuracy or completeness of the indexing information provided herein.

EMERGENCY NONSTANDARD REQUEST – SIGN ONLY WHEN RECORDING AS NONSTANDARD

I am requesting an emergency nonstandard recording for an additional fee of \$50.00 as provided in RCW 36.18.010. I understand that the recording processing requirements may cover up or otherwise obscure some part of the text of the original document.

SIGNATURE

DATE

ORDINANCE NO. 2020-03

AN ORDINANCE, providing for the annexation of an unincorporated area located to the west of Skyline Drive in Millerdale Block A without street frontage and bordered to the south and west by urban growth area boundary also known as the Tramp Annexation.

WHEREAS, a petition to annex the real property hereinafter described was filed with the City Council of the City of Wenatchee, signed by owners representing 60% of the assessed valuation in the area for which annexation is petitioned, and

WHEREAS, in accordance with Chapter 1.09 of the Chelan County Code and RCW 36.96.090 the City Council of the City of Wenatchee held a public hearing on October 10, 2019 to adopt Resolution 2019-35 providing the Chelan County Boundary Review Board with notice of intent to annex; and

WHEREAS, the request to the Chelan County Boundary Review Board to provide action by reviewing and approving, disapproving or modifying the proposed annexation within forty-five (45) days in accordance with RCW 36.93.100 received no response and therefore no action from the Chelan County Boundary Review Board; and

WHEREAS, the applicable zoning for the annexed property will be Residential High as designated on the pre-annexation zoning map, and

WHEREAS, the City Council of the City of Wenatchee considered all factors relative to the proposed annexation, and

WHEREAS, a review proceeding for said annexation is not required pursuant to RCW 35A.14.220.

**NOW, THEREFORE, THE CITY COUNCIL OF THE CITY OF
WENATCHEE DO ORDAIN** as follows:

SECTION I

That the following described real property located in Chelan County, Washington, contiguous to the City of Wenatchee, to-wit:

See Exhibit "A" as depicted in Exhibit "B", attached hereto and incorporated herein by reference as if fully set forth;

and each and every part thereof be and the same is hereby annexed to the City of Wenatchee, State of Washington; and that the corporate limits of the City of Wenatchee be and they are hereby extended so as to include the property and territory hereinbefore fully described. That said property be assessed and taxed at the same rate and on the same basis as the property of the City of Wenatchee is assessed and taxed to pay for the now outstanding indebtedness of the City of Wenatchee contracted prior to or existing at the time of this annexation.

SECTION II

That the property described in Section I hereof be and the same is hereby classified and zoned as Residential Moderate. All such zoning and classification being subject to the provisions of Ordinance No. 2007-34, and all subsequent amendments thereto.

SECTION III

This Ordinance shall take effect from and after its passage on the later of sixty (60) days after publication of such Ordinance once in The Wenatchee World, the same being the official newspaper of the City of Wenatchee, and the Clerk is hereby directed to cause the same to be so publicized, or sixty (60) days from the date notice of the annexation is provided to the Chelan County Treasurer, Assessor, and light, power and gas distribution businesses.

PASSED BY THE CITY COUNCIL OF THE CITY OF
WENATCHEE, at a regular meeting thereof, this 9th day of January, 2020.

CITY OF WENATCHEE, a Municipal
Corporation

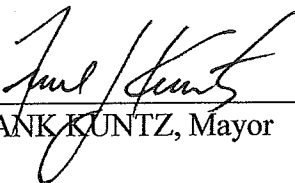
By: 
FRANK KUNTZ, Mayor

ATTEST:

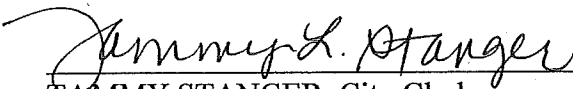
By: 
TAMMY STANGER, City Clerk

APPROVED:

By: 
STEVE D. SMITH, City Attorney

EXHIBIT A

City of Wenatchee, Washington

TRAMP ANNEXATION BOUNDARY DESCRIPTION

June 5, 2019

A parcel of land being that portion of the southwest one-quarter of the southwest one-quarter of Section 9, in Township 22 North, Range 20 East of the Willamette Meridian, Situate the County of Chelan, State of Washington, set forth and described within that certain Judgement recorded January 20th, 2017 under Auditor's File Number 2451629, records of said county, said parcel lying West of said county's road known as Highline Drive, being more particularly described as follows:

Commencing at the southwest corner of said Section 9, being a found 3" brass cap monument in concrete;

Thence North 0°01'24" West along the West line of said Section 9 a distance of 691.91 Feet to a rebar and cap marked LS 13104 as recorded in Book 19 of Surveys, at Page 90, records of said County, said rebar and cap being THE TRUE POINT OF BEGINNING;

Thence continuing along said West line North 0°01'24" West 83.54 Feet more or less to a found rebar and cap marked "Weinert LS 16231", also being the Southwest corner of Lot 4 as depicted in Book 115 of Short Plats, at Page 89;

Thence South 88°06'19" East 98.19 Feet along the South line of said Lot 4 to a rebar and cap;

Thence South 88°06'19" East 216.36 Feet to a rebar and cap;

Thence South 88°06'19" East 209.05 Feet to a rebar and cap;

Thence South 88°06'19" East 181.21 Feet to a rebar and cap;

Thence South 88°06'43" East 325.50 Feet more or less, along the South line of Lot 1 as defined by said Short Plat, to a point on the Westerly Right-of-Way of Skyline Drive, also being 45 Feet from centerline when measured at a right angle;

Thence South 23°17'41" East 73.04 Feet along said West Right-of-Way to a rebar and cap marked "Munson LS 13104" as depicted in said Survey;

Thence North 89°03'53" West 1057.86 Feet more or less to the TRUE POINT OF BEGINNING and end of this description.

The basis of bearing is the West line of the Southwest one-quarter of said Section 9 as recorded in said Survey.

Area contained within afore described parcel being 1.80 Acres more or less.

Except that portion lying East of a line more particularly described as follows;

Commencing at the southwest corner of said Section 9, being a found 3" brass cap monument in concrete;

Thence North $0^{\circ}01'24''$ West along the West line of said Section 9 a distance of 691.91 Feet to a rebar and cap marked "MEI LS 13104" as recorded in Book 19 of Surveys, at Page 90, records of said County;

Thence South $89^{\circ}03'53''$ East 703.38 Feet along the North line of Parcel A as described in Boundary Line Adjustment 2018-020, Auditors File Number 247269, records said County, to the TRUE POINT OF BEGINNING of said line description;

Thence North $00^{\circ}53'58''$ East 72.21 Feet more or less to a rebar and cap, being the westerly corner common to Lots 1 and 2 as described in Orndorf Short Plat Book 725 of Short Plats, at Page 600, Auditors File Number 747094, records of said County, also being the TERMINUS of said line description.

Exhibit B

Map of Proposed Tramp Annexation Area

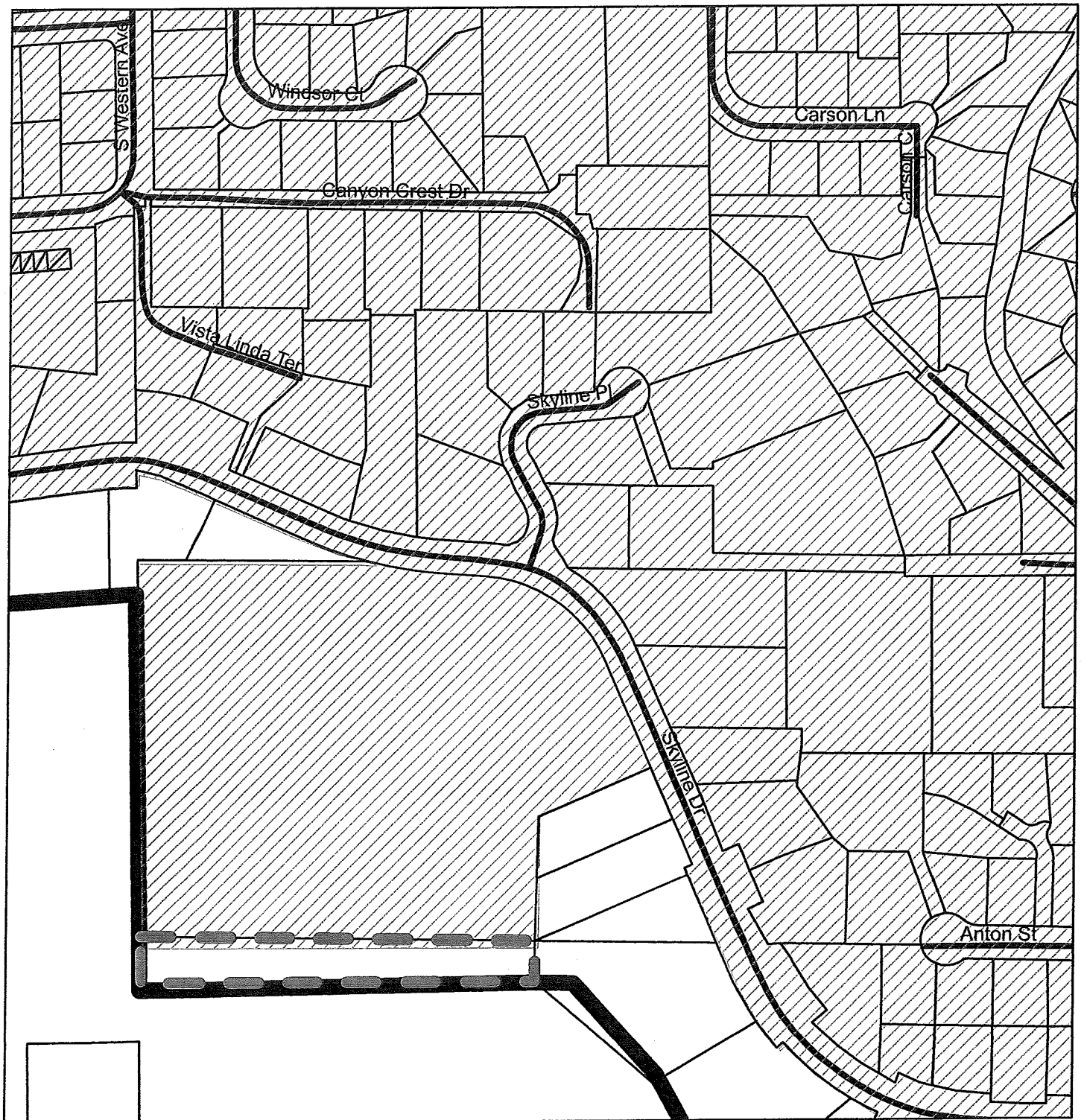

0 500 1,000 Feet

Legend

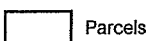

Parcels



City Limits



Streets



Urban Growth Area



Annexation Area





MEMORANDUM

Date: January 25, 2016 (*updated January 21, 2021*)

Re: Stormwater Management Program - Internal Coordination Mechanisms

Description of Coordination among Departments to ensure Municipal Permit Compliance

One mission for Chelan County's Public Works Department is to meet all stormwater related regulatory requirements set forth in the Eastern Washington Phase II Municipal Stormwater Permit (Municipal Permit) administered by the Department of Ecology. In order to do so, coordinating the implementation and documentation of Municipal Permit requirements is necessary. This document has been prepared to generally describe the responsibilities and activities carried out by each affected department and division that contributes to compliance with the Municipal Permit, which is detailed in Section S5.A.6.b:

The Stormwater Management Program (SWMP) shall also include coordination mechanisms among departments within each jurisdiction to eliminate barriers to compliance with the terms of this permit. Permittees shall include a written description of internal coordination mechanisms in the Annual Report due no later than March 31, 2021.

The content in this document is based upon the Municipal Permit requirements and is organized according to the SWMP components required in Section S5.B, S7, S8, and S9:

- Public Education and Outreach (S5.B.1)
- Public Involvement and Participation (S5.B.2)
- Illicit Discharge Detection and Elimination (S5.B.3)
- Construction Site Stormwater Runoff Control (S5.B.4)
- Post-Construction Stormwater Management for New Development and Redevelopment (S5.B.5)
- Municipal Operations and Maintenance (S5.B.6)
- Compliance with Total Maximum Daily Load (S7)
- Monitoring and Assessment (S8)
- Reporting and Recordkeeping (S9)

The Public Works Department is responsible for informing staff of permit requirements, providing training when necessary, and ensuring mechanisms for coordination are in place. Most County departments have some responsibility under this permit and interdepartmental coordination and ongoing communication is the key to successful permit compliance. County staff communicates regularly in person, by phone, and via email regarding the stormwater program. The following is a list of departments in the County that oversee numerous programs that are most affected by the Municipal Permit:

Public Works Department

- Surface and Stormwater Management Utility
- Street maintenance
- Administration

- Engineering
- Construction inspection
- Geographic information services
- Survey
- Solid Waste
- Traffic enforcement (right-of-way violations)

Community Development Department

- Building Official
- Building inspectors

Sherriff's Department

- Code Enforcement
- Emergency Management

Administration

- Board of County Commissioners
- Campus Facilities Maintenance
- Parks and Open Space (Ohme Gardens & Wenatchee River County Park)

Below is a table that summarizes where the county's current Municipal Permit requirements overlap with other county departments.

Table 1 – SWMP Coordination Summary		
Permit Section	Title	Contributing and Coordinating Departments
S5.B.1	Public Education and Outreach	Public Works Department Flood Control Zone District Community Development Department Natural Resource Department
S5.B.2	Public Involvement and Participation	Public Works Department Information Technology Administration (County Commissioners)
S5.B.3	Illicit Discharge Detection and Elimination	Public Works Department Flood Control Zone District Community Development Department Natural Resource Department Sheriff's Office/Emergency Management Administration (Facilities Maintenance) Prosecuting Attorney
S5.B.4	Construction Site Stormwater Runoff Control	Public Works Department Flood Control Zone District Community Development Department Natural Resource Department Sheriff's Office Prosecuting Attorney

S5.B.5	Post-Construction Stormwater Management for New Development and Redevelopment	Public Works Department Flood Control Zone District Community Development Department Natural Resource Department Sheriff's Office Prosecuting Attorney
S5.B.6	Municipal Operations and Maintenance	Public Works Department Flood Control Zone District Administration (Facilities Maintenance, Parks and Open Space)
S7	Compliance with Total Maximum Daily Load	Public Works Department Natural Resource Department
S8	Monitoring and Assessment	Public Works Department
S9	Reporting and Recordkeeping	Public Works Department

Applicability

These components cover a wide variety of stormwater topics and require coordination and communication amongst Chelan County departments to remain informed and compliant the Municipal Permit conditions. The follow section describe how various departments coordinate to meet the intent of the Municipal Permit.

Public Education and Outreach (S5.B.1)

The Municipal Permit requires implantation of an education and outreach program that is designed to reduce behaviors and practices that contribute to or cause stormwater pollution. County employees, contractors, engineers, businesses, property managers, homeowners, school aged children, and the general public are all target audiences. Topics of public education include, but are not limited to: general impacts of stormwater on surface waters, impacts of illicit discharges and how to report them, maintenance of treatment and flow control stormwater facilities, best management practices (BMPs), natural yard care, mobile businesses, portable toilet placement, and vehicle maintenance.

The Environmental Manager within the Public Works Department with assistance from the Wenatchee Valley Stormwater Technical Advisory Committee (WVSTAC) strategizes, develops, and prepares public education materials. The Public Works Department manages the County's stormwater hotline and responds to reported stormwater incidents.

Public Involvement and Participation (S5.B.2)

The Environmental Manager ensures the public has the opportunity to participate in the decision-making process involving the development and implementation of the Municipal Permit's related activities and programs. This is accomplished by making the SWMP document and the most recent Annual Report available to the public on the WVSTAC website, annual steering committee meeting, and providing for program input by County Commissioner's.

Illicit Discharge Detection and Elimination (S5.B.3)

Chelan County implements an Illicit Discharge Detection & Elimination (IDDE) program designed to prevent, detect, characterize, and eliminate illicit connections and illicit discharges into the county's stormwater system (MS4) (Chelan County Code chapter 13.14). Required components of the program include mapping the MS4, development of a regulatory and enforcement mechanism, and an ongoing process to identify and

eliminate sources of stormwater pollution. The County's ordinance, which prohibits non-stormwater discharges, spills, illicit connections, and illegal dumping into the stormwater system is enforced by either by the Public Works Department (Environmental Manager), Code Enforcement Officer, Sheriff's Department, or the Prosecuting Attorney.

The Environmental Manager updates county code, oversees enforcement actions, reports to Ecology on spills and illicit discharges, coordinates staff training and establishes priority areas. Other Public Works staff assist in field surveys, complaint investigation, initial enforcement action, updating the stormwater system map, monitoring the stormwater hotline and inspecting outfalls and water quality facilities. Under the direction of the County Engineer, GIS staff are responsible for adding new subdivisions and stormwater projects to the stormwater system map, managing the geodatabase and providing technical support to staff. Under the direction of the Road Supervisor, the Street Maintenance Department responds to spills and provides information to the Environmental Manager. Staff in all divisions of Public Works are responsible for identifying and reporting illicit discharges. In addition, the Sheriff's Office/Emergency Management, the Code Enforcement Officer, and Building Official/Inspectors forward information regarding illicit discharges to the Public Works Department. The public can call the Stormwater Hotline at 509-667-6415 to report and stormwater-related problems and/or concerns.

IDDE training is mostly completed through online or in-person opportunities and organized by the Public Works Department. Public Works is also responsible for recordkeeping of all reported illicit discharges.

Inventory of the county's stormwater infrastructure is conducted by staff within the Public Works Department using survey and GIS data collection technology.

Construction Site Stormwater Runoff Control (S5.B.4)

Any new construction project that meets the applicability criteria within Chelan County Code chapter 13.16, such as a single-family home, business, apartment building, parking lot, etc., is required to submit drainage plans and reports for review and approval. The Environmental Manager under the direction of the County Engineer is responsible for reviewing all stormwater site plans for development activities and ensuring that projects meet standards in the most current Department of Ecology *Stormwater Management Manual for Eastern Washington*. Public Works conduct inspections for construction site stormwater runoff control, investigation of complaints, and enforcement of county stormwater code. Additionally, the Environmental Manager coordinates with the Sheriff's Office, the Code Enforcement Officer, and also the Building Official/Inspectors for enforcement. Both public and private development must comply with these requirements.

The Environmental Manager coordinates training on construction site stormwater runoff control and is responsible for enforcement beyond the initial steps including notices of violations and other administrative actions. Departments including Engineering, Street Maintenance, Campus Facilities Maintenance, Parks and Open Space, and the Natural Resource Department are all individually responsible for implementing stormwater best management practices on construction projects.

Post-Construction Stormwater Management for New Development and Redevelopment (S5.B.5)

Post-Construction Stormwater Management for New Development and Redevelopment is found within Chelan County Code chapter 13.18. The Environmental Manager under the direction of the County Engineer reviews post-construction stormwater site plans and manages operations and maintenance agreements for post-construction stormwater facilities and certification of BMP completion. Public Works field staff conduct construction-phase inspections of structural post-construction best management practices as well as follow-up inspections upon completion of construction. Code enforcement for this program element is the responsibility of the Public Works Department with assistance from the Sheriff's Office, Code Compliance Officer, Building Official/Inspectors, and Prosecuting Attorney.

Municipal Operations and Maintenance (S5.B.6)

All departments associated with Chelan County are responsible for implementation of the Chelan County's Stormwater Pollution Prevention Operations and Maintenance Plan. The Road Maintenance division of the Public Works Department is responsible for the maintenance of the County's drainage infrastructure, which includes catch basins, pipes, open ditches, as well as public retention/detention facilities. Maintenance staff annually inspects County owned stormwater infrastructure, while treatment and flow control facilities and stormwater retention/detention ponds are inspected by the Environmental Manager. Maintenance requirements for facilities are consistent with the adopted standards found in the *Stormwater Management Manual for Eastern Washington*. The Public Works Department oversees the GIS database mapping of the MS4.

Other county departments, such as Facilities Maintenance and Parks and Open Space are provided a copy of the Stormwater Pollution Prevention Plan.

Compliance with Total Maximum Daily Load (S7)

This Municipal Permit component requires the county to follow specific TMDL requirements identified in Appendix 2, including recordkeeping, annually reporting the status of TMDL implementation, and summarizing relevant activities to address the applicable TMDL parameter(s). Under the direction of the County Engineer, the Environmental Manager oversees compliance with this Municipal Permit component. If necessary, the Public Works Department may coordinate with the county's Natural Resource Department for different aspects of adhere to TMDL requirements.

Currently, the county does not have a TMDL in the Municipal Permit boundary.

Monitoring and Assessment (S8)

The Environmental Manager represents Chelan County on regional and local stormwater groups for the purpose of complying with the requirement to complete Stormwater Management Program Effectiveness Studies for the current permit cycle.

During the 2014 – 2019 Municipal Permit cycle, the WVSTAC studied regional carpet cleaning companies to gain a better understanding of their knowledge of the stormwater program. For the 2019 – 2024 Municipal Permit Cycle, the WVSTAC is interested in further investigating homeowners associations as it relates to operation and maintenance of private BMPs.

Reporting and Recordkeeping (S9)

The Annual Report is prepared by Chelan County staff and is due on March 31 of each year. The report consists of questions related to compliance with the requirements and deadlines in the Municipal Permit. Public Works coordinates with the other affected department staff to collect data that is tracked for compliance. Additionally, updates to the SWMP occur at this time.

The Environmental Manager prepares the annual report and oversees recordkeeping activities for the stormwater management program with assistance from Public Works staff, including the survey and GIS division.

2020 Public Education, Outreach Programs and Stewardship Activities Chelan County

The Wenatchee Valley Stormwater Management Program was promoted by jurisdiction staff at the following community events and activities in 2020:

- Wenatchee School District's 21st Century Community Learning Center Program (3rd through 5th grade)
- Virtual Kids in the Creek (9th through 12th grade) – Wenatchee High School
- New Dog Owner Kits (Managing Pet Waste) provided to the local Humane Society and veterinary offices.
- Radio advertisement on KOHO FM Stations for “Smart Irrigation Month” and Fall Leaf Management and Stormwater
- Pool Winterization, Website and Social Media Facebook posts for “Smart Irrigation Month,” Fall Leaf Management, and Winter Ice Melt Application
- Homeless RV waste disposal with non-profit organizations

Information was also provided at the Public Works Department at 316 Washington Street, Suite 402 and online at www.wenatcheewa.gov/wvstac. In 2020 the Wenatchee Valley Stormwater webpage received 320 hits.

The local Phase II permittees again provided a stormwater survey online through the end of the year.

Illicit Discharge Detection and Elimination Reporting Log

[illegible]

#5

How was the incident discovered or reported to you?

Pollution hotline (phone, web, app)

Direct report to your staff

Staff referral

Other agency referral

ERTS referral

Business inspection

Construction inspection

MS4 inspection or screening

Other (explain in question # 12)

#6

Discharge to MS4?

Yes - notified Ecology

Yes - notified DOH and Ecology

Yes - did not notify

Yes - allowable or conditionally allowable

No - none found

No - cleaned up before reached MS4

no - discharge to Underground Injection Control (UIC) well

Unknown

Other (explain in question # 12)

#8

Pollutants Identified

Unconfirmed, unspecified, or not identified

Fuel and/or vehicle related fluids

Food-related oil/grease

Sediment/soil

Solid waste/trash

Sewage/septage/pet waste/human waste

Other wastewater

Paint

Firefighting foam

Soap or cleaning chemicals

Other (explain in question # 12)

#9

Source or Cause

Unconfirmed, unspecified, or not identified

Vehicle-related business

Food-related business

Landscape-related business

Mobile business

Construction activity

Other commercial/industrial activity

Vehicle collision

Other accident/spill

Intentional dumping

Illicit connection

Other (explain in question # 12)

#10

Source Tracing Approaches used

Not applicable

Observation (color/sheen/turbidity/floatables/odor)

Map analysis

Dye, smoke, or pressure testing

Field indicator measurements

Analytical laboratory indicators

Other (explain in question # 12)

#11

Correction/elimination methods used

Clean-up

Education/technical assistance

Add or modify operational source control BMP

Add or modify structural source control BMP

Add or modify treatment BMP

Enforcement

Referred to other agency or department

Other (explain in question # 12)

Summary of Chelan County's Participation in Effectiveness Study

In 2020, the City of Wenatchee, Chelan County, City of East Wenatchee, Douglas County, and City of Pullman completed the Mobile Contractor Education and Outreach Effectiveness Study. The County worked with the other jurisdictions to complete the Final Report and the Fact Sheet, submitted to the Department of Ecology in early 2020. Utilizing the suggestions from the final report, the County and other participating jurisdictions redeveloped the "Dump Smart" program to edit the literature to clarify disposal practices, limit the amount of information displayed on the educational materials, provide the jurisdiction information on the printed materials and change the format for the tip sheet (i.e. using a sticker or magnet instead of a letter sized piece of paper.)

Additionally, in 2020 the City of Wenatchee, Chelan County, Douglas County, City of East Wenatchee, and the City of Pullman decided to work together for the Effectiveness Study required for the current permit. The City of Wenatchee will serve as the Lead Agency for the Effectiveness Study.