

HOW TO MEASURE BUILDING HEIGHT

These height measurements should not be used for calculating building height on the shoreline. Please visit our website to read the updated [Shoreline Master Program](#) for how to accurately calculate building heights when located on the shoreline.

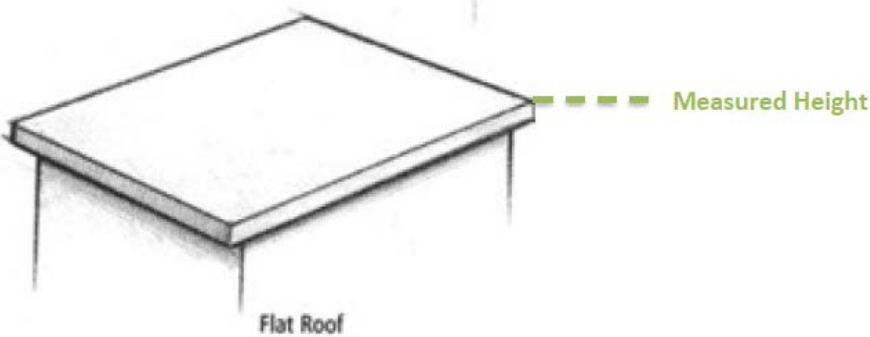

Per Chelan County Code, Section 14.98.325 "Building height" means the vertical distance from the average elevation of the actual or proposed finished grade to the top of the highest roof beams on a flat or shed roof, the deck level on a mansard roof and the average distance between the eaves and the ridge level for gable, hip and gambrel roofs.

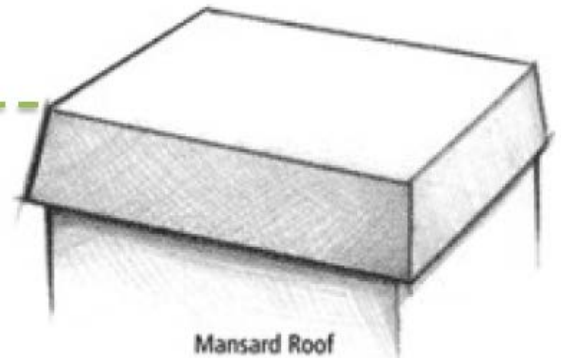
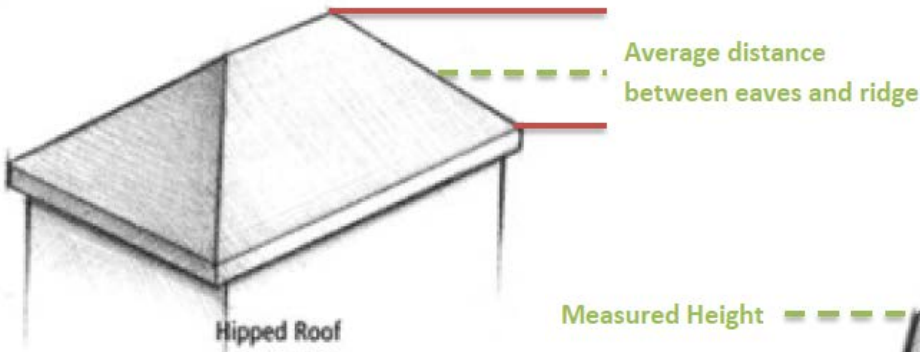
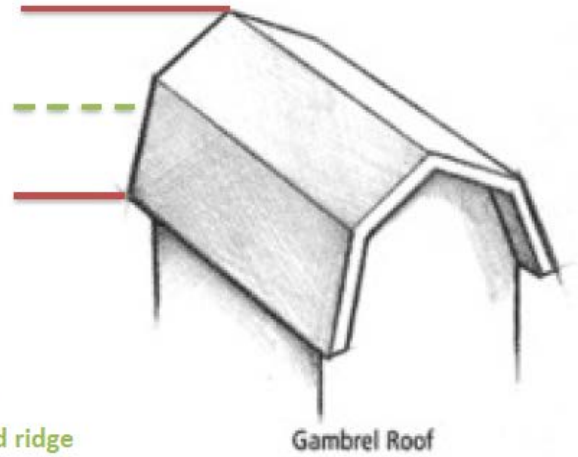
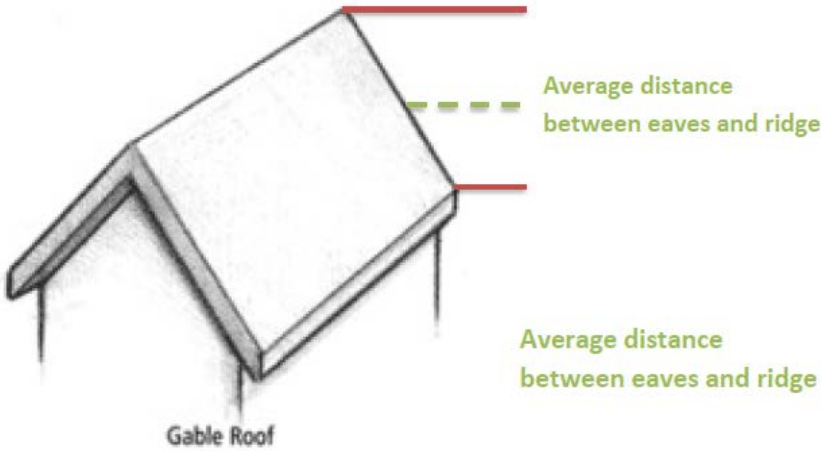